

Kit 1623

NISSAN March (K13), 5-dr Hatchback, 10–
NISSAN Micra (K13), 5-dr Hatchback, 10–

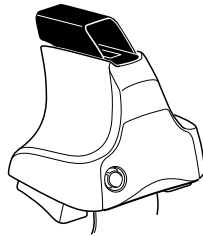

754 Rapid System
480R Rapid Traverse (North America)

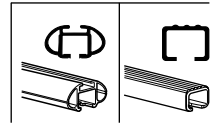

480 Traverse (North America)

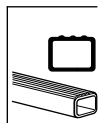

754 Rapid System
 480R Rapid Traverse (North America)

754 Rapid System
 480R Rapid Traverse (North America)

(North America)

1

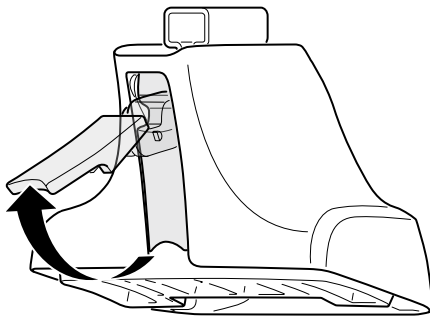

2



754 Rapid System
480R Rapid Traverse
(North America)

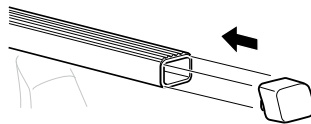
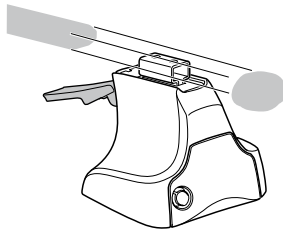

x4

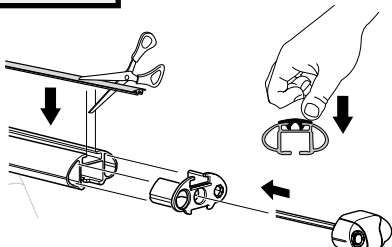
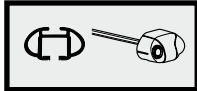

x4

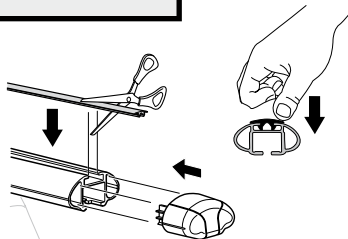
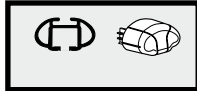

x4

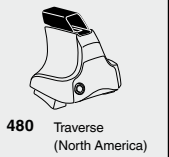

480 Traverse
(North America)

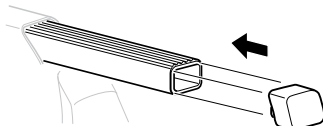
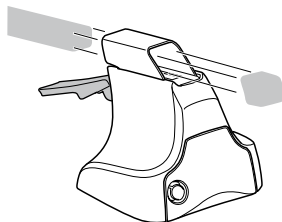

x4

3

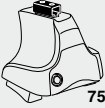

754 Rapid System

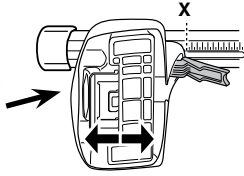

| | X |
|--|-------------|
| NISSAN March (K13), 5-dr Hatchback, 10- | 22,5 |
| NISSAN Micra (K13), 5-dr Hatchback, 10- | 22,5 |

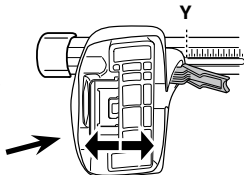

| | Y |
|--|-----------|
| NISSAN March (K13), 5-dr Hatchback, 10- | 19 |
| NISSAN Micra (K13), 5-dr Hatchback, 10- | 19 |

3



480R Rapid Traverse



480 Traverse

(North America)

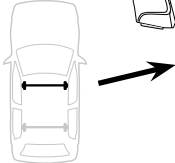

| | X inch | X mm |
|--|----------------|---------------|
| NISSAN March (K13), 5-dr Hatchback, 10- | 34 1/4" | 876 mm |
| NISSAN Micra (K13), 5-dr Hatchback, 10- | 34 1/4" | 876 mm |

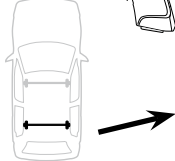

| | Y inch | Y mm |
|--|---------------|---------------|
| NISSAN March (K13), 5-dr Hatchback, 10- | 33" | 839 mm |
| NISSAN Micra (K13), 5-dr Hatchback, 10- | 33" | 839 mm |

4

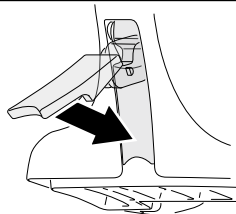

5

NISSAN March (K13), 5-dr Hatchback, 10-
NISSAN Micra (K13), 5-dr Hatchback, 10-

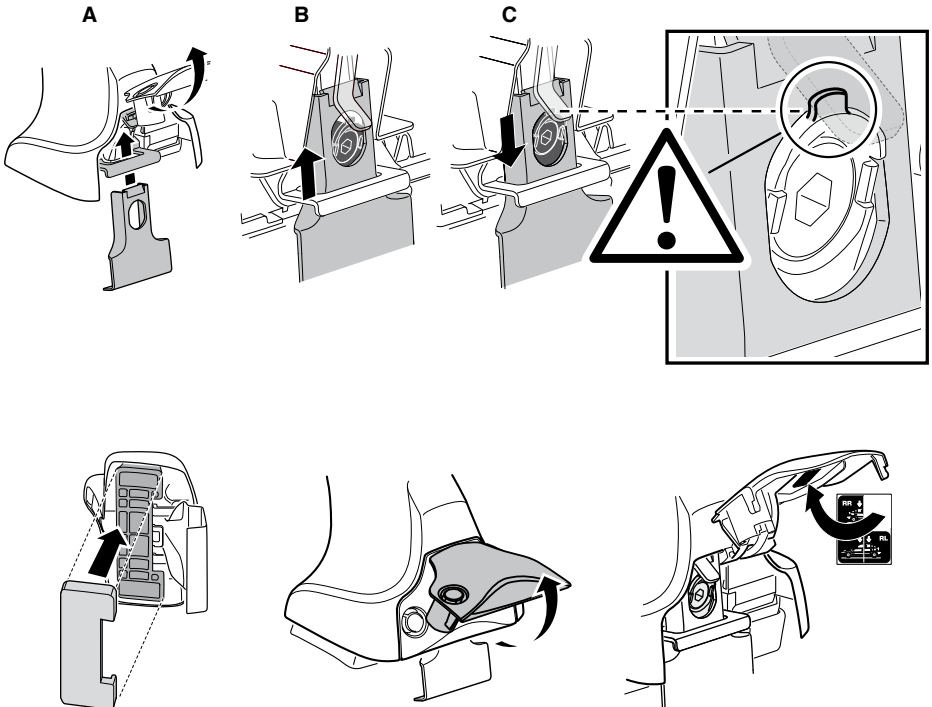
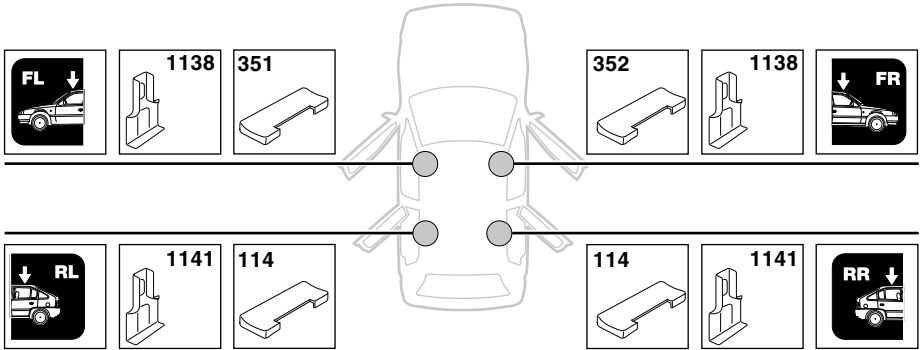

6

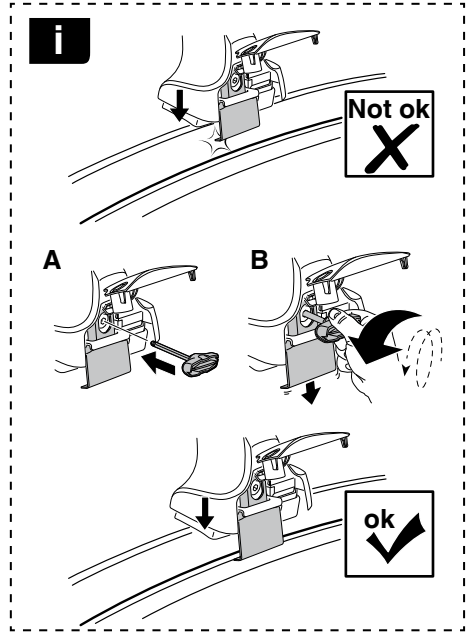
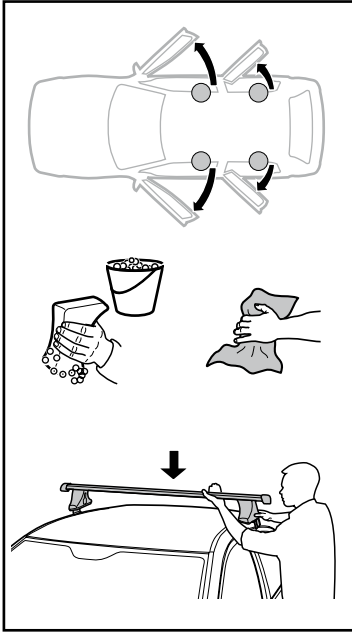

| | X mm | Y mm | X inch | Y inch |
|---|--------|--------|---------|---------|
| NISSAN March (K13), 5-dr Hatchback, 10- | 260 mm | 670 mm | 10 1/4" | 26 3/8" |
| NISSAN Micra (K13), 5-dr Hatchback, 10- | 260 mm | 670 mm | 10 1/4" | 26 3/8" |

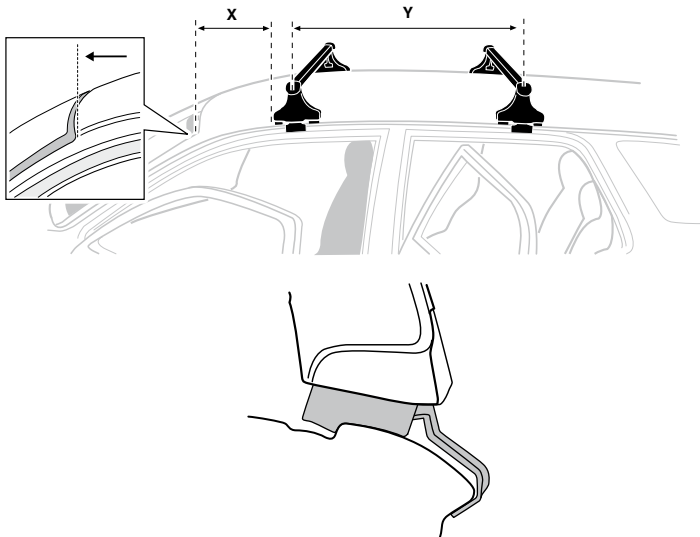

7

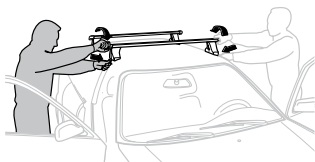

| | |
|--------------|---|
| GB/US | Tighten alternately |
| D | Die Schrauben abwechselnd anziehen |
| F | Serrer alternativement chaque côté |
| NL | Afwisselend aan de linker- en de rechterkant aandraaien |
| I | Alternare il serraggio delle viti |
| E | Apretar alternativamente |
| PT | Aperte alternadamente |
| S | Dra åt växelvis |
| FIN | Kierrä vuorotellen |
| EST | Pinguldage vaheldumisi |
| LAT | Pielveiciet pamišus |
| LIT | Užsukinėkite pakaitomis |
| PL | Śruby dokręcaj naprzemiennie |
| RU | Загряивайте попеременно |

| | |
|------------|--|
| CZ | Pokręřta багаžnika dokręcaj naprzemiennie. |
| SK | Dofahajte striedavo |
| SLO | Privijajte izmenično. |
| HR | Naizmjenično zategnite |
| HU | Egymástól függetlenül szorítandó |
| GR | Σφιγίγες εναλλάξ |
| TR | Dönüşümlü sıkın |

中文 交替拧紧

한국어 번갈아 가며 조이십시오.

日本語 交互に締め付けてください。

ไทย ชันในแบบสลับ

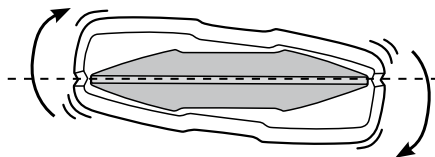
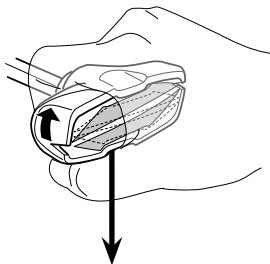
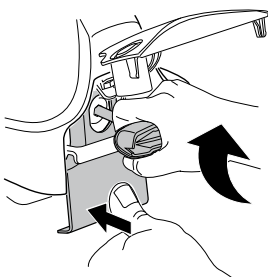
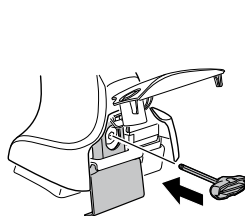

≈ 3 Nm

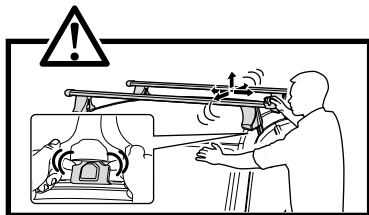
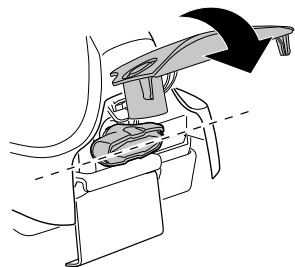

8





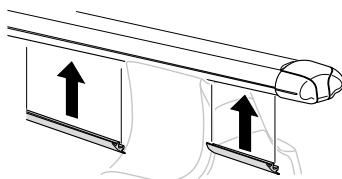

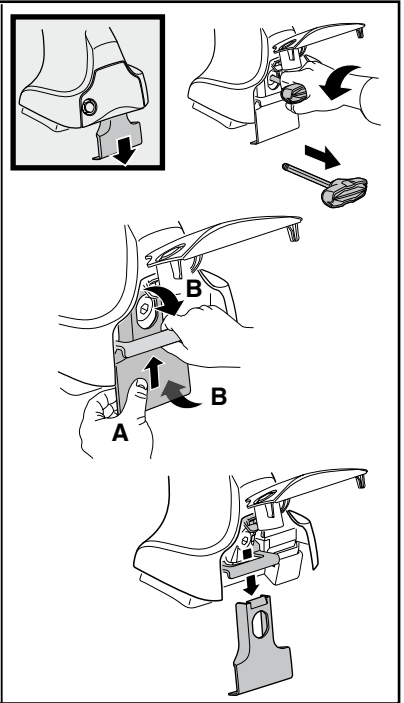
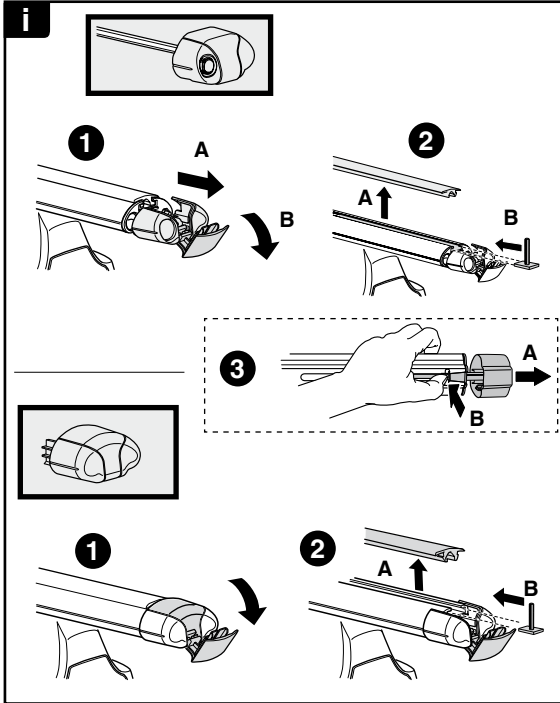
x1
17 mm



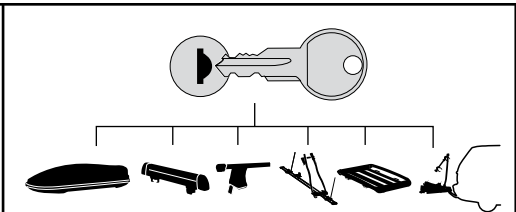

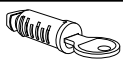
THULE
SWEDEN
**ONE
KEY
SYSTEM**



-  **544** (x4)
 -  **596** (x6)
 -  **588** (x8)
 -  **510** (x10)
 -  **452** (x12)
- NA
EUR
ASIA

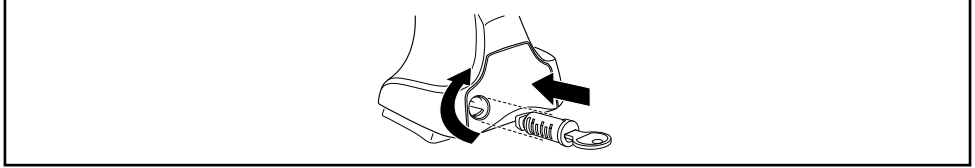

WW ▶ Thule Sweden AB, Box 69, 330 33 Hillerstorp, SWEDEN
NA ▶ Thule Inc., 42 Silvermine Road, Seymour, Connecticut 06483, USA

info@thule.com
customer.service@thule.com

 www.thule.com