

Kit 1606

VOLKSWAGEN Polo (Mk.V), 3-dr Hatchback, 10-

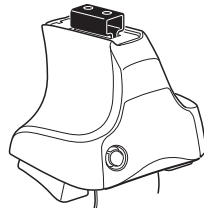

480R Rapid Traverse
754 Rapid System

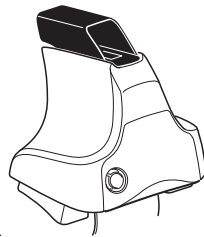
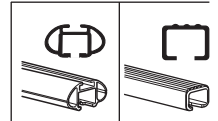

480 Traverse

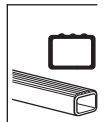

480R Rapid Traverse
754 Rapid System

480 Traverse

x2	x2 23 mm	x1 17 mm	x2 23 mm	x2
x2	x2 23 mm	x2 23 mm	x2	x2
x4	x4	x2	x2	x2
x4	x4	x2	x2	x2

349 x2
 328 x2

1088 x1
 331 x1
 x1

1089 x1
 332 x1

Kit

1



480R Rapid Traverse
754 Rapid System



480 Traverse

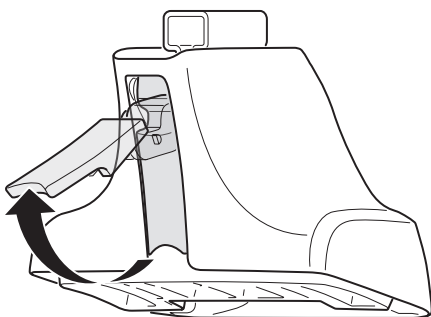

2

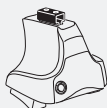

480R Rapid Traverse
754 Rapid System



480 Traverse

+

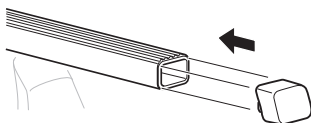
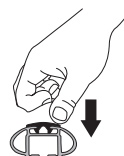
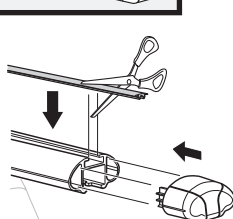
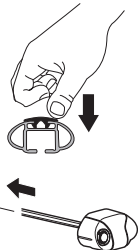
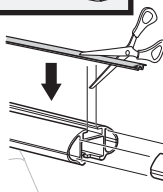
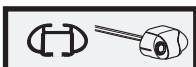
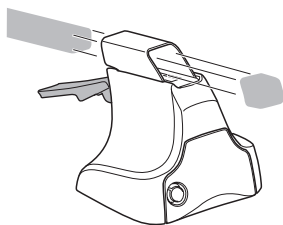
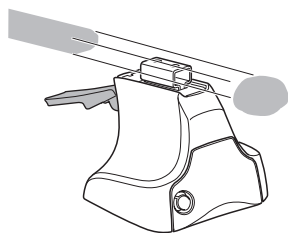

3

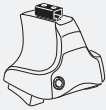

754 Rapid System

1

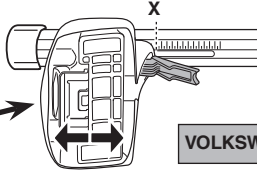
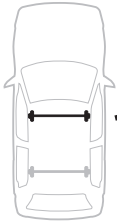

2

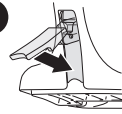

	X
VOLKSWAGEN Polo (Mk.V), 3-dr Hatchback, 10-	37

1

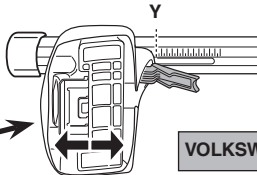
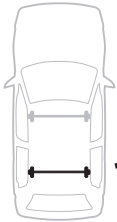

2

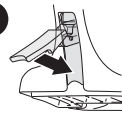

	Y
VOLKSWAGEN Polo (Mk.V), 3-dr Hatchback, 10-	33



480R Rapid Traverse



480 Traverse

1

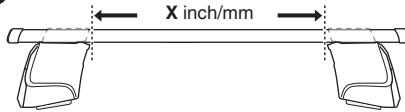

2

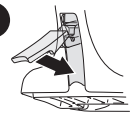

	X inch	X mm
VOLKSWAGEN Polo (Mk.V), 3-dr Hatchback, 10-	40 $\frac{1}{4}$ "	1021 mm

1

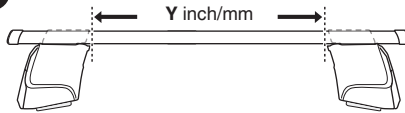

2

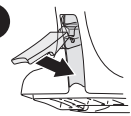

	Y inch	Y mm
VOLKSWAGEN Polo (Mk.V), 3-dr Hatchback, 10-	38 $\frac{5}{8}$ "	981 mm

4

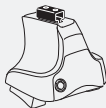

480R Rapid Traverse
754 Rapid System



480 Traverse

VOLKSWAGEN Polo (Mk.V), 3-dr Hatchback, 10-

331



1088



332



1089



328



349



328



349

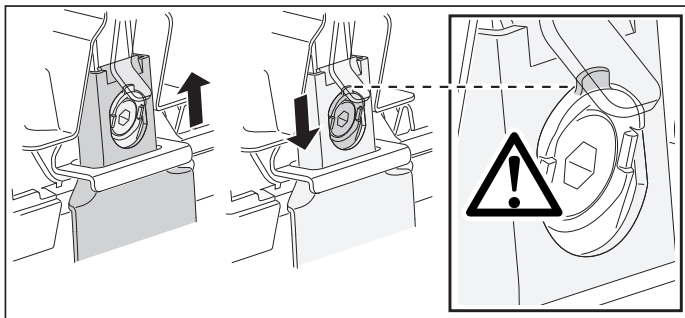
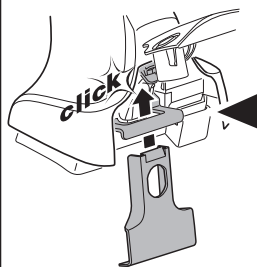
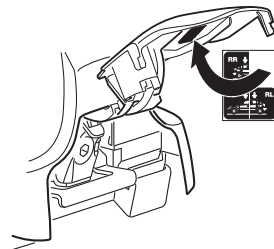
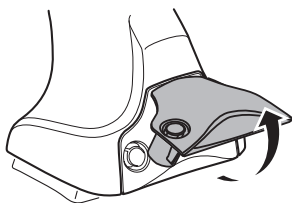
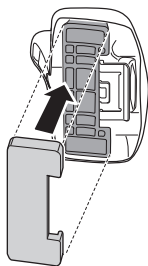

5

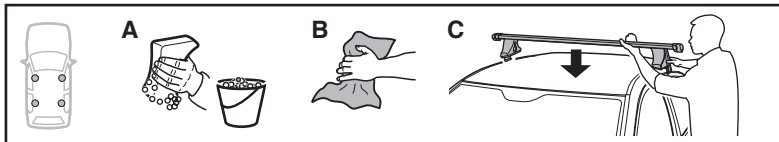

	X mm	Y mm	X inch	Y inch
VOLKSWAGEN Polo (Mk.V), 3-dr Hatchback, 10-	200 mm	730 mm	7 7/8"	26 3/4"

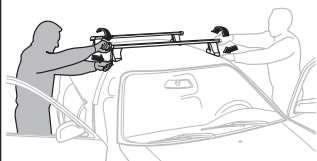
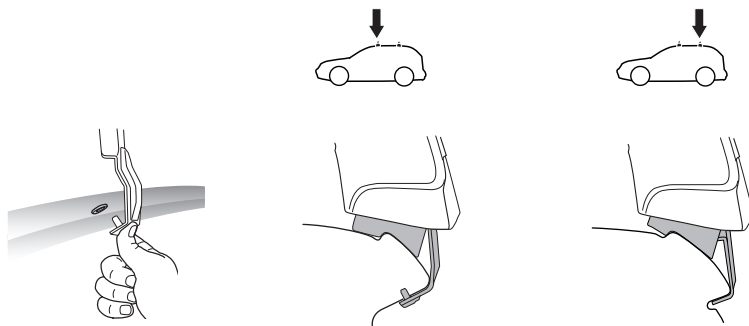
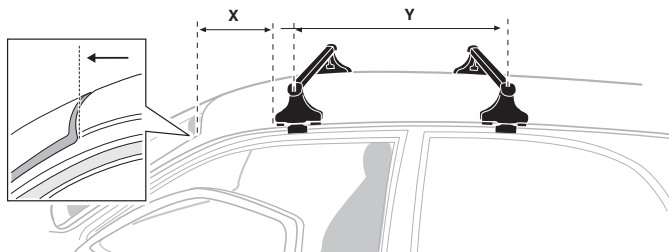

- | | | | |
|--------------|---|------------|---|
| GB/US | Tighten alternately | CZ | Pokreťta bagazníka dokrećaj dokrećaj naprzemiennie. |
| D | Die Schrauben abwechselnd anziehen | SK | Dofahujte striedavo |
| F | Serrer alternativement chaque côté | SLO | Privijajte izmenično. |
| NL | Afwisselend aan de linker- en de rechterkant aandraaien | HR | Naizmjenoćno zategnute |
| I | Alternare il serraggio delle viti | HU | Egymástól függetlenül szorítandó |
| E | Apretar alternativamente | GR | Σφιγγετε εναλλάξ |
| PT | Aperte alternadamente | TR | Dönüşümlü sıkın |
| S | Dra åt växelvis | 中文 | 交替拧紧 |
| FIN | Kierrä vuorotellen | 한국어 | 번갈아 가며 조이십시오. |
| EST | Pinguldage vaheldumisi | 日本語 | 交互に締め付けてください。 |
| LAT | Pievelciot pamīšus | ไทย | ขันในแบบสลับ |
| LIT | Užsukinėkite pakaitomis | | |
| PL | Śruby dokrećaj naprzemiennie | | |
| RU | Затягивайте попеременно | | |

6

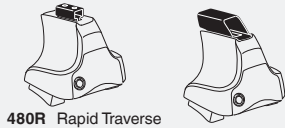

480R Rapid Traverse
754 Rapid System 480 Traverse

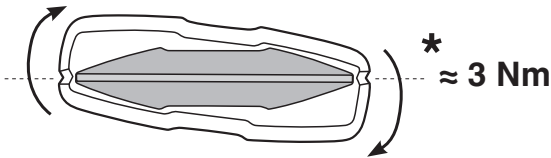
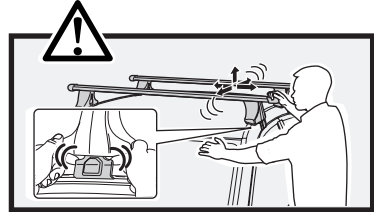
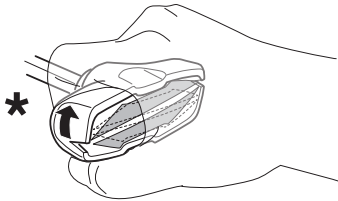
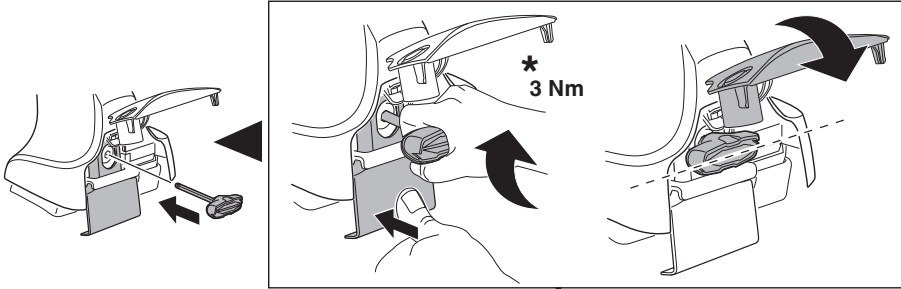

7

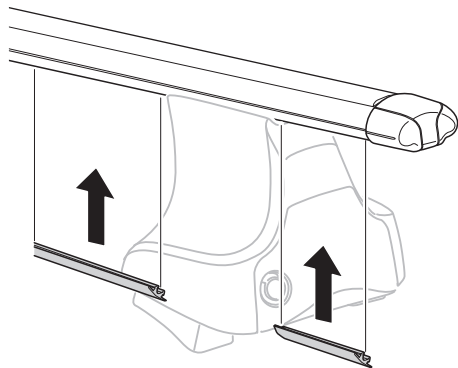
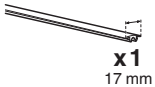

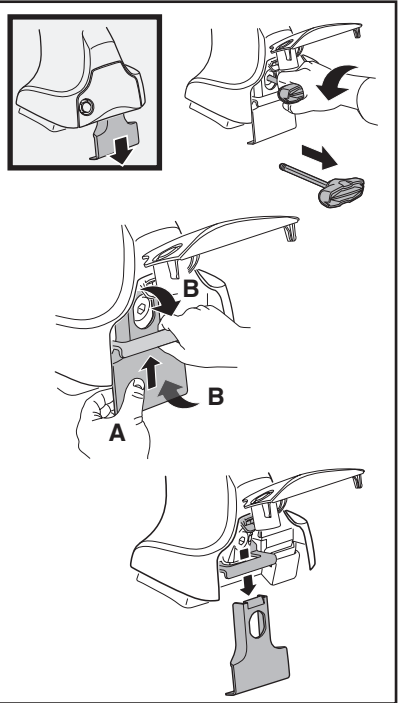
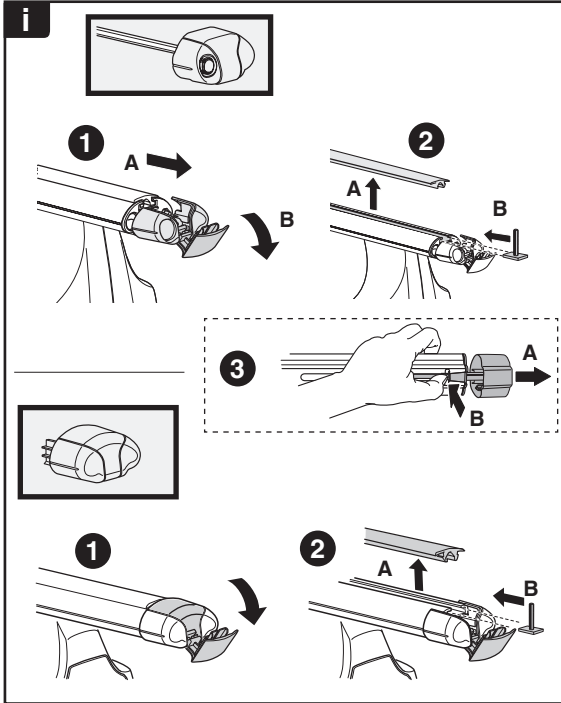
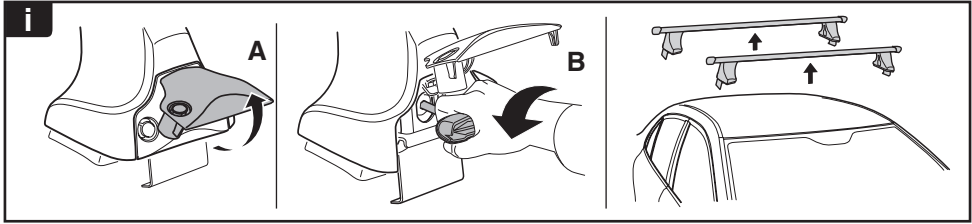

THULE
SWEDEN
**ONE
KEY
SYSTEM**

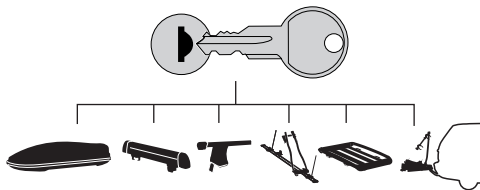

544 (x4)

596 (x6)

588 (x8)

NA **510** (x10)

EUR **452** (x12)

ASIA

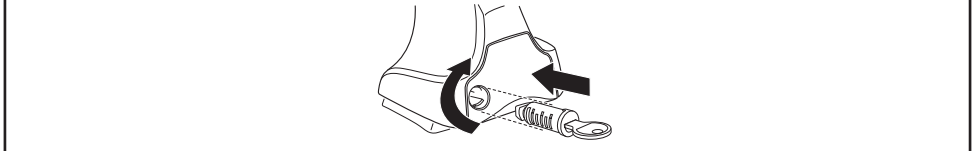

WW ▶ Thule Sweden AB, Box 69, 330 33 Hillerstorp, SWEDEN
NA ▶ Thule Inc., 42 Silvermine Road, Seymour, Connecticut 06483, USA

info@thule.com
customer.service@thule.com

www.thule.com