

Kit 1603

HYUNDAI Santa Fe, 5-dr SUV, 10-

This Kit is only for vehicles without railing.

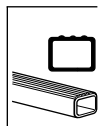
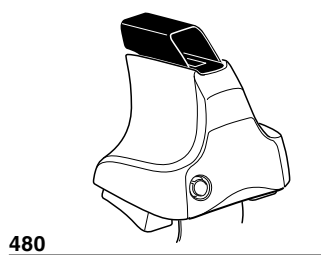
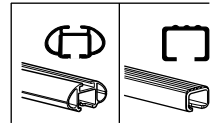
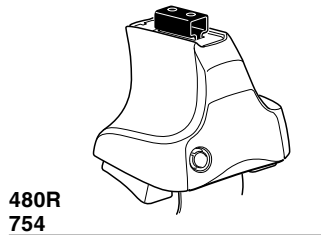

480R/754

480

Kit

1

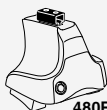

480R/754



480

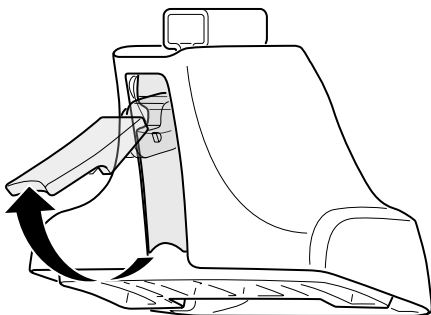

2

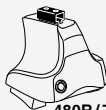

480R/754



480

+

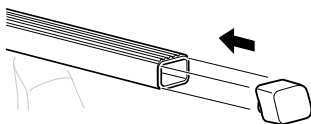
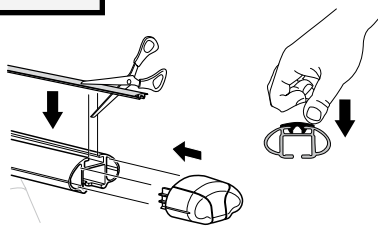
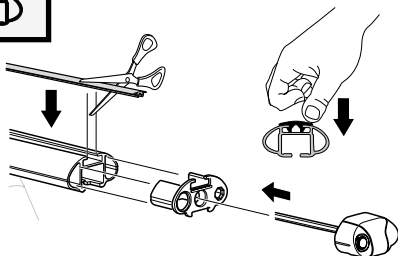
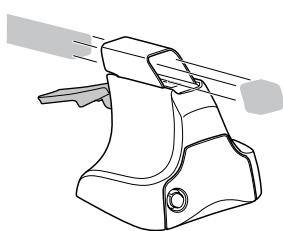
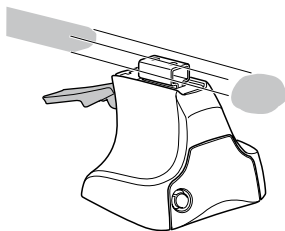

3

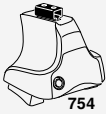

1

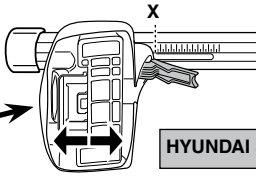
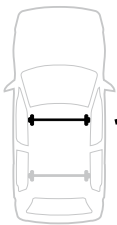

2

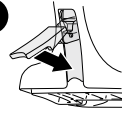

HYUNDAI Santa Fe, 5-dr SUV, 10-

X
45,5

1

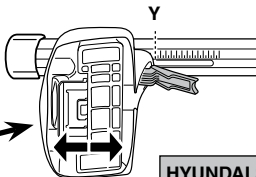
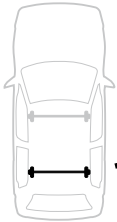

2

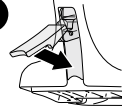

HYUNDAI Santa Fe, 5-dr SUV, 10-

Y
46



1

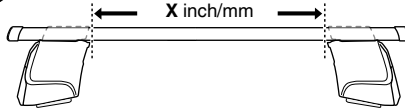
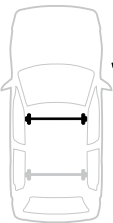

2

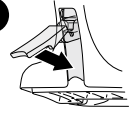

HYUNDAI Santa Fe, 5-dr SUV, 10-

X inch	X mm
43 1/2"	1106 mm

1

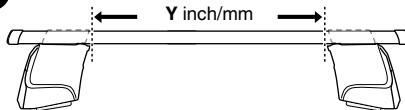

2

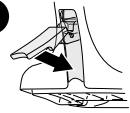

HYUNDAI Santa Fe, 5-dr SUV, 10-

Y inch	Y mm
43 3/4"	1111 mm

4

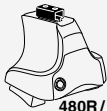

480R/754



480

HYUNDAI Santa Fe, 5-dr SUV, 10-

124



990



124



990



124



990



124



990

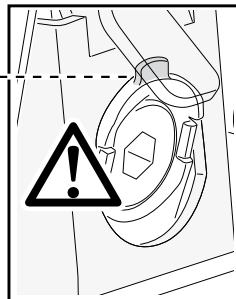
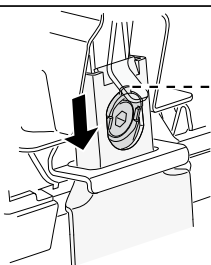
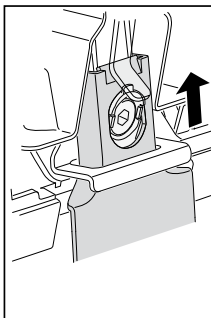
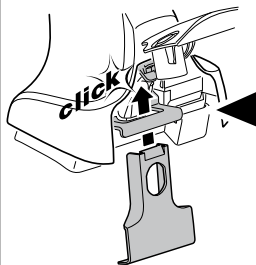
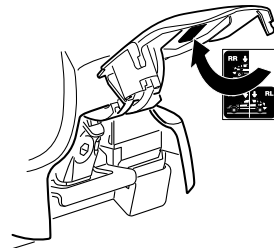
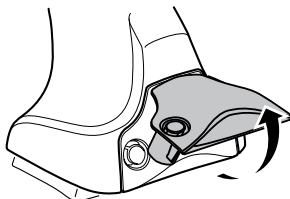
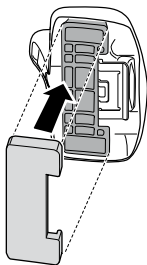

5



	X mm	Y mm	X inch	Y inch
HYUNDAI Santa Fe, 5-dr SUV, 10-	340 mm	700 mm	13 3/8"	27 1/2"

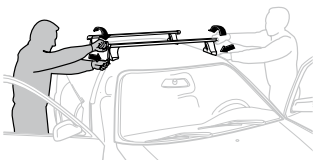
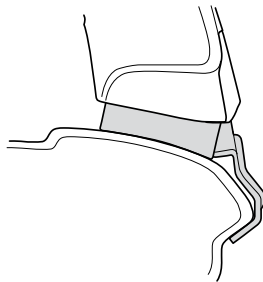
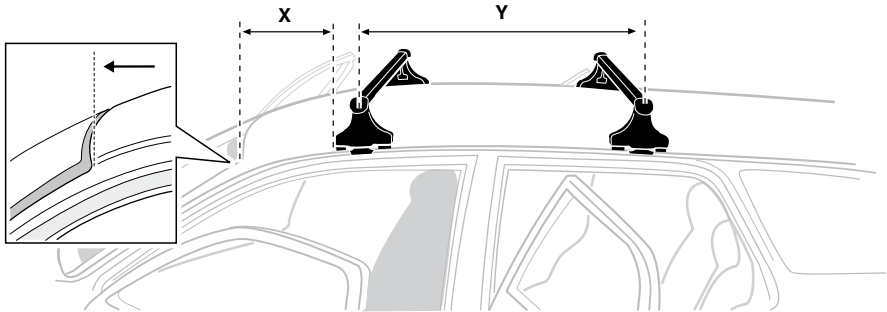

- | | | | |
|--------------|---|------------|---|
| GB/US | Tighten alternately | CZ | Pokreťta bagazníka dokrečaj dokrečaj naprzemiennie. |
| D | Die Schrauben abwechselnd anziehen | SK | Dofahujte striedavo |
| F | Serrer alternativement chaque côté | SLO | Privijajte izmenično. |
| NL | Afwisselend aan de linker- en de rechterkant aandraaien | HR | Naizmjenično zategnite |
| I | Alternare il serraggio delle viti | HU | Egymástól függetlenül szorítandó |
| E | Apretar alternativamente | GR | Σφιγγείτε εναλλάξ |
| PT | Aperte alternadamente | TR | Dönüşümlü sıkın |
| S | Dra åt växelvis | 中文 | 交替拧紧 |
| FIN | Kierrä vuorotellen | 한국어 | 번갈아 가며 조이십시오. |
| EST | Pinguldage vaheldumisi | 日本語 | 交互に締め付けてください。 |
| LAT | Pievēciēt pamāšus | ไทย | ขันในแบบสลับ |
| LIT | Užsukinkite pakaitomis | | |
| PL | Śruby dokrećaj naprzemiennie | | |
| RU | Затягивайте попеременно | | |

6

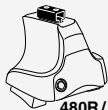

480R/754



480

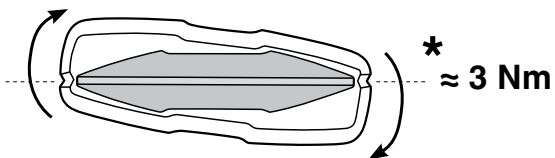
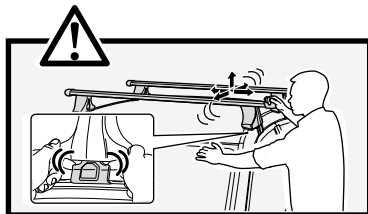
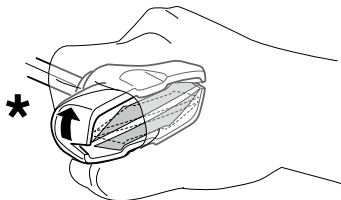
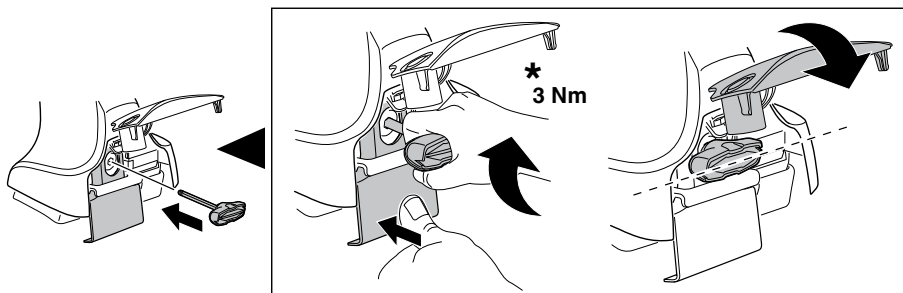

7

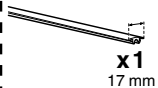

x1
17 mm

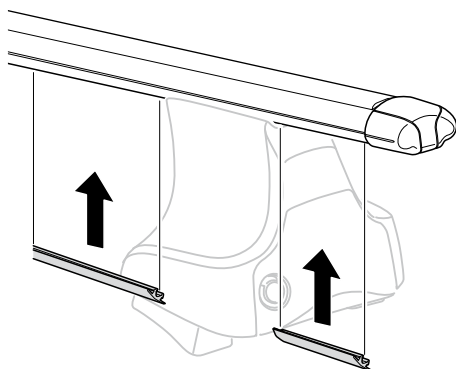

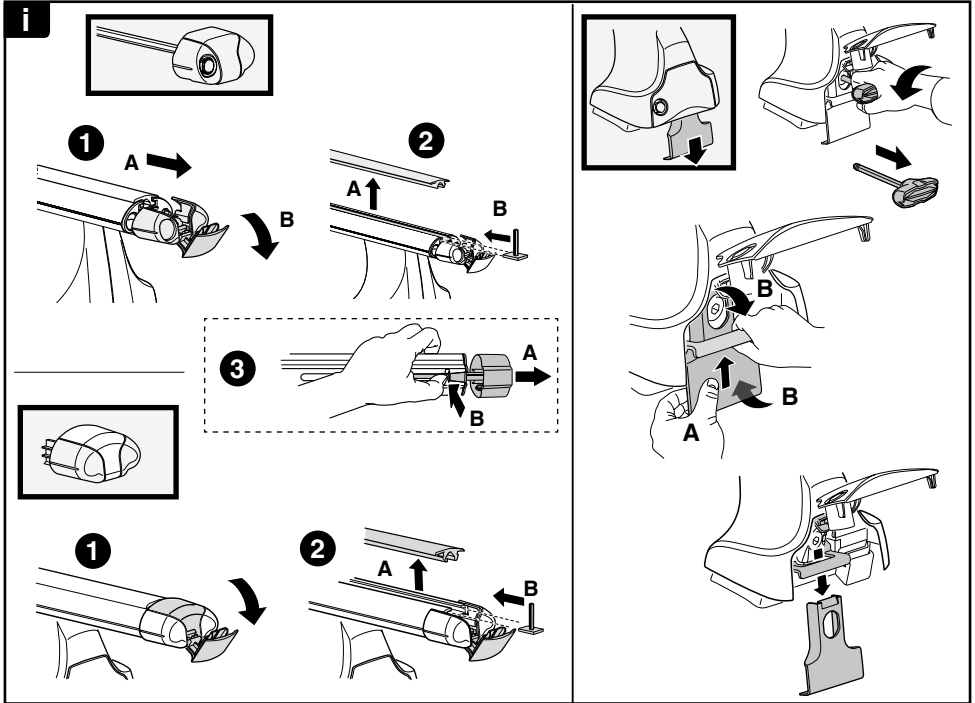

THULE
SWEDEN
**ONE
KEY
SYSTEM**

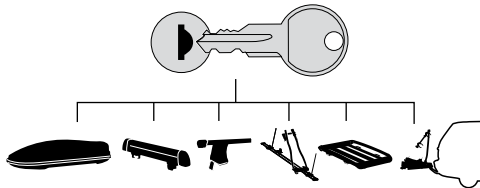

544 (x4)
596 (x6)
588 (x8)
510 (x10)
452 (x12)

NA
EUR
ASIA

