

Kit 1575

SAAB 9-5, 4-dr Sedan, 10-

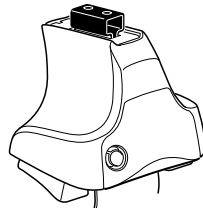

480R Rapid Traverse
754 Rapid System

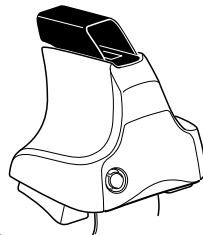
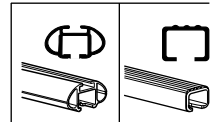

480 Traverse

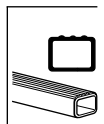

480R Rapid Traverse
 754 Rapid System

480 Traverse

Kit

1

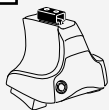

480R Rapid Traverse
754 Rapid System



480 Traverse

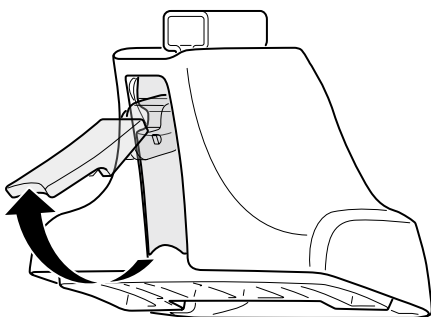

2

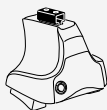

480R Rapid Traverse
754 Rapid System



480 Traverse

+

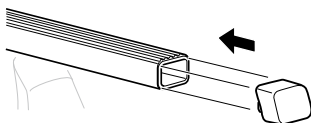
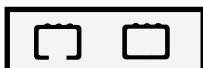
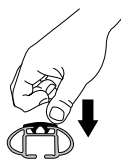
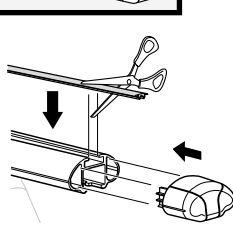
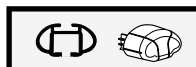
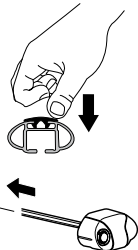
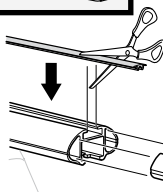
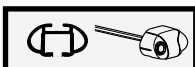
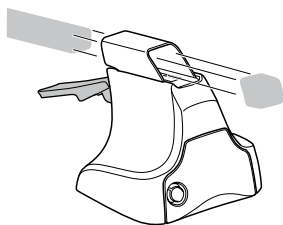
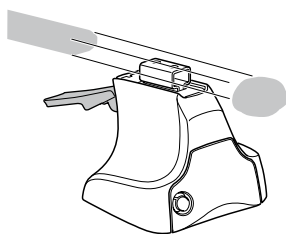

3

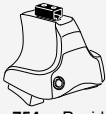

754 Rapid System

1

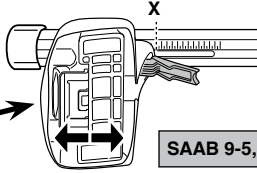
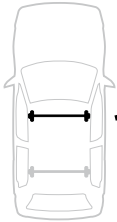

2

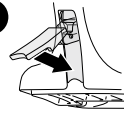

SAAB 9-5, 4-dr Sedan, 10-

X

41,5

1

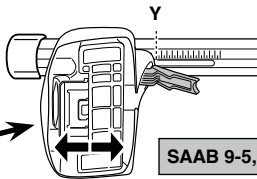
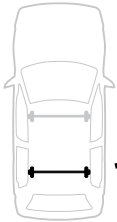

2

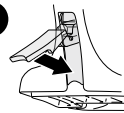

SAAB 9-5, 4-dr Sedan, 10-

Y

40



480R Rapid Traverse



480 Traverse

1

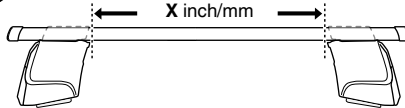

2

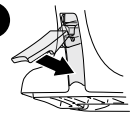

SAAB 9-5, 4-dr Sedan, 10-

X inch

X mm

42"

1066 mm

1

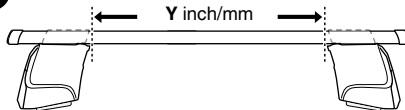

2

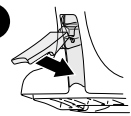

SAAB 9-5, 4-dr Sedan, 10-

Y inch

Y mm

41 3/8"

1051 mm

4

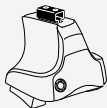

480R Rapid Traverse
754 Rapid System



480 Traverse

SAAB 9-5, 4-dr Sedan, 10-

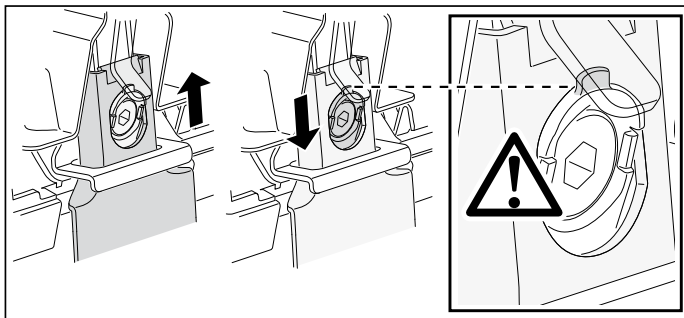
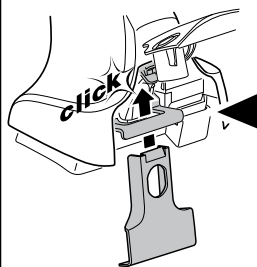
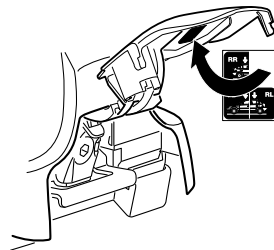
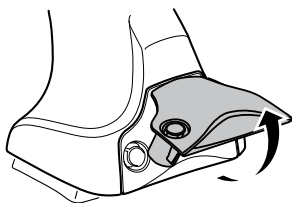
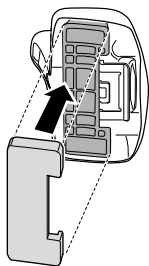
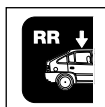
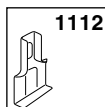
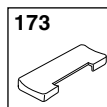
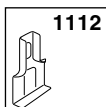
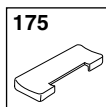
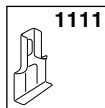
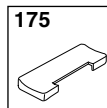
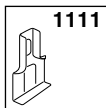
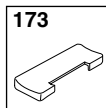

5

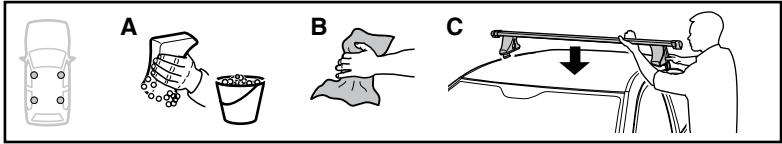

	X mm	Y mm	X inch	Y inch
SAAB 9-5, 4-dr Sedan, 10-	225 mm	770 mm	8 7/8"	30 3/8"

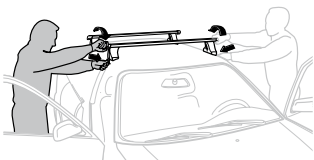
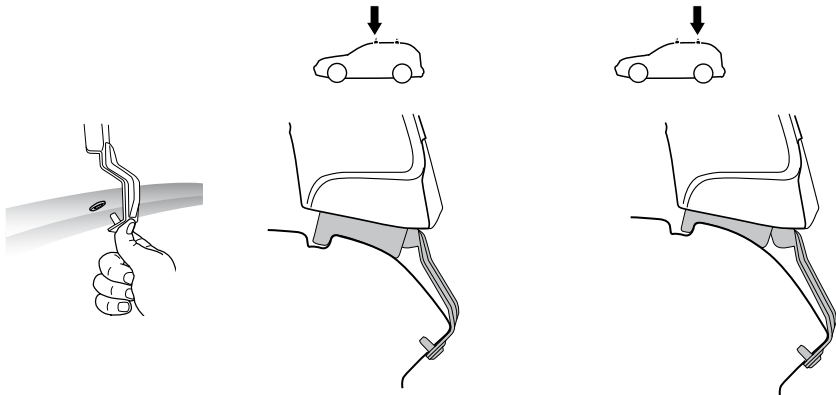
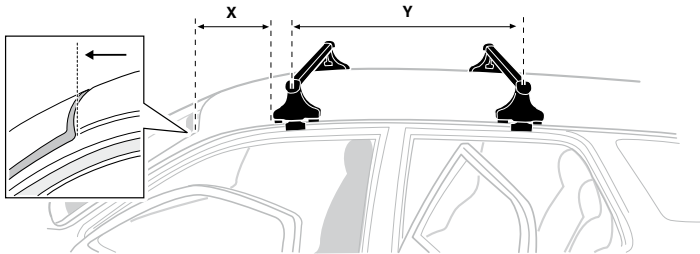

GB/US Tighten alternately

D Die Schrauben abwechselnd anziehen

F Serrer alternativement chaque côté

NL Afwisselend aan de linker- en de rechterkant aandraaien

I Alternare il serraggio delle viti

E Apretar alternativamente

PT Aperte alternadamente

S Dra åt växelvis

FIN Kierrä vuorotellen

EST Pinguldage vaheldumisi

LAT Pieļieciet pamāšus

LIT Užsukinkite pakaitomis

PL Śruby dokręcaj naprzemiennie

RU Затягивайте попеременно

CZ Pokrétla bagażnika dokręcaj dokręcaj naprzemiennie.

SK Dotahujte striedavo

SLO Privijajte izmenično.

HR Naizmjениčno zategnite

HU Egymástól függetlenül szorítandó

GR Σφιγγετε εναλλάξ

TR Dönüşümlü sıkın

中文 交替拧紧

한국어 번갈아 가며 조이십시오.

日本語 交互に締め付けてください。

ไทย ชับในแบบสลับ

ไทย ชับในแบบสลับ

ไทย ชับในแบบสลับ

ไทย ชับในแบบสลับ

ไทย ชับในแบบสลับ

ไทย ชับในแบบสลับ

ไทย ชับในแบบสลับ

ไทย ชับในแบบสลับ

ไทย ชับในแบบสลับ

ไทย ชับในแบบสลับ

ไทย ชับในแบบสลับ

6

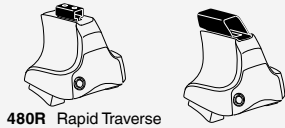

480R Rapid Traverse
754 Rapid System 480 Traverse

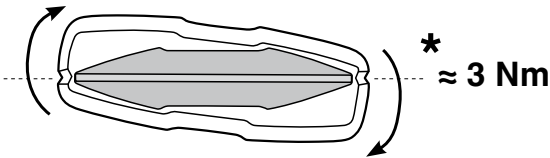
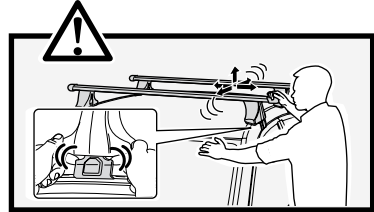
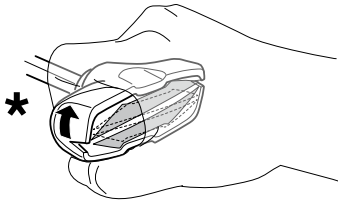
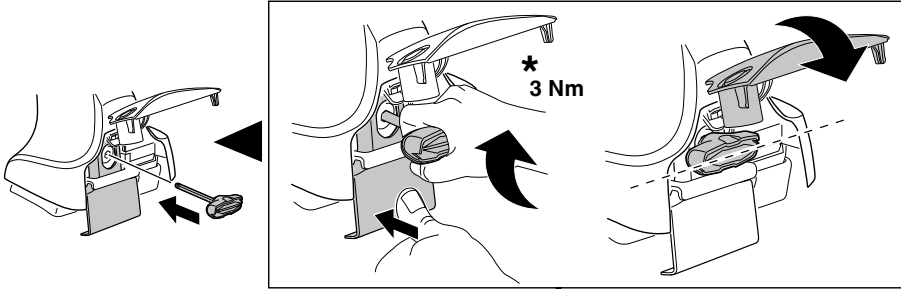

7

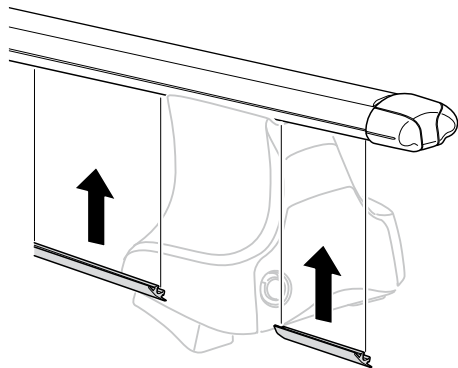
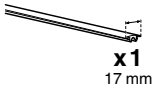

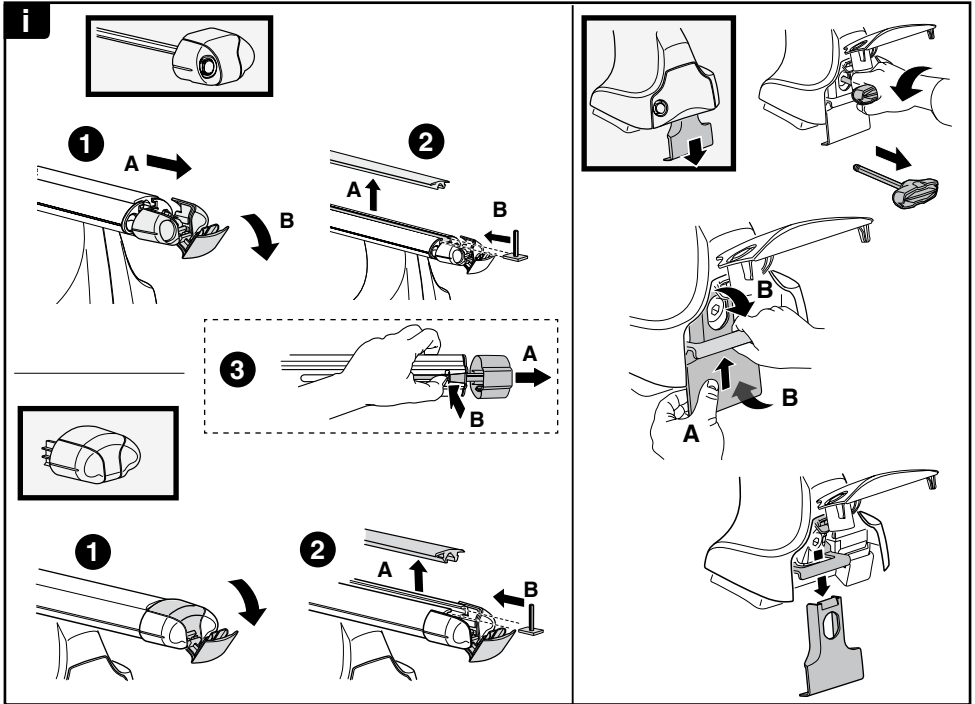
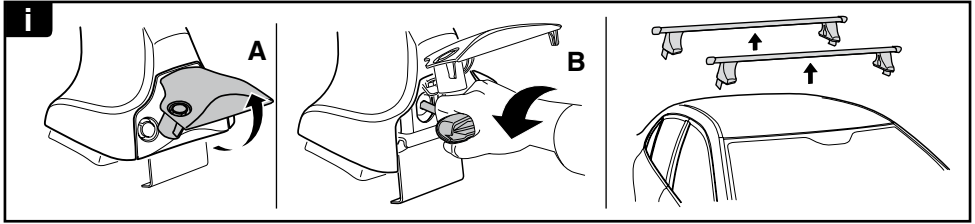

THULE
SWEDEN
**ONE
KEY
SYSTEM**

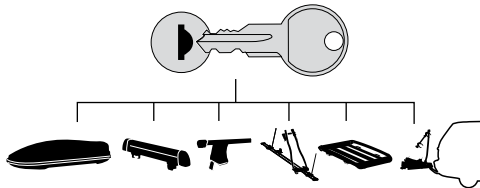

544 (x4)

596 (x6)

588 (x8)

NA **510** (x10)

EUR **452** (x12)
ASIA

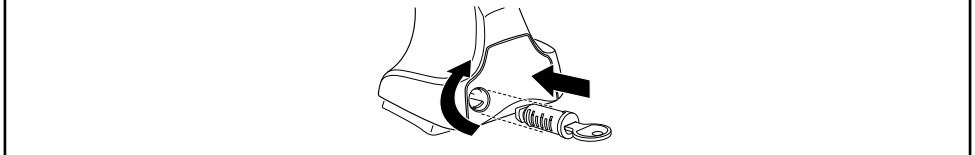

WW ▶ Thule Sweden AB, Box 69, 330 33 Hillerstorp, SWEDEN
NA ▶ Thule Inc., 42 Silvermine Road, Seymour, Connecticut 06483, USA

info@thule.com
customer.service@thule.com

www.thule.com