

Kit 1525

NISSAN Pixo, 5-dr Hatchback, 09–
SUZUKI Alto, 5-dr Hatchback, 09–

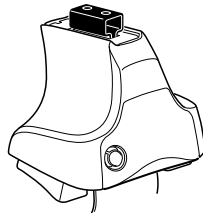

754 Rapid System
480R Rapid Traverse (North America)

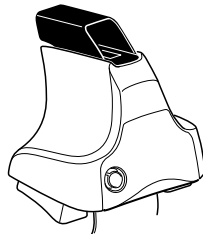
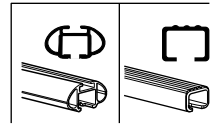

480 Traverse (North America)

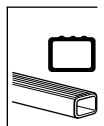

754 Rapid System

480R Rapid Traverse (North America)

480 Traverse (North America)

(North America)

975 x 2

1078 x 2

296 x 1

297 x 1

298 x 1

299 x 1

RR FR

FL RL

x 1

1

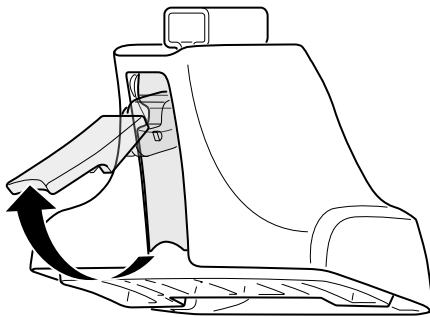

2



754 Rapid System
480R Rapid Traverse
(North America)

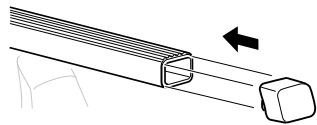
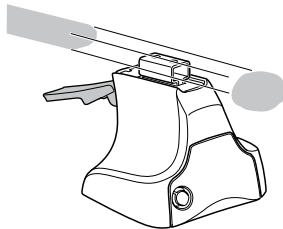

x4

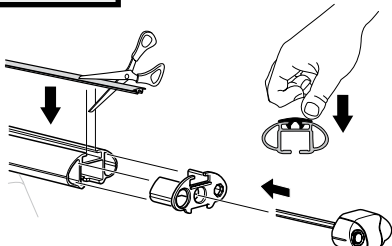
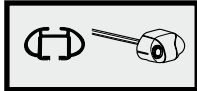

x4

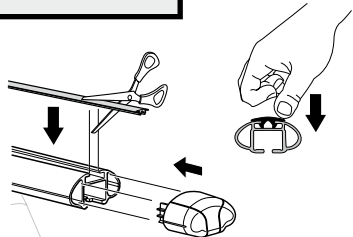
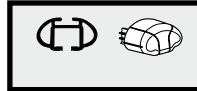

x4

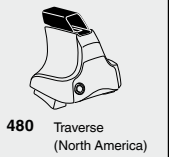

480 Traverse
(North America)

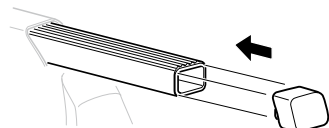
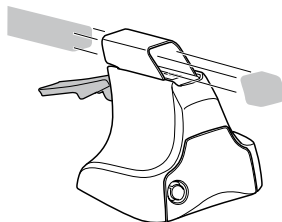

x4

3

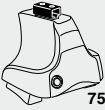

754 Rapid System

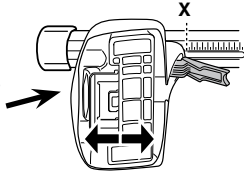

	X
NISSAN Pixo , 5-dr Hatchback, 09–	32
SUZUKI Alto , 5-dr Hatchback, 09–	32

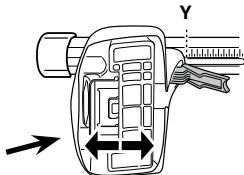

	Y
NISSAN Pixo , 5-dr Hatchback, 09–	28,5
SUZUKI Alto , 5-dr Hatchback, 09–	28,5

3



480R Rapid Traverse



480 Traverse

(North America)

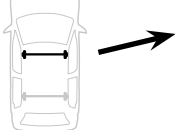

	X inch	X mm
NISSAN Pixo , 5-dr Hatchback, 09–	38 1/4"	971 mm
SUZUKI Alto , 5-dr Hatchback, 09–	38 1/4"	971 mm

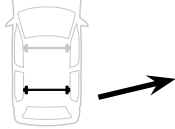

	Y inch	Y mm
NISSAN Pixo , 5-dr Hatchback, 09–	36 7/8"	936 mm
SUZUKI Alto , 5-dr Hatchback, 09–	36 7/8"	936 mm

4

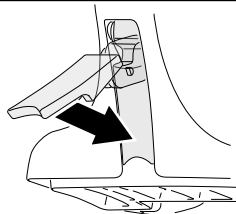

5

NISSAN Pixo, 5-dr Hatchback, 09-
SUZUKI Alto, 5-dr Hatchback, 09-

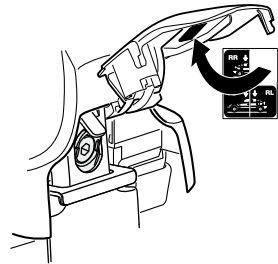
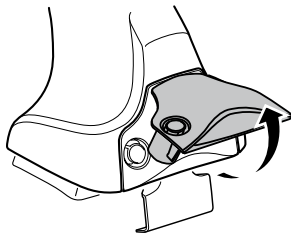
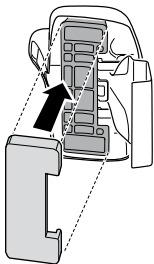
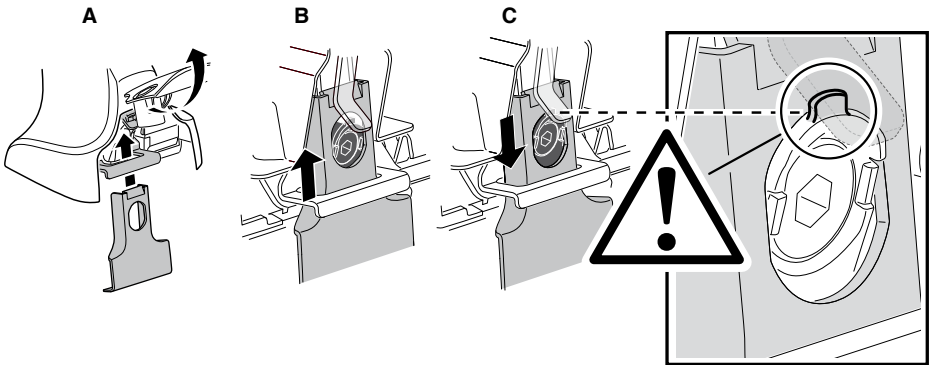
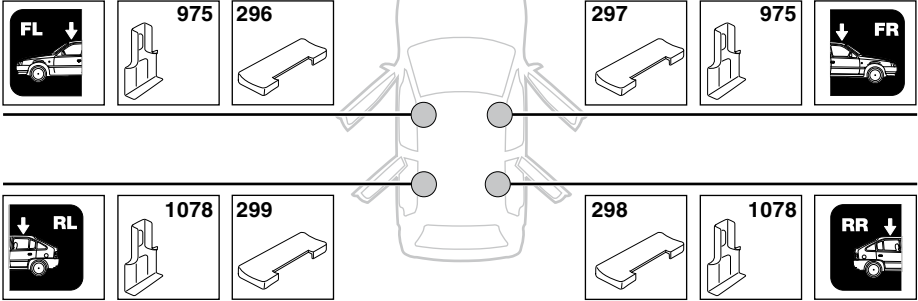

6

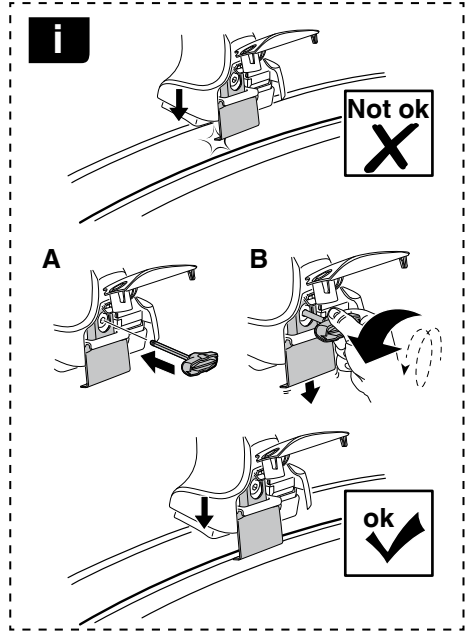
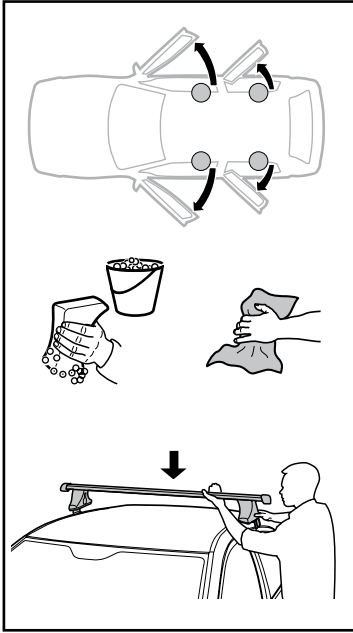

	X mm	Y mm	X inch	Y inch
NISSAN Pixo, 5-dr Hatchback, 09–	255 mm	700 mm	10"	27 1/2"
SUZUKI Alto, 5-dr Hatchback, 09–	255 mm	700 mm	10"	27 1/2"

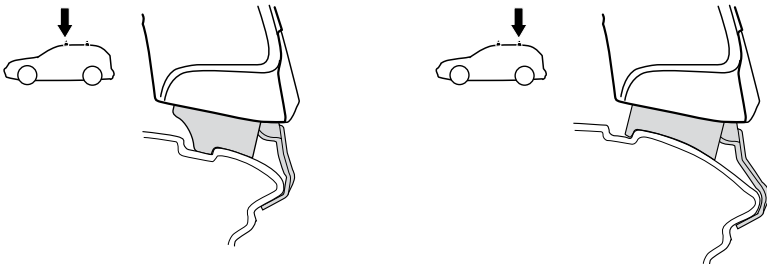
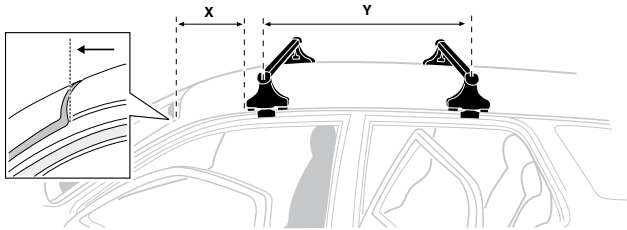

7

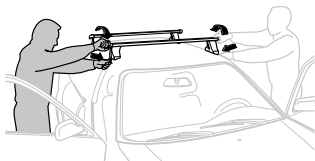

GB/US Tighten alternately
D Die Schrauben abwechselnd anziehen
F Serrer alternativement chaque côté
NL Afwisselend aan de linker- en de rechterkant aandraaien
I Alternare il serraggio delle viti
E Apertar alternativamente
PT Aperte alternadamente
S Dra åt växelvis
FIN Kierrä vuorotellen
EST Pinguldage vaheldumisi
LAT Pievelciēt pamišus
LIT Užsukinėkite pakaitomis
PL Śruby dokręcaj naprzemiennie
RU Затягивайте попеременно

CZ Pokrétla bagazníka dokręcaj dokręcaj naprzemiennie.
SK Doťahujte striedavo
SLO Privijajte izmenično.
HR Naizmjenično zategnite
HU Egymástól függetlenül szorítandó
GR Σφιγγετε εναλλάξ
TR Dönüşümlü sıkın

中文 交替拧紧

한국어 번갈아 가며 조이십시오.

日本語 交互に締め付けてください。

ไทย ชั้้นในแบบสลับ

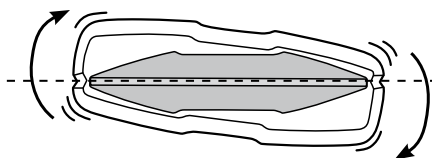
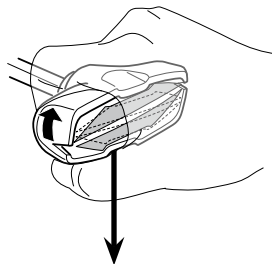
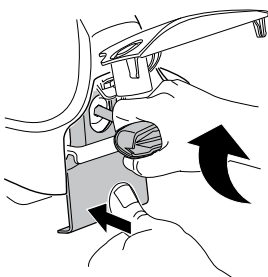
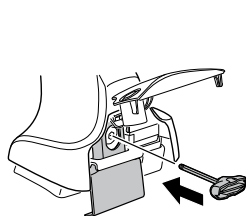

≈ 3 Nm

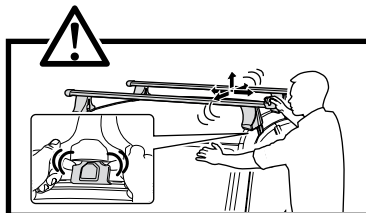
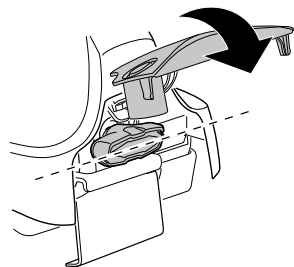

8



x1
17 mm

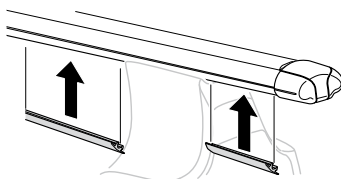

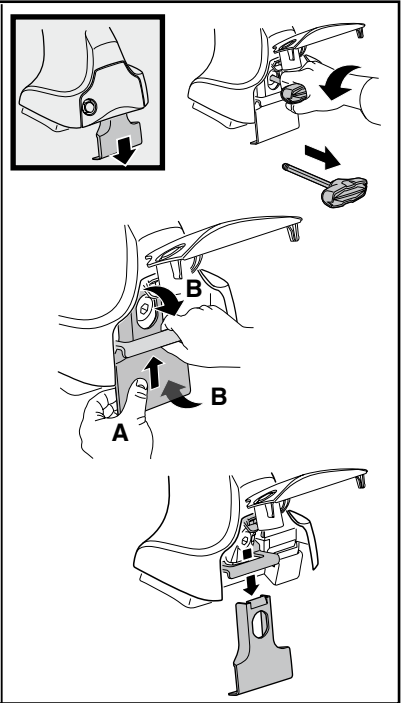
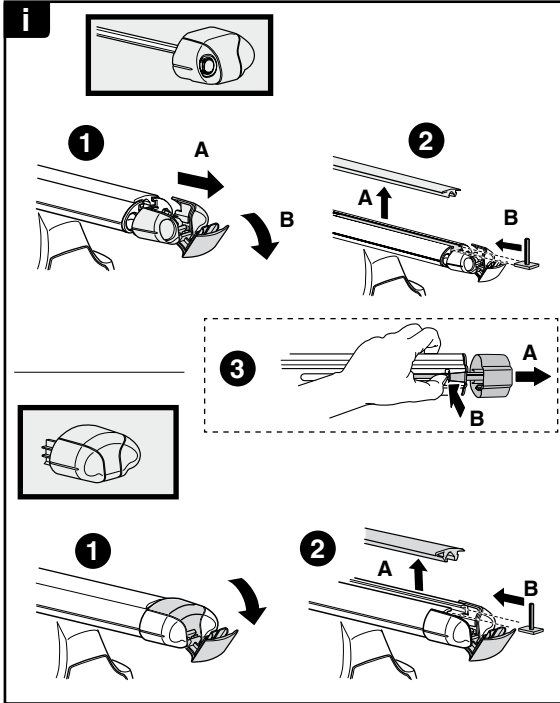
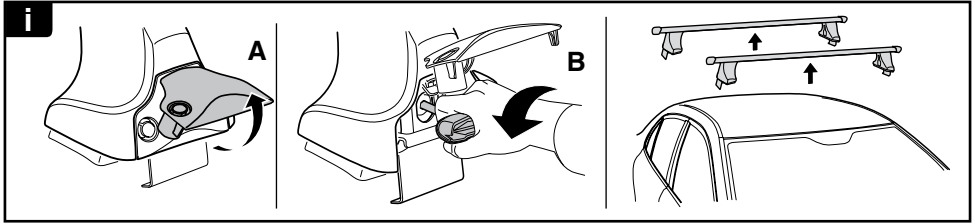

THULE
SWEDEN
**ONE
KEY
SYSTEM**

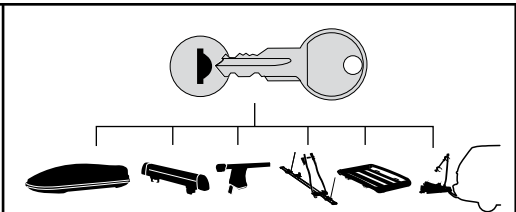

- 544 (x4)
 - 596 (x6)
 - 588 (x8)
 - 510 (x10)
 - 452 (x12)
- NA
EUR
ASIA

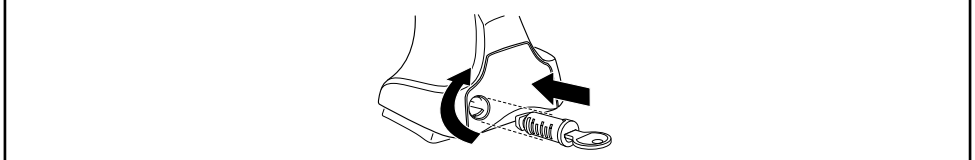

WW ▶ Thule Sweden AB, Box 69, 330 33 Hillerstorp, SWEDEN
NA ▶ Thule Inc., 42 Silvermine Road, Seymour, Connecticut 06483, USA

info@thule.com
customer.service@thule.com

www.thule.com