

Kit 1485

MITSUBISHI Delica, 5-dr MPV, 07-

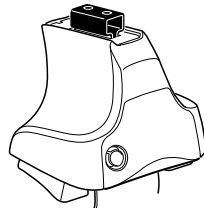

480R Rapid Traverse
754 Rapid System

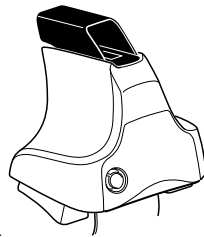
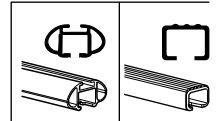

480 Traverse



1

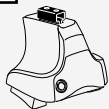

480R Rapid Traverse
754 Rapid System



480 Traverse

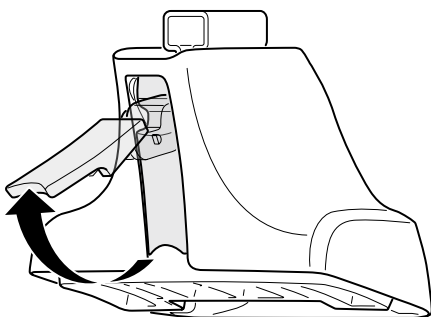

2

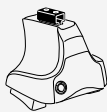

480R Rapid Traverse
754 Rapid System



480 Traverse

+

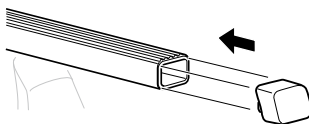
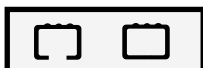
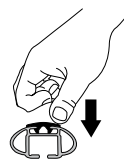
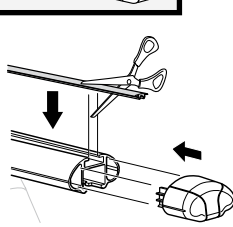
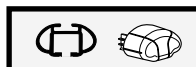
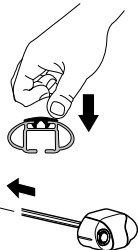
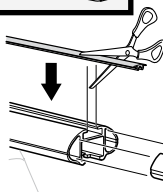
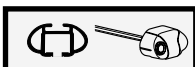
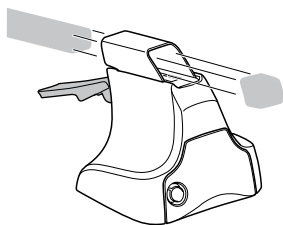
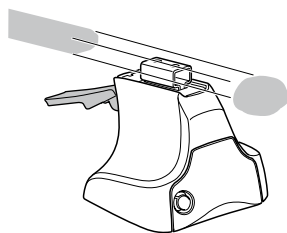

3

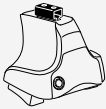

754 Rapid System

1

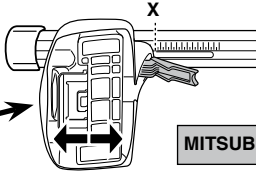
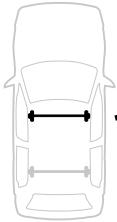

2

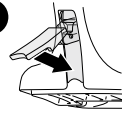

MITSUBISHI Delica, 5-dr MPV, 07-

X

55

1

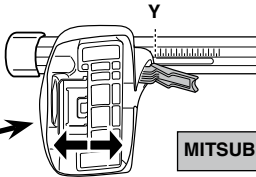
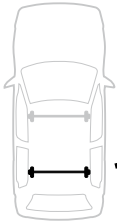

2

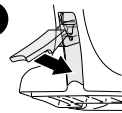

MITSUBISHI Delica, 5-dr MPV, 07-

Y

53,5



480R Rapid Traverse



480 Traverse

1

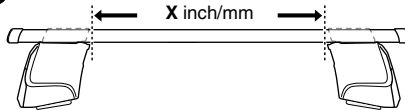

2

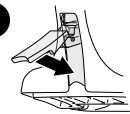

MITSUBISHI Delica, 5-dr MPV, 07-

X inch

X mm

47 1/4"

1200 mm

1

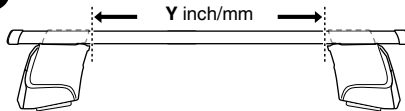

2

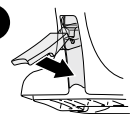

MITSUBISHI Delica, 5-dr MPV, 07-

Y inch

Y mm

46 3/4"

1185 mm

4



480R Rapid Traverse
754 Rapid System



480 Traverse

MITSUBISHI Delica, 5-dr MPV, 07-

346



1118



346

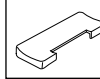

1118



347



1118



347

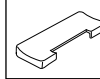

1118

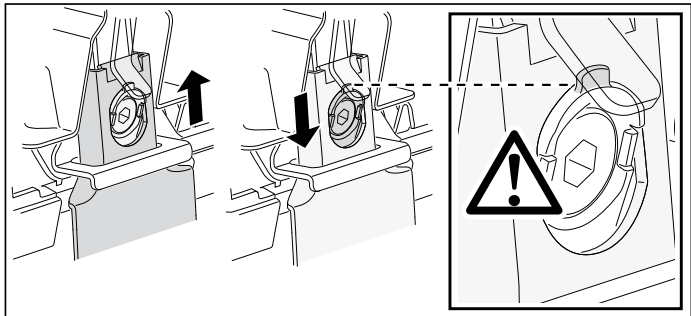
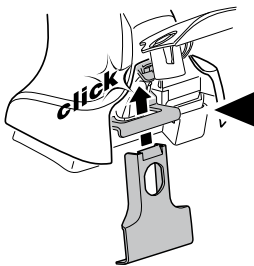
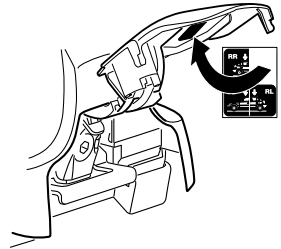
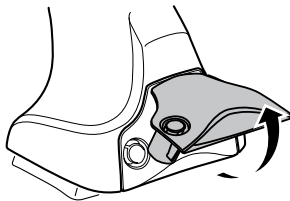
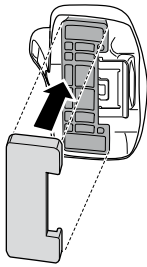

5



	X mm	Y mm	X inch	Y inch
MITSUBISHI Delica, 5-dr MPV, 07-	860 mm	700 mm	33 ⁷ / ₈ "	27 ¹ / ₂ "

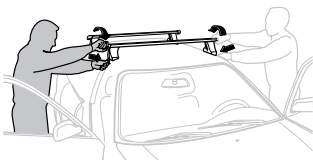
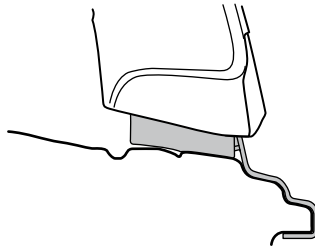
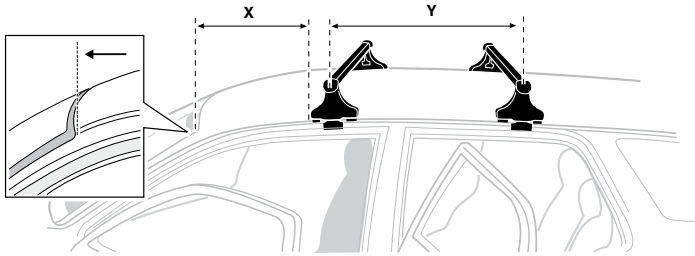

- | | | | |
|--------------|---|------------|---|
| GB/US | Tighten alternately | CZ | Pokreťta bagazníka dokrečaj dokrečaj naprzemiennie. |
| D | Die Schrauben abwechselnd anziehen | SK | Dofahujte striedavo |
| F | Serrer alternativement chaque côté | SLO | Privijajte izmenično. |
| NL | Afwisselend aan de linker- en de rechterkant aandraaien | HR | Naizmjenočno zategniti |
| I | Alternare il serraggio delle viti | HU | Egymástól függetlenül szorítandó |
| E | Apretar alternativamente | GR | Σφιγγεται εναλλάξ |
| PT | Aperte alternadamente | TR | Dönüşümlü sıkın |
| S | Dra åt växelvis | 中文 | 交替拧紧 |
| FIN | Kierrä vuorotellen | 한국어 | 번갈아 가며 조이십시오. |
| EST | Pinguldage vaheldumisi | 日本語 | 交互に締め付けてください。 |
| LAT | Pievēciēt pamāšus | ไทย | ขันในแบบสลับ |
| LIT | Užsukinėkite pakaitomis | | |
| PL | Śruby dokrećaj naprzemiennie | | |
| RU | Затягивайте попеременно | | |

6

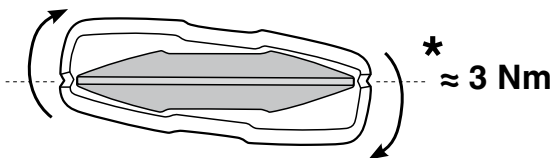
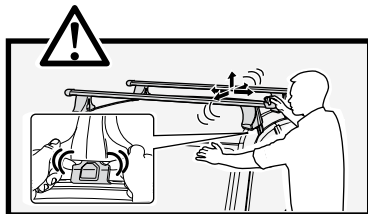
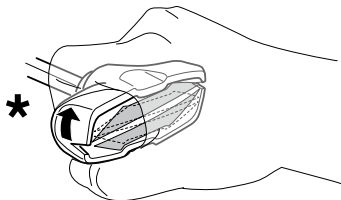
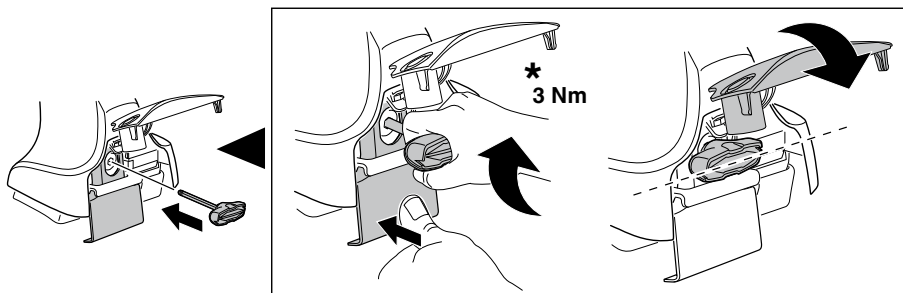
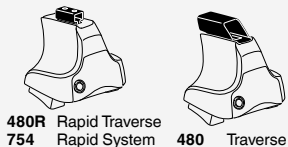

7

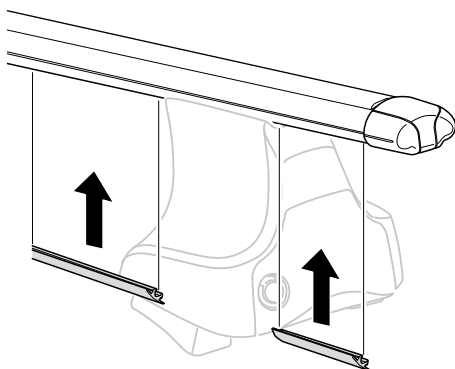
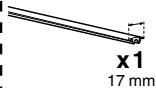

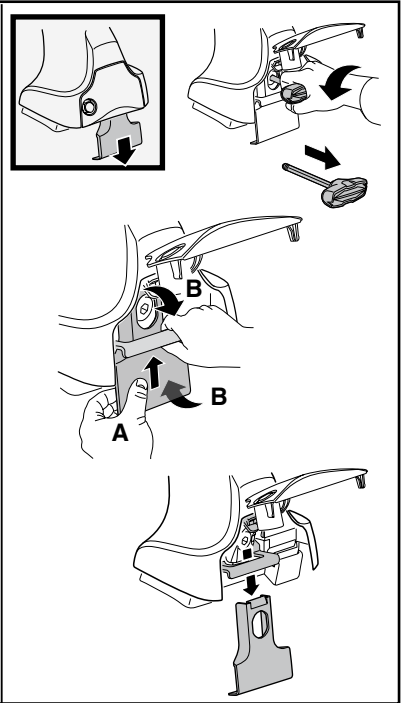
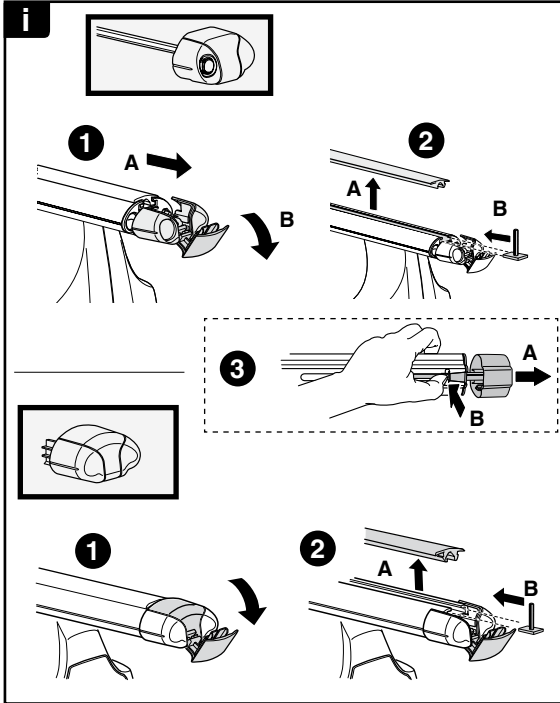

THULE
SWEDEN
**ONE
KEY
SYSTEM**

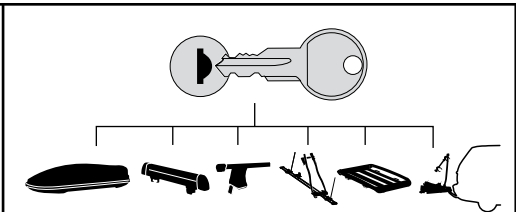

		(x4)
		(x6)
		(x8)
NA		(x10)
EUR		(x12)
ASIA		



WW ▶ Thule Sweden AB, Box 69, 330 33 Hillerstorp, SWEDEN
NA ▶ Thule Inc., 42 Silvermine Road, Seymour, Connecticut 06483, USA

info@thule.com
customer.service@thule.com

www.thule.com