

Kit 1459

AUDI TT, 3-dr Coupé, 06- / *07-

*North America

480R
754

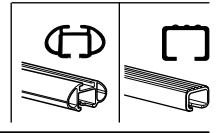
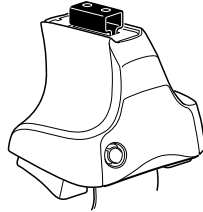

480

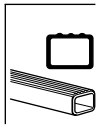
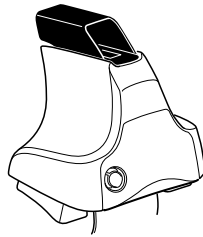

750

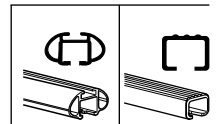
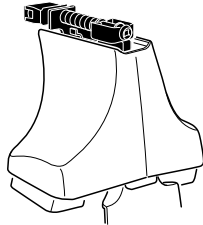

Kit

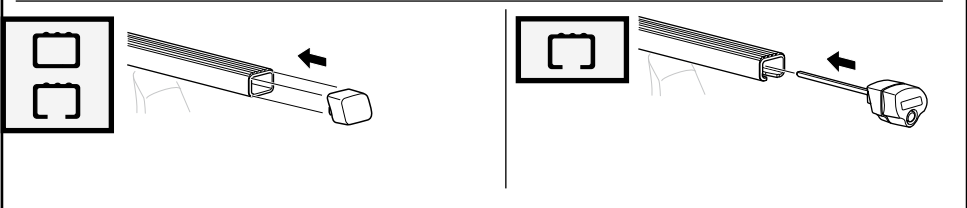
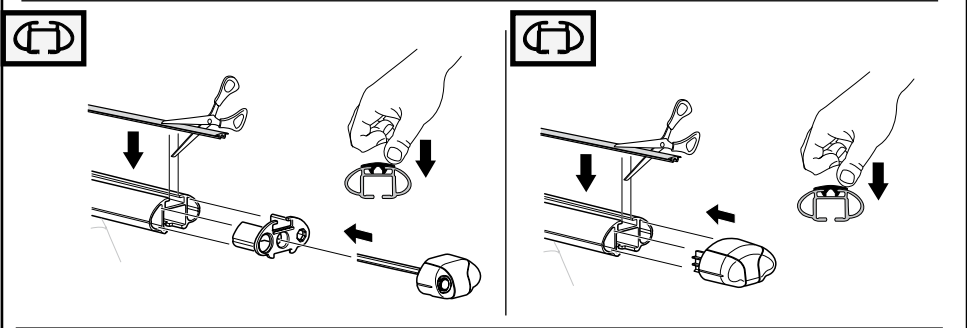
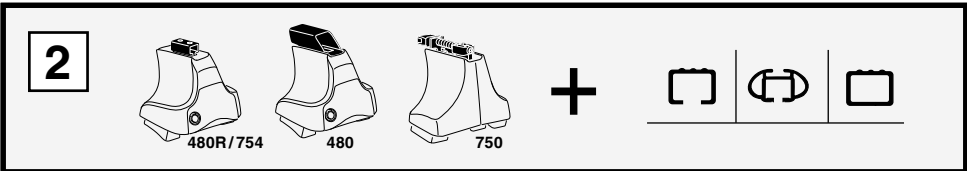

3



754



750



1

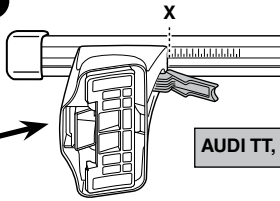
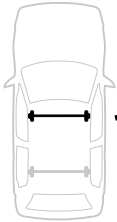

2

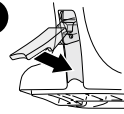

AUDI TT, 3-dr Coupé, 06- / *07-

X

41,5

1

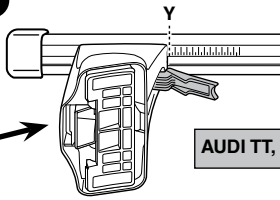
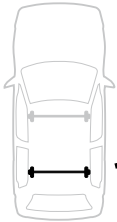

2

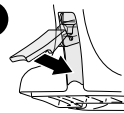

AUDI TT, 3-dr Coupé, 06- / *07-

Y

38



480R



480

1

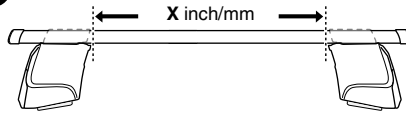
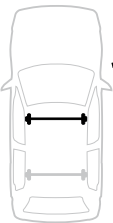

2

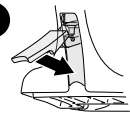

AUDI TT, 3-dr Coupé, 06- / *07-

X inch

X mm

42"

1066 mm

1

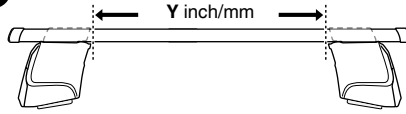

2

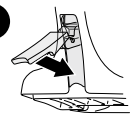

AUDI TT, 3-dr Coupé, 06- / *07-

Y inch

Y mm

40 5/8"

1031 mm

4

AUDI TT, 3-dr Coupé, 06- / *07-

204



916



206



916



206



917



204



917

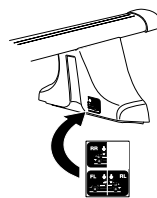
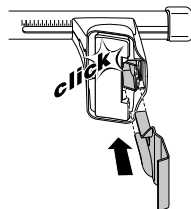
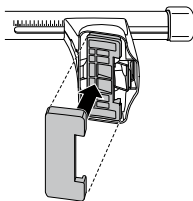
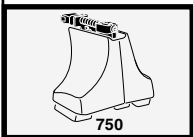
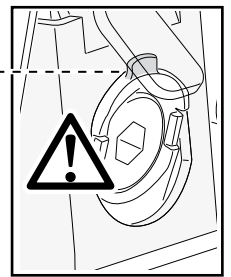
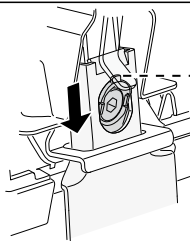
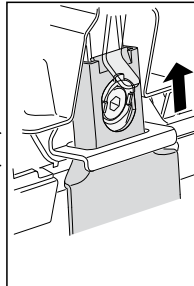
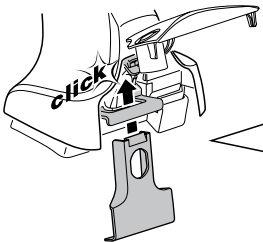
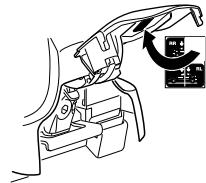
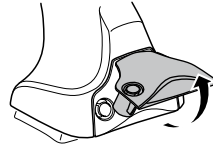
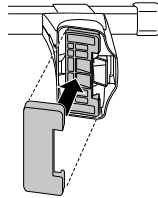
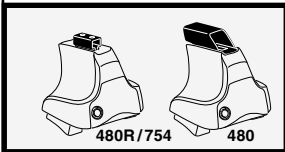

5

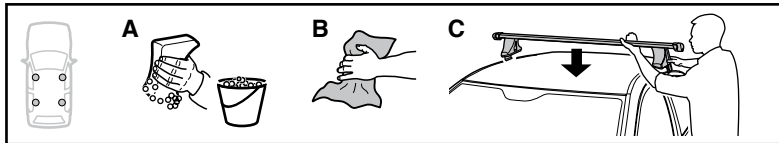

	X mm	Y mm	X inch	Y inch
AUDI TT, 3-dr Coupé, 06- / *07-	15 mm	615 mm	5/8"	24 1/4"

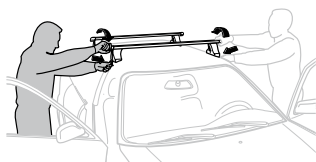
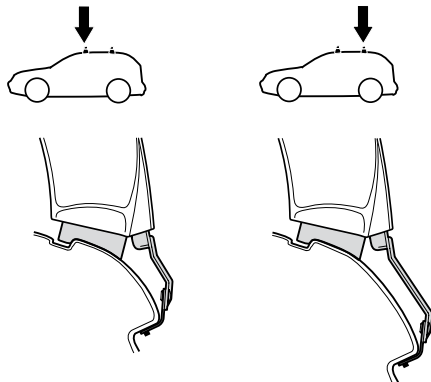
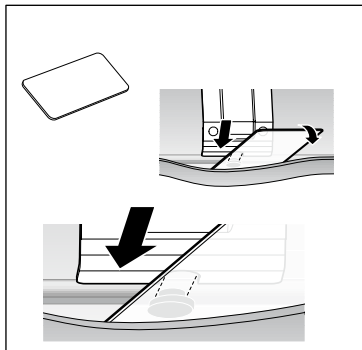
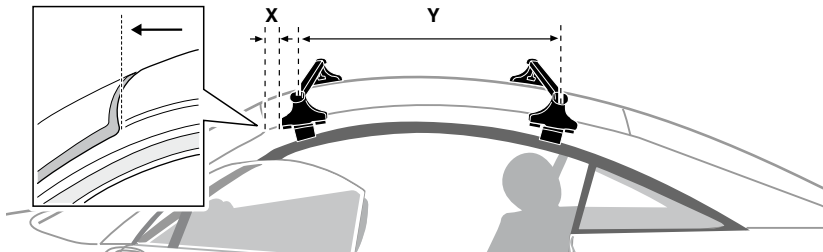

GB/US Tighten alternately
D Die Schrauben abwechselnd anziehen
F Serrer alternativement chaque côté
NL Afwisselend aan de linker- en de rechterkant aandraaien
I Alternare il serraggio delle viti
E Serrare alternativamente
PT Aperte alternadamente
S Dra åt växelvis
FIN Kierrä vuorotellen
EST Pinguldage vaheldumisi
LAT Pievelciēt pamišus
LIT Užsukinėkite pakaitomis
PL Śruby dokręcaj naprzemiennie
RU Затягивайте попеременно

CZ Pokrétla багаžníka dokręcaj dokręcaj naprzemiennie.
SK Dofahajte striedavo.
SLO Privijajte izmenično.
HR Naizmjerno zategnite.
HU Egymástól függetlenül szorítandó.
GR Σφιγγετε εναλλάξ.
TR Dönüşümlü sıkın
中文 交替拧紧
한국어 번갈아 가며 조이십시오.
日本語 交互に締め付けてください。
ไทย ชั้้นในแบบสลับ

6



480R/754



480

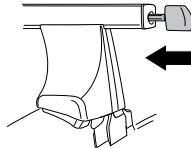
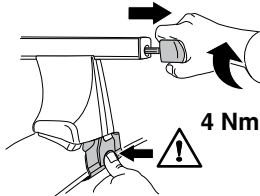
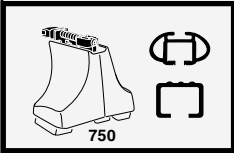
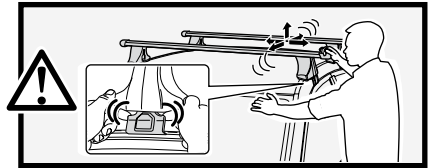
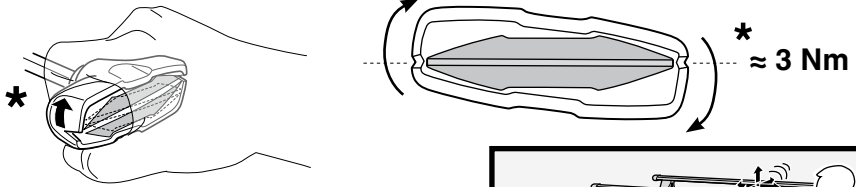
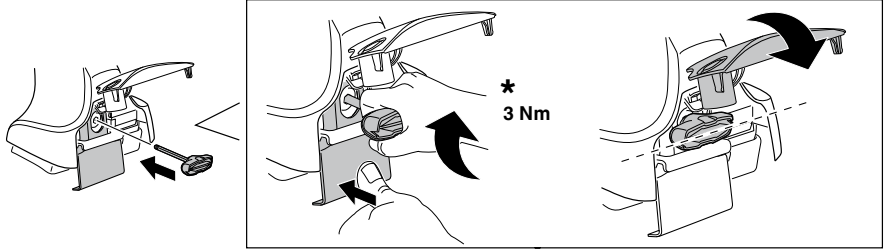

7

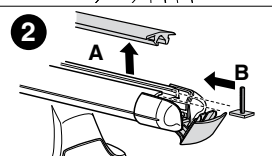
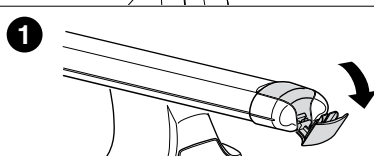
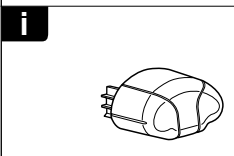
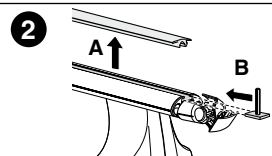
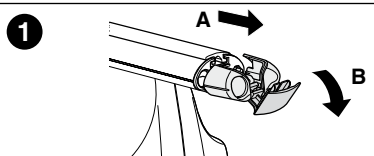
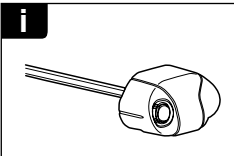
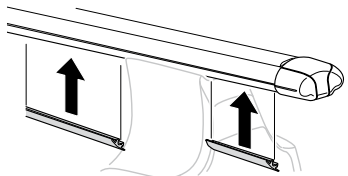
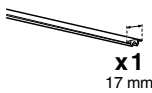

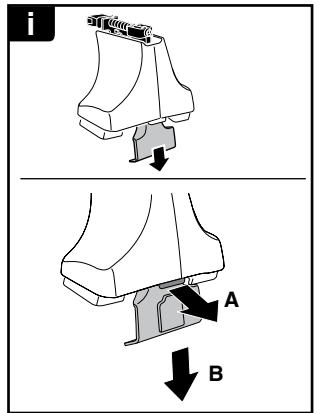
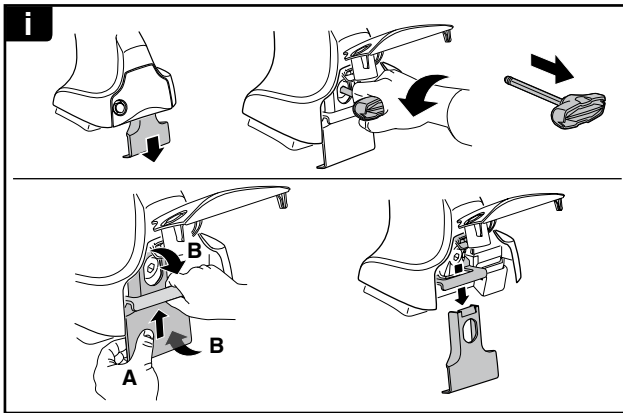
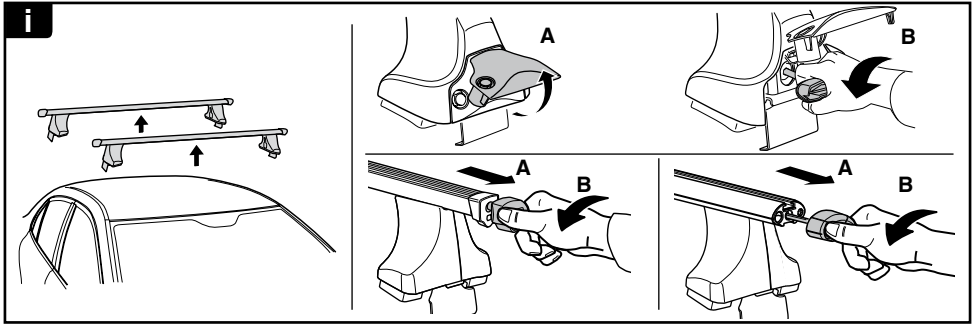

THULE
SWEDEN
**ONE
KEY
SYSTEM**



- 544 (x4)
- 596 (x6)
- 588 (x8)
- NA 510 (x10)
- EUR 452 (x12)
- ASIA



ww ▶ Thule Sweden AB, Box 69, 330 33 Hillerstorp, SWEDEN
NA ▶ Thule Inc., 42 Silvermine Road, Seymour, Connecticut 06483, USA

info@thule.com
customer.service@thule.com

www.thule.com