

Kit 1434

HYUNDAI Elantra, 4-dr Sedan, 06- / *07-

*North America

480R
754

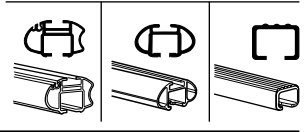
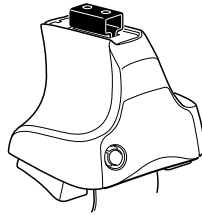

480

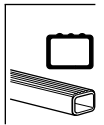
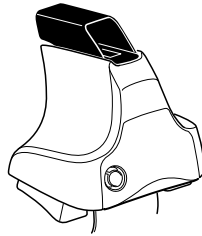

750

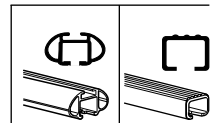
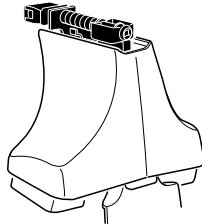

THULE[®]
SWEDEN

ISO 11154-E

Kit

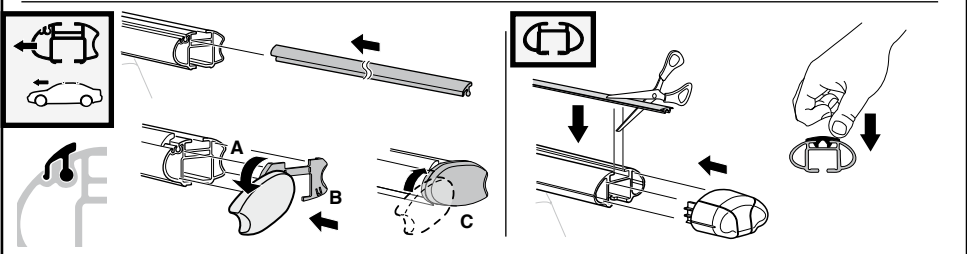
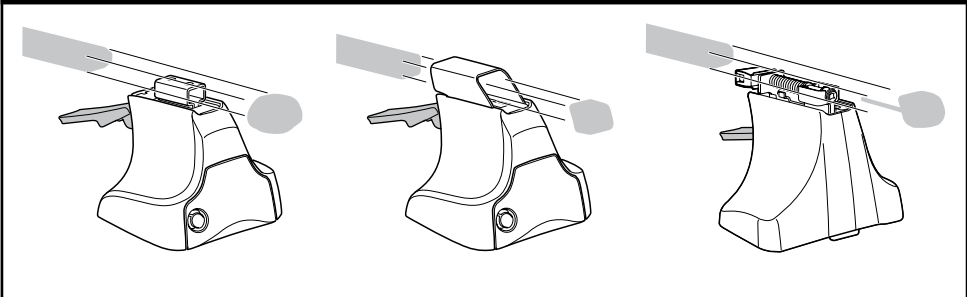

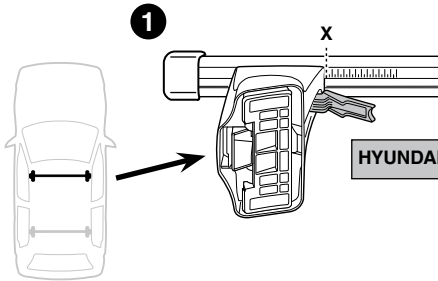

	X
HYUNDAI Elantra, 4-dr Sedan, 06- / *07-	38,5

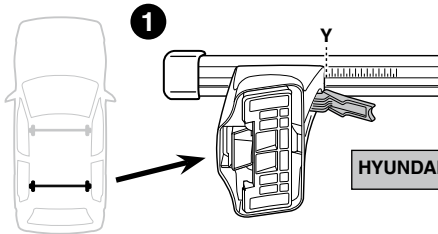
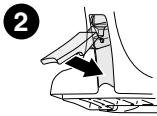

	Y
HYUNDAI Elantra, 4-dr Sedan, 06- / *07-	38,5

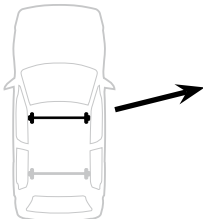
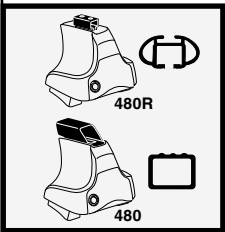
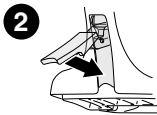

	X inch	X mm
HYUNDAI Elantra, 4-dr Sedan, 06- / *07-	40 ³ / ₈ "	1026 mm

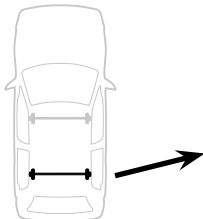
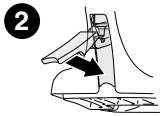

	Y inch	Y mm
HYUNDAI Elantra, 4-dr Sedan, 06- / *07-	40 ³ / ₄ "	1036 mm

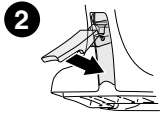

4

HYUNDAI Elantra, 4-dr Sedan, 06- / *07-

30



320



29



320



109



320



109



320

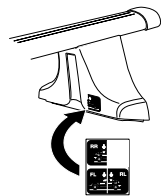
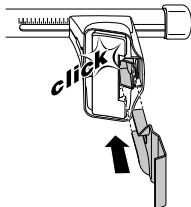
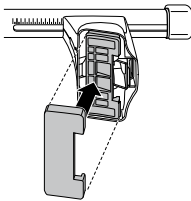
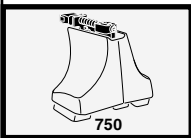
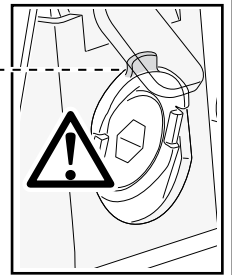
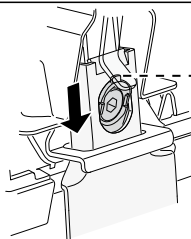
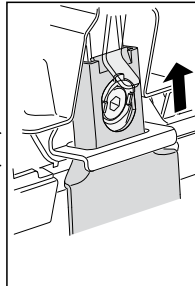
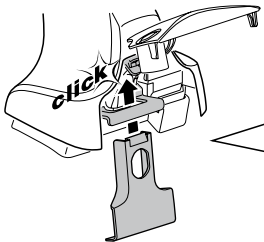
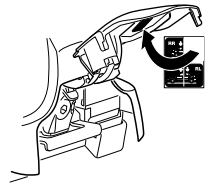
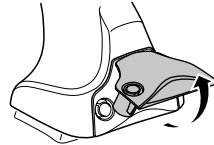
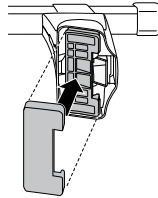
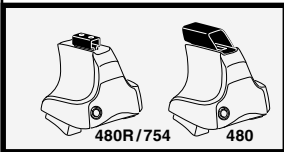

5



	X mm	Y mm	X inch	Y inch
HYUNDAI Elantra, 4-dr Sedan, 06- / *07-	230 mm	680 mm	9 "	26 3/4 "

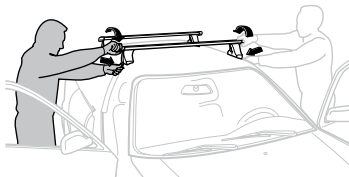
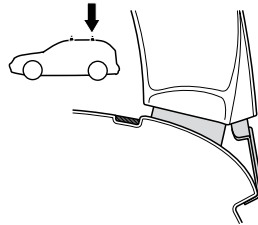
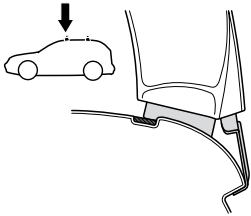
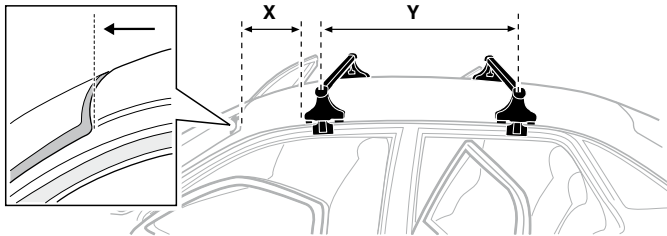

GB/US Tighten alternately

D Die Schrauben abwechselnd anziehen

F Serrer alternativement chaque côté

NL Afwisselend aan de linker- en de rechterkant aandraaien

I Alternare il serraggio delle viti

E Serrare alternativamente

PT Aperte alternadamente

S Dra åt växelvis

FIN Kierrä vuorotellen

EST Pinguldage vaheldumisi

LAT Pielieciet pamišus

LIT Užsukinėkite pakaitomis

PL Śruby dokręcaj naprzemiennie

RU Затягивайте попеременно

CZ Pokręťta bagažníka dokręcaj dokręcaj naprzemiennie.

SK Doťahujte striedavo

SLO Privijajte izmenično.

HR Naizmjenično zategnite

HU Egymástól függetlenül szorítandó

GR Σφιγγετε εναλλάξ

TR Dönüşümlü sıkın

中文 交替拧紧

한국어 번갈아 가며 조이십시오.

日本語 交互に締め付けてください。

ไทย ชันในแบบสลับ

6



480R/754



480

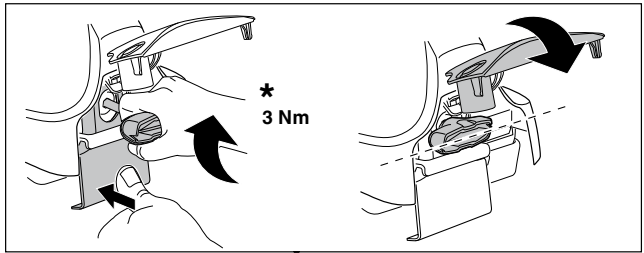

*
3 Nm



*



*
≈ 3 Nm

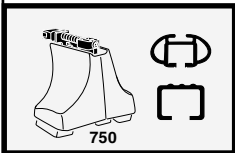
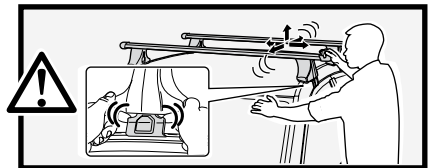

750

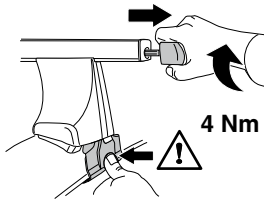

4 Nm

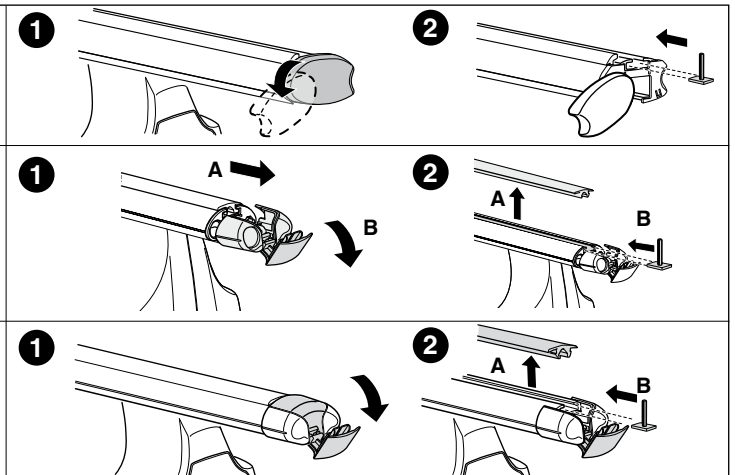
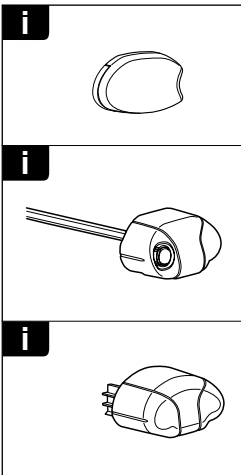
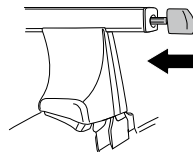



THULE
SWEDEN
**ONE
KEY
SYSTEM**



544		(x4)
596		(x6)
588		(x8)
NA 510		(x10)
EUR		
ASIA 452		(x12)

