

Kit 1388

HYUNDAI Sonata, 4-dr Sedan, 05- / *06-10

*North America

480R
754

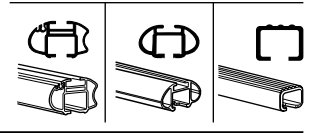
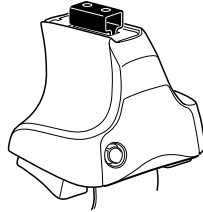

480

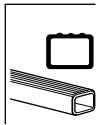
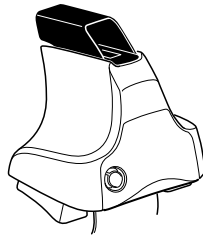

750

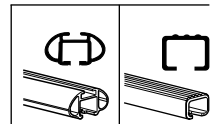
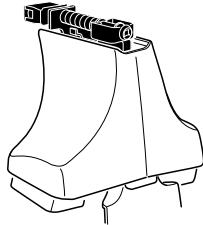

480R/754

480

750

x2 x2 x2 x4	x2	x2 x2 x4 x4	x2 x2	x2

161 x2

219 x1

735 x2

218 x1

734 x1

748 x1

x1

Kit



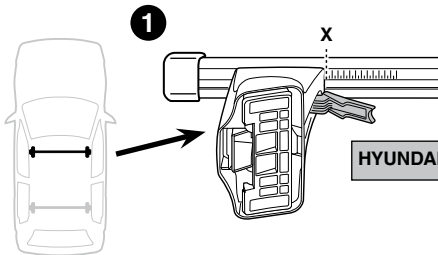

	X
HYUNDAI Sonata, 4-dr Sedan, 05- / *06-10	42,5

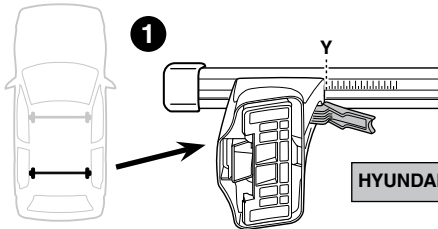

	Y
HYUNDAI Sonata, 4-dr Sedan, 05- / *06-10	39

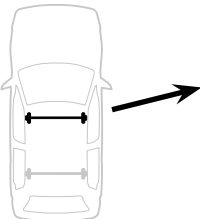
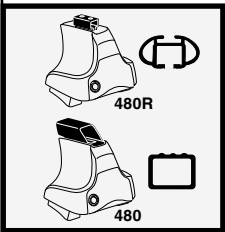

	X inch	X mm
HYUNDAI Sonata, 4-dr Sedan, 05- / *06-10	42 3/8"	1076 mm

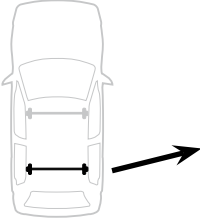
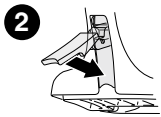

	Y inch	Y mm
HYUNDAI Sonata, 4-dr Sedan, 05- / *06-10	41"	1041 mm

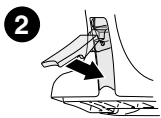

4

HYUNDAI Sonata, 4-dr Sedan, 05- / *06-10

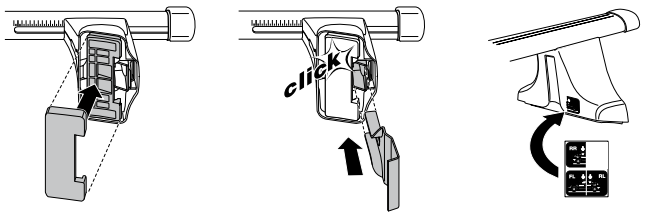
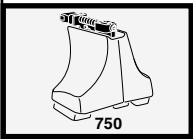
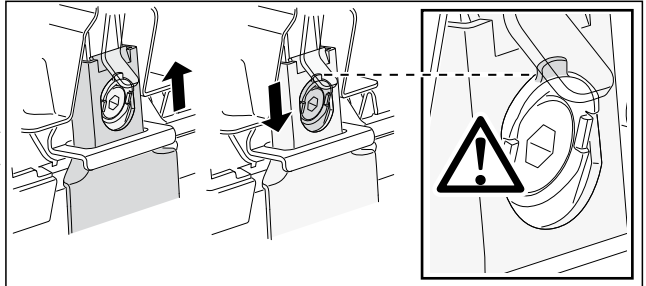
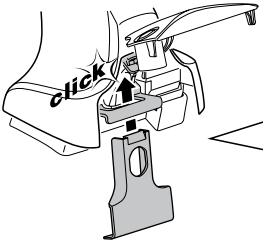
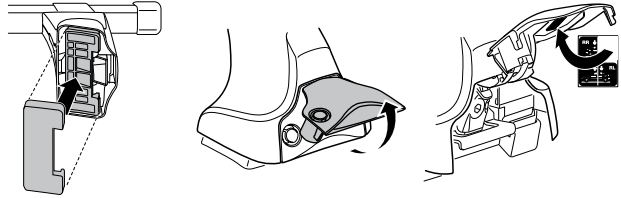
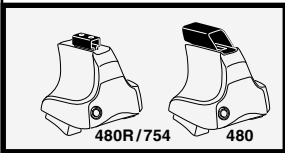
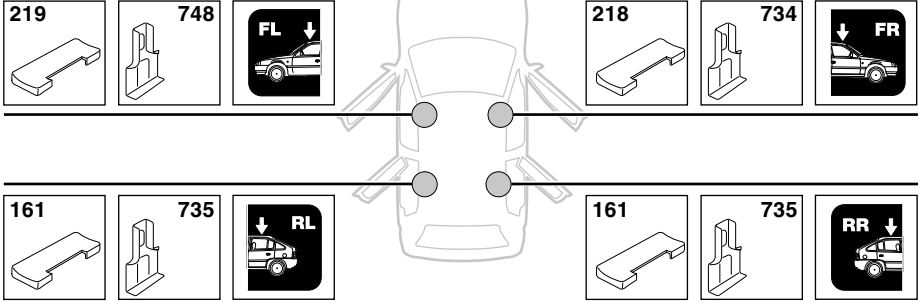

5

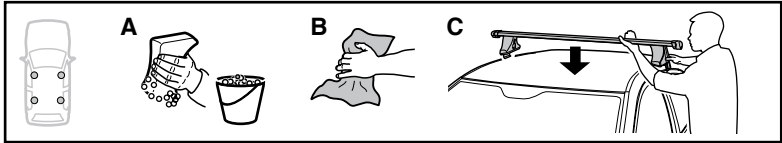

	X mm	Y mm	X inch	Y inch
HYUNDAI Sonata, 4-dr Sedan, 05- / *06-10	230 mm	670 mm	9"	26 7/8"

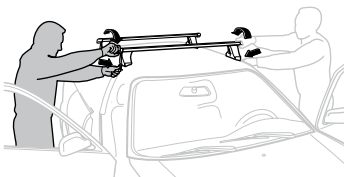
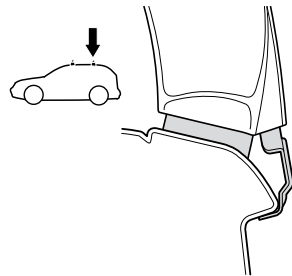
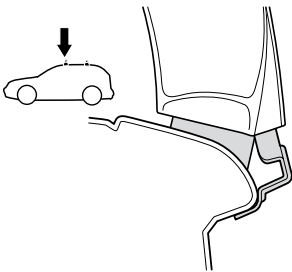
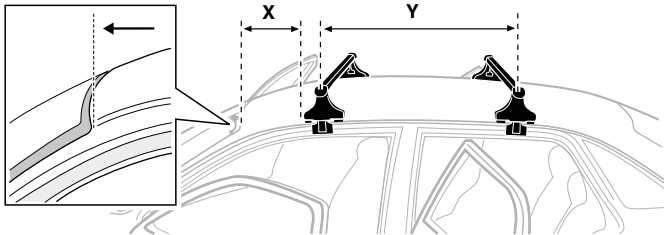

GB/US Tighten alternately

D Die Schrauben abwechselnd anziehen

F Serrer alternativement chaque côté

NL Afwisselend aan de linker- en de rechterkant aandraaien

I Alternare il serraggio delle viti

E Serrare alternativamente

PT Aperte alternadamente

S Dra åt växelvis

FIN Kierrä vuorotellen

EST Pinguldage vaheldumisi

LAT Pievelciet pamišus

LIT Užsukinėkite pakaitomis

PL Śruby dokręcaj naprzemiennie

RU Затягивайте попеременно

CZ Pokręťta bagażníka dokręcaj dokręcaj naprzemiennie.

SK Dotahujte striedavo

SLO Privijajte izmenično.

HR Naizmjenično zategnite

HU Egymástól függetlenül szorítandó

GR Σφιγγετε εναλλάξ

TR Dönüşümlü sıkın

中文 交替拧紧

한국어 번갈아 가며 조이십시오.

日本語 交互に締め付けてください。

ไทย ชั้้นในแบบสลับ

6



480R/754



480

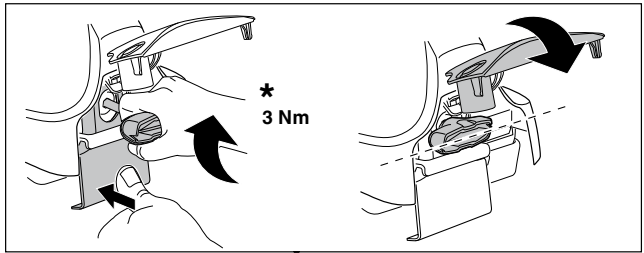

*
3 Nm



*



*
≈ 3 Nm

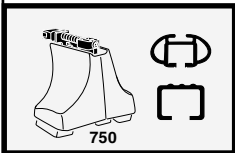
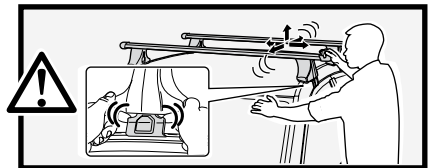

750

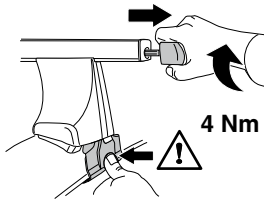

4 Nm

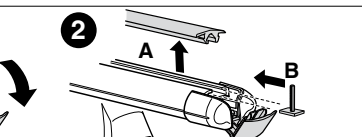
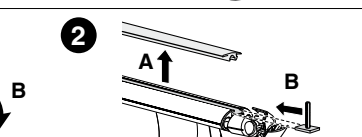
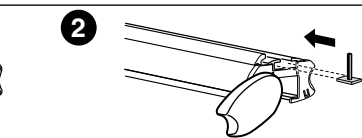
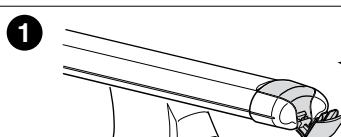
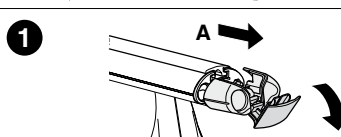
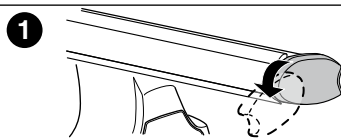
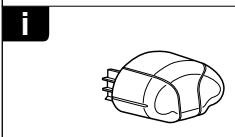
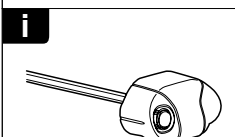
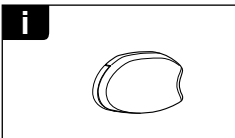
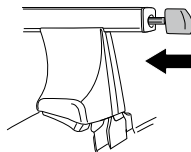

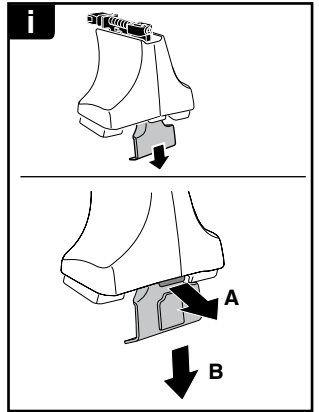
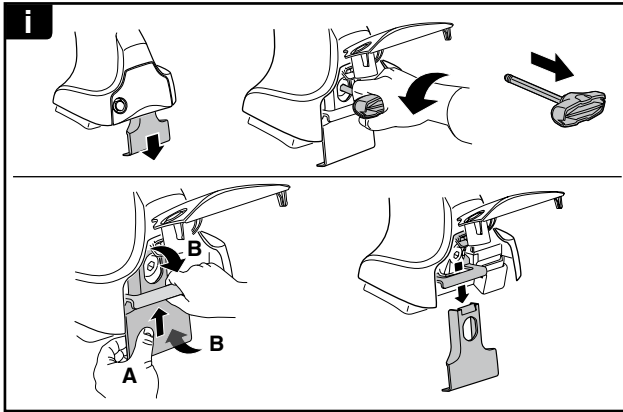

THULE
SWEDEN
**ONE
KEY
SYSTEM**



- 544 (x4)
- 596 (x6)
- 588 (x8)
- NA 510 (x10)
- EUR 452 (x12)
- ASIA



WW ▶ Thule Sweden AB, Box 69, 330 33 Hillerstorp, SWEDEN
NA ▶ Thule Inc., 42 Silvermine Road, Seymour, Connecticut 06483, USA

info@thule.com
customer.service@thule.com

www.thule.com