

# Kit 1336

NISSAN Cube, 5-dr MPV, 02- / \*09-

NISSAN Cube3 (Cubic), 5-dr MPV, 03-

\*North America

480R  
754

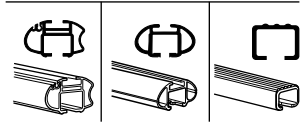
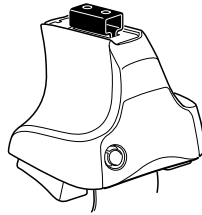

480

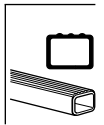
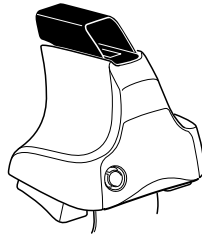

750

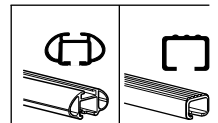
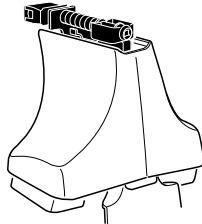

**THULE**<sup>®</sup>  
SWEDEN

ISO 11154-E

**Kit**



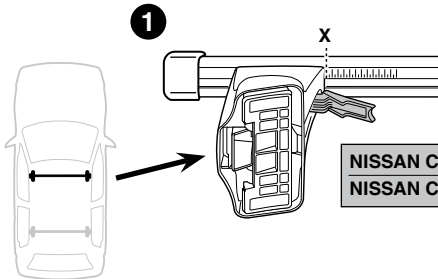
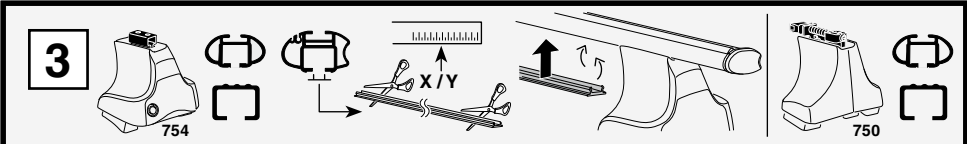

	X
<b>NISSAN Cube, 5-dr MPV, 02- / *09-</b>	64
<b>NISSAN Cube3 (Cubic), 5-dr MPV, 03-</b>	64

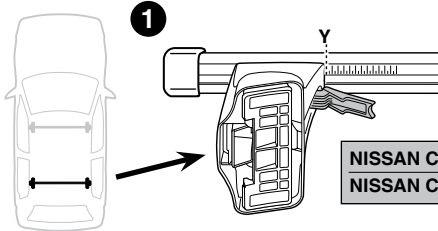

	Y
<b>NISSAN Cube, 5-dr MPV, 02- / *09-</b>	62,5
<b>NISSAN Cube3 (Cubic), 5-dr MPV, 03-</b>	62,5

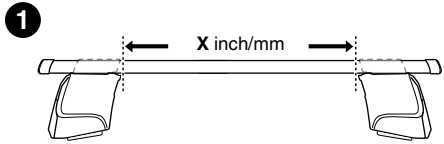
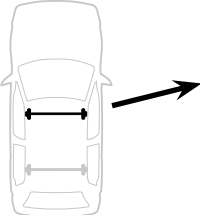
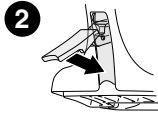

	X inch	X mm
<b>NISSAN Cube, 5-dr MPV, 02- / *09-</b>	50 <sup>7</sup> / <sub>8</sub> "	1291 mm
<b>NISSAN Cube3 (Cubic), 5-dr MPV, 03-</b>	50 <sup>7</sup> / <sub>8</sub> "	1291 mm

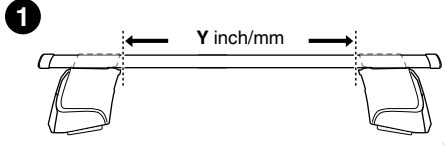
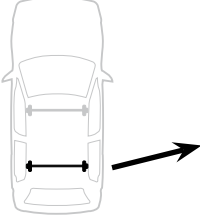
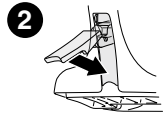

	Y inch	Y mm
<b>NISSAN Cube, 5-dr MPV, 02- / *09-</b>	50 <sup>1</sup> / <sub>4</sub> "	1276 mm
<b>NISSAN Cube3 (Cubic), 5-dr MPV, 03-</b>	50 <sup>1</sup> / <sub>4</sub> "	1276 mm

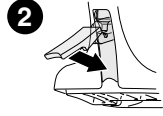

# 4

NISSAN Cube, 5-dr MPV, 02- / \*09-  
 NISSAN Cube3 (Cubic), 5-dr MPV, 03-

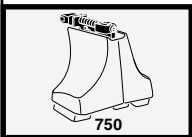
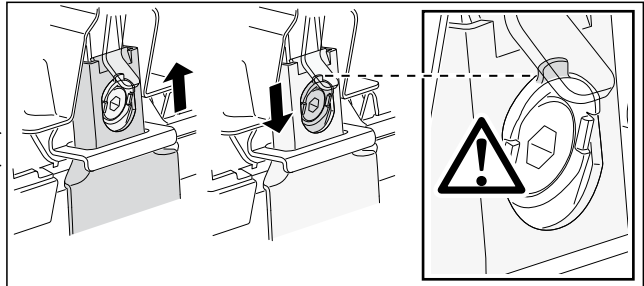
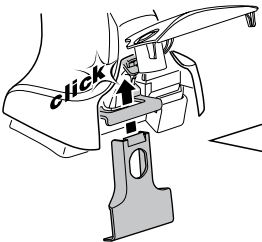
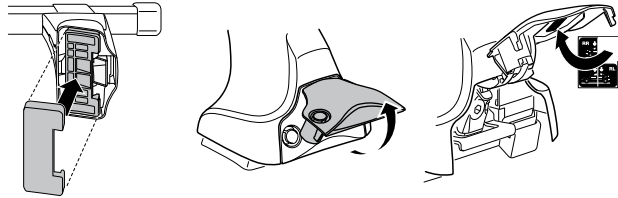
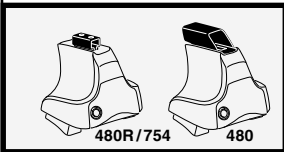
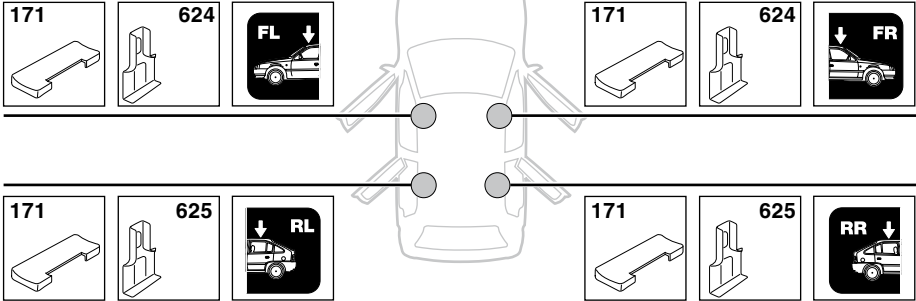

5



	X mm	Y mm	X inch	Y inch
<b>NISSAN Cube</b> , 5-dr MPV, 02- / *09-	545 mm	700 mm	21 1/2"	27 1/2"
<b>NISSAN Cube3 (Cubic)</b> , 5-dr MPV, 03-	545 mm	700 mm	21 1/2"	27 1/2"

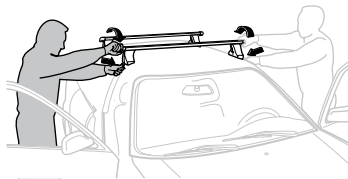
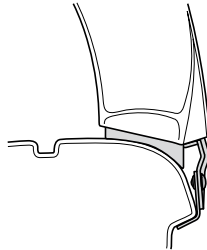
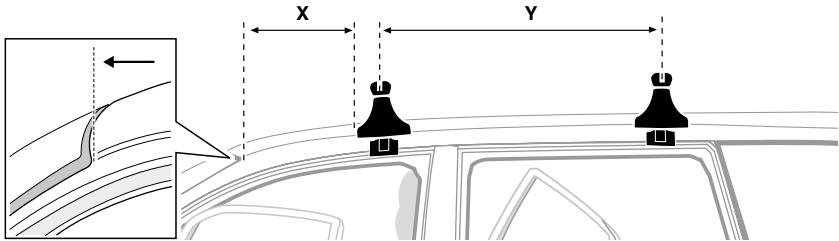

**GB/US** Tighten alternately

**D** Die Schrauben abwechselnd anziehen

**F** Serrer alternativement chaque côté

**NL** Afwisselend aan de linker- en de rechterkant aandraaien

**I** Alternare il serraggio delle viti

**E** Apretar alternativamente

**PT** Aperte alternadamente

**S** Dra åt växelvis

**FIN** Kierrä vuorotellen

**EST** Pinguldage vaheldumisi

**LAT** Pielvelciēt pamāšus

**LIT** Užsukinėkite pakaitomis

**PL** Śruby dokręcaj naprzemiennie

**RU** Затягивайте попеременно

**CZ** Pokręťta bagožníka dokręcaj dokręcaj naprzemiennie.

**SK** Doťahujte striedavo

**SLO** Privijajte izmenično.

**HR** Naizmjenično zategnite

**HU** Egymástól függetlenül szorítandó

**GR** Σφίγγετε εναλλάξ

**TR** Dönüşümlü sıkın

**中文** 交替拧紧

**한국어** 번갈아 가며 조이십시오.

**日本語** 交互に締め付けてください。

**ไทย** ชั้้นในแบบสลับ

6



480R/754



480

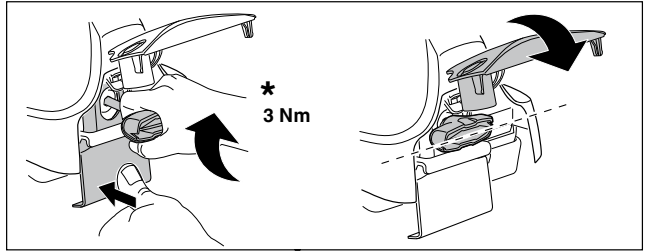
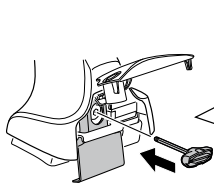

\*  
3 Nm

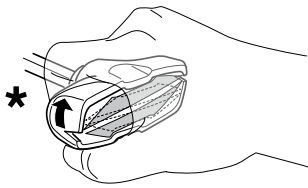

\*

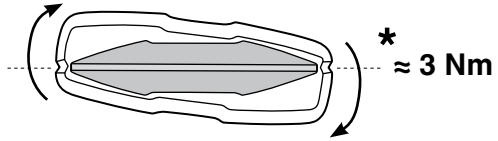

\*  
≈ 3 Nm

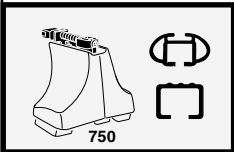
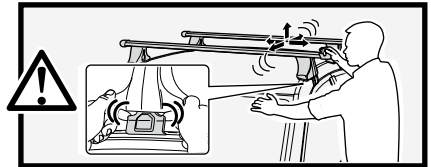

750

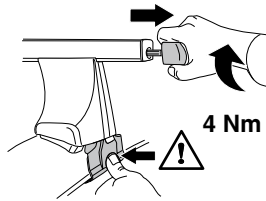

4 Nm

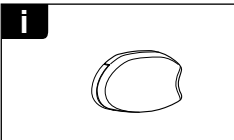
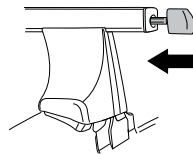

i

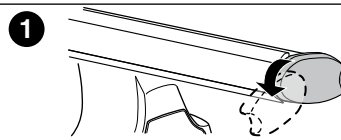

1

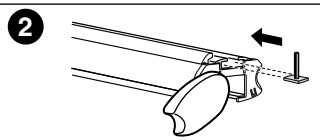

2

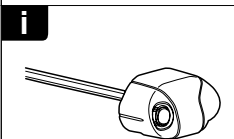

i

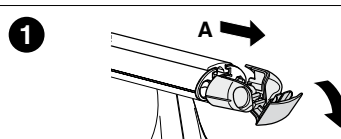

1

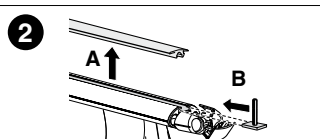

2

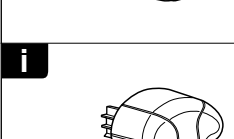

i



1

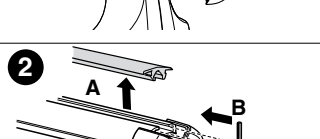

2



**THULE**  
SWEDEN  
**ONE  
KEY  
SYSTEM**



<b>544</b>		(x4)
<b>596</b>		(x6)
<b>588</b>		(x8)
NA <b>510</b>		(x10)
EUR		
ASIA <b>452</b>		(x12)



WW ▶ Thule Sweden AB, Box 69, 330 33 Hillerstorp, SWEDEN  
NA ▶ Thule Inc., 42 Silvermine Road, Seymour, Connecticut 06483, USA

info@thule.com  
customer.service@thule.com

www.thule.com

503-1336-02