

# Kit 1229

JAGUAR X-Type, 4-dr Sedan, 01-09 / \*02-08

\*North America

480R  
754

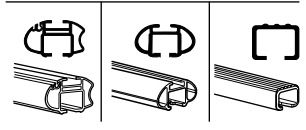
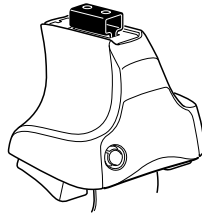

480

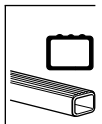
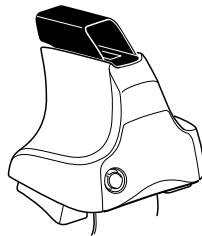

750

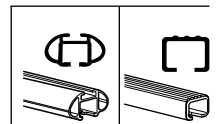
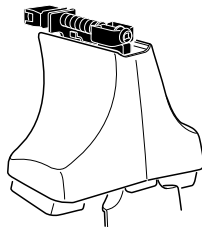

x2 x2 x2 x4	x2	x2 x2 x4 x4	x2 x2	x2

**407** x 4

**15** x 4

x 1

**Kit**



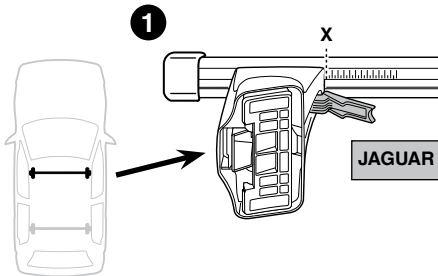

	X
JAGUAR X-Type, 4-dr Sedan, 01-09 / *02-08	32

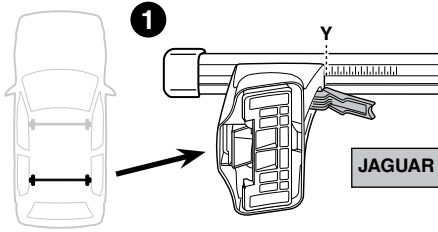
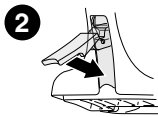

	Y
JAGUAR X-Type, 4-dr Sedan, 01-09 / *02-08	32,5

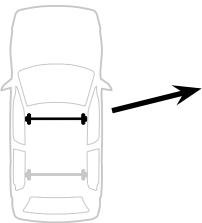
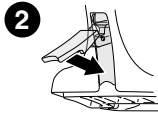

	X inch	X mm
JAGUAR X-Type, 4-dr Sedan, 01-09 / *02-08	38 1/4"	971 mm

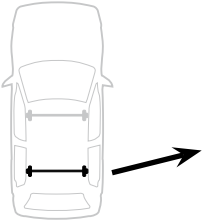
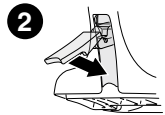
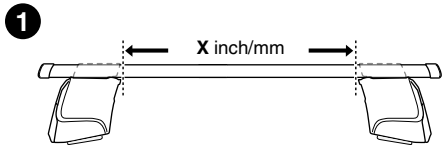

	Y inch	Y mm
JAGUAR X-Type, 4-dr Sedan, 01-09 / *02-08	38 3/8"	976 mm

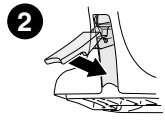
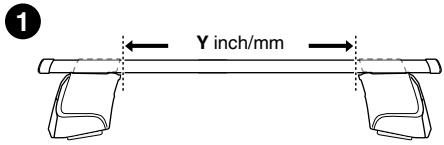

# 4

JAGUAR X-Type, 4-dr Sedan, 01-09 / \*02-08

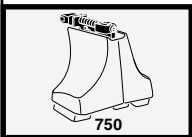
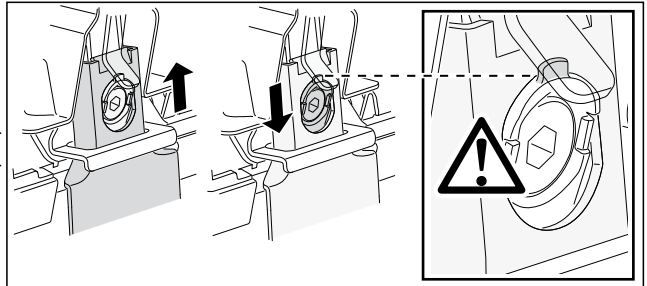
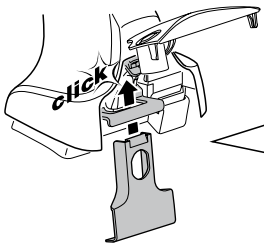
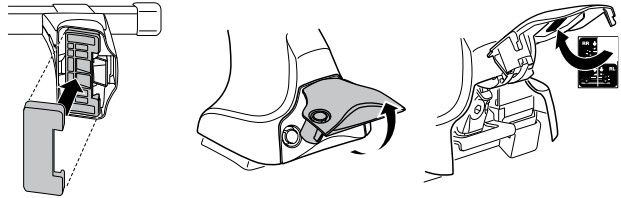
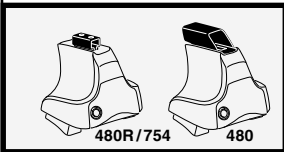
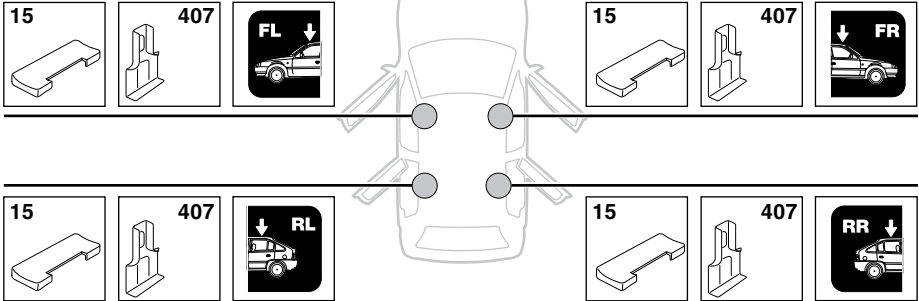

5



	X mm	Y mm	X inch	Y inch
<b>JAGUAR X-Type, 4-dr Sedan, 01-09 / *02-08</b>	<b>260 mm</b>	<b>670 mm</b>	<b>10 1/4"</b>	<b>26 3/8"</b>

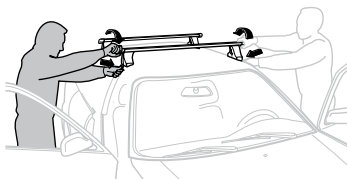
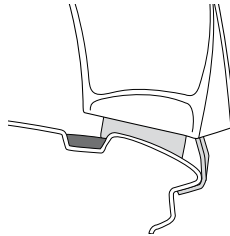
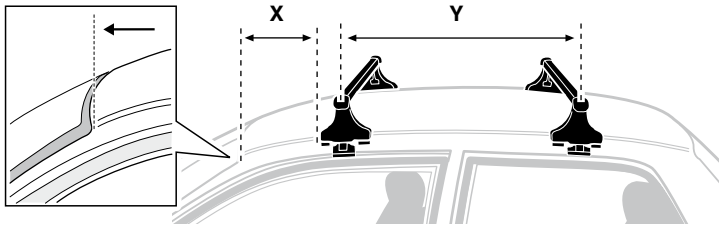

**GB/US** Tighten alternately

**D** Die Schrauben abwechselnd anziehen

**F** Serrer alternativement chaque côté

**NL** Afwisselend aan de linker- en de rechterkant aandraaien

**I** Alternare il serraggio delle viti

**E** Apretar alternativamente

**PT** Aperte alternadamente

**S** Dra åt växelvis

**FIN** Kierrä vuorotellen

**EST** Pinguldage vaheldumisi

**LAT** Pielieciet pamišus

**LIT** Užsukinėkite pakaitomis

**PL** Śruby dokręcaj naprzemiennie

**RU** Затягивайте попеременно

**CZ** Pokręťta багаžníka dokręcaj dokręcaj naprzemiennie.

**SK** Doťahujte striedavo

**SLO** Privijajte izmenično.

**HR** Naizmjenično zategnite

**HU** Egymástól függetlenül szorítandó

**GR** Σφιγγετε εναλλάξ

**TR** Dönüşümlü sıkın

**中文** 交替拧紧

**한국어** 번갈아 가며 조이십시오.

**日本語** 交互に締め付けてください。

**ไทย** ชันโนแบบสลับ

6



480R/754



480

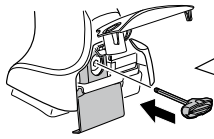

\*  
3 Nm



\*



\*  
≈ 3 Nm

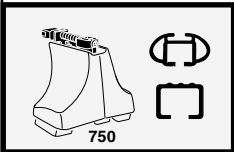
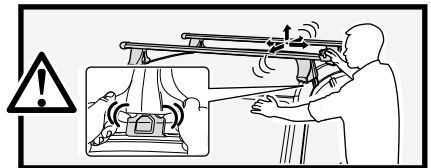

750

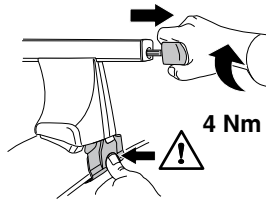

4 Nm

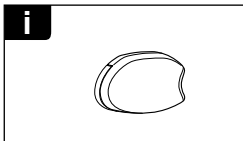
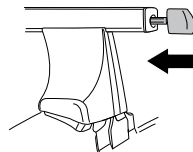

i

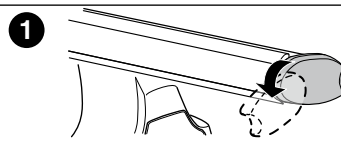

1

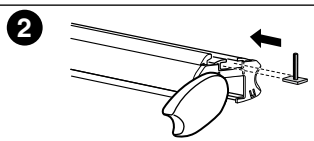

2

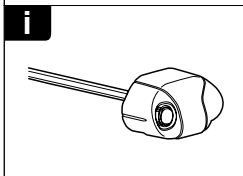

i

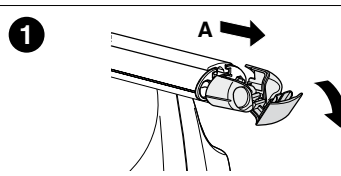

1

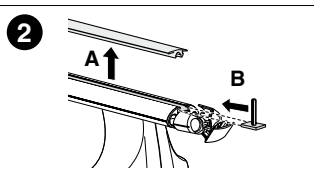

2

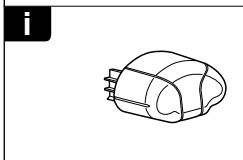

i

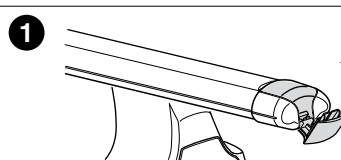

1

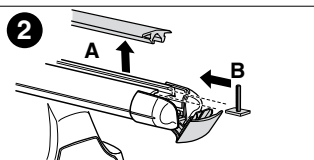

2



**THULE**  
SWEDEN  
**ONE  
KEY  
SYSTEM**



		(x4)
		(x6)
		(x8)
NA		(x10)
EUR		(x12)
ASIA		(x12)

