

# Kit 1190

**KIA Sephia II, 5-dr Hatchback, 98-01**

**KIA Sephia II, 4-dr Sedan, 98-01**

**KIA Sephia, 4-dr Sedan, \*98-01**

**KIA Shuma, 5-dr Hatchback, 98-04**

**KIA Shuma, 4-dr Sedan, 98-04**

**KIA Spectra, 4-dr Sedan, 01-04 / \*00-04**

\*North America

480R  
754

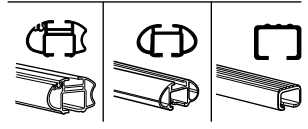
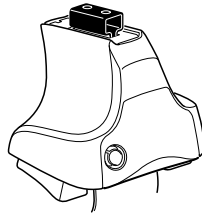

480

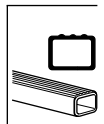
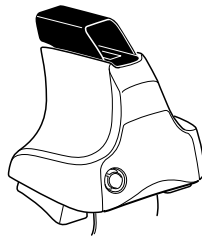

750

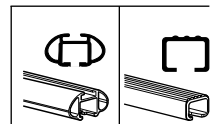
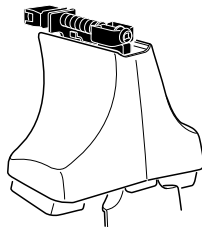

**THULE**<sup>®</sup>  
SWEDEN

ISO 11154-E

**Kit**



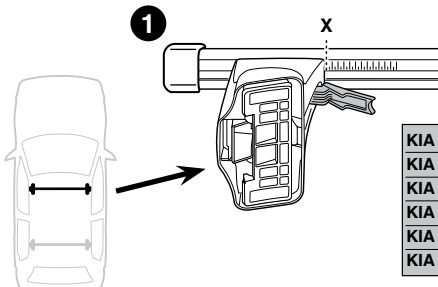
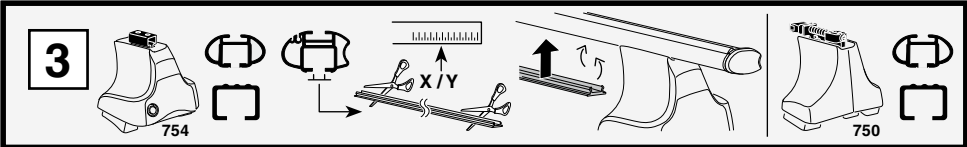

	X
<b>KIA Sephia II, 5-dr Hatchback, 98-01</b>	26
<b>KIA Sephia II, 4-dr Sedan, 98-01</b>	26,5
<b>KIA Sephia, 4-dr Sedan, *98-01</b>	26,5
<b>KIA Shuma, 5-dr Hatchback, 98-04</b>	26
<b>KIA Shuma, 4-dr Sedan, 98-04</b>	26,5
<b>KIA Spectra, 4-dr Sedan, 01-04 / *00-04</b>	26,5

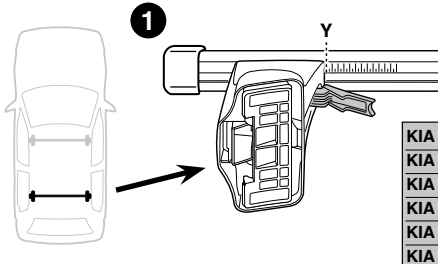

	Y
<b>KIA Sephia II, 5-dr Hatchback, 98-01</b>	24,5
<b>KIA Sephia II, 4-dr Sedan, 98-01</b>	25
<b>KIA Sephia, 4-dr Sedan, *98-01</b>	25
<b>KIA Shuma, 5-dr Hatchback, 98-04</b>	24,5
<b>KIA Shuma, 4-dr Sedan, 98-04</b>	25
<b>KIA Spectra, 4-dr Sedan, 01-04 / *00-04</b>	25

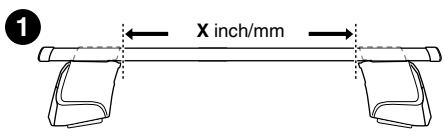
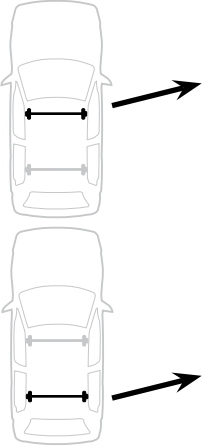
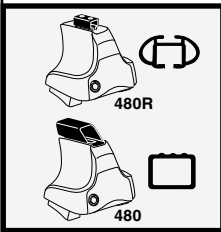

	X inch	X mm
<b>KIA Sephia II, 5-dr Hatchback, 98-01</b>	35 <sup>7</sup> / <sub>8</sub> "	911 mm
<b>KIA Sephia II, 4-dr Sedan, 98-01</b>	36"	916 mm
<b>KIA Sephia, 4-dr Sedan, *98-01</b>	36"	916 mm
<b>KIA Shuma, 5-dr Hatchback, 98-04</b>	35 <sup>7</sup> / <sub>8</sub> "	911 mm
<b>KIA Shuma, 4-dr Sedan, 98-04</b>	36"	916 mm
<b>KIA Spectra, 4-dr Sedan, 01-04 / *00-04</b>	36"	916 mm

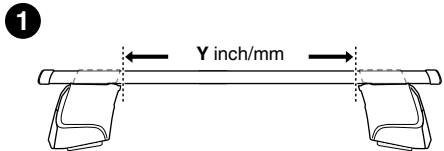
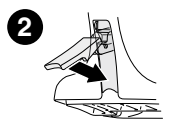

	Y inch	Y mm
<b>KIA Sephia II, 5-dr Hatchback, 98-01</b>	35 <sup>1</sup> / <sub>4</sub> "	896 mm
<b>KIA Sephia II, 4-dr Sedan, 98-01</b>	35 <sup>1</sup> / <sub>2</sub> "	901 mm
<b>KIA Sephia, 4-dr Sedan, *98-01</b>	35 <sup>1</sup> / <sub>2</sub> "	901 mm
<b>KIA Shuma, 5-dr Hatchback, 98-04</b>	35 <sup>1</sup> / <sub>4</sub> "	896 mm
<b>KIA Shuma, 4-dr Sedan, 98-04</b>	35 <sup>1</sup> / <sub>2</sub> "	901 mm
<b>KIA Spectra, 4-dr Sedan, 01-04 / *00-04</b>	35 <sup>1</sup> / <sub>2</sub> "	901 mm

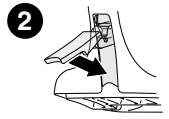

# 4

KIA Sephia II, 5-dr Hatchback, 98-01

KIA Sephia II, 4-dr Sedan, 98-01

KIA Sephia, 4-dr Sedan, \*98-01

KIA Shuma, 5-dr Hatchback, 98-04

KIA Shuma, 4-dr Sedan, 98-04

KIA Spectra, 4-dr Sedan, 01-04 / \*00-04

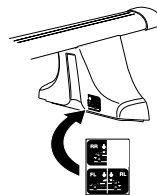
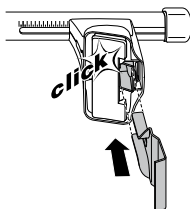
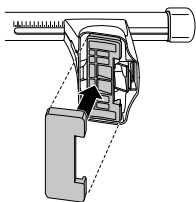
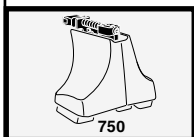
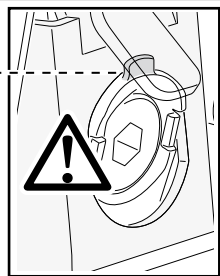
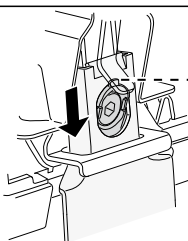
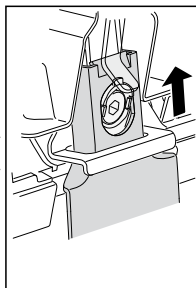
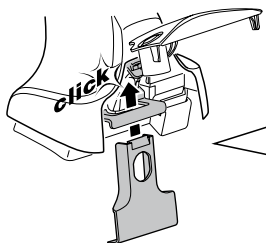
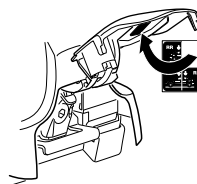
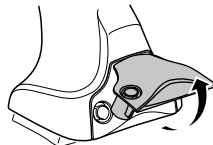
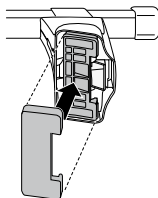
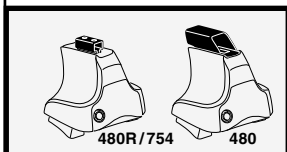
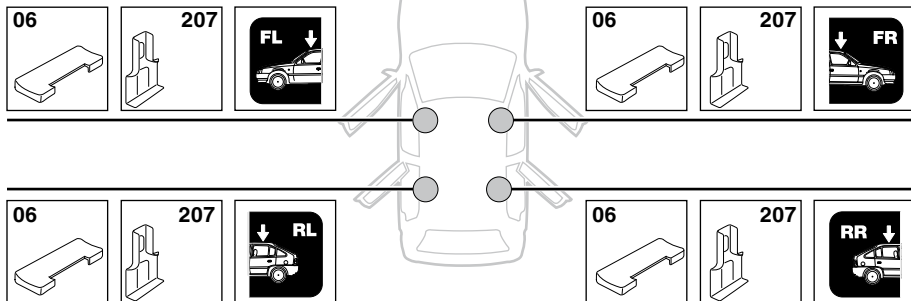

5



	X mm	Y mm	X inch	Y inch
<b>KIA Sephia II, 5-dr Hatchback, 98-01</b>	220 mm	650 mm	8 5/8"	25 5/8"
<b>KIA Sephia II, 4-dr Sedan, 98-01</b>	220 mm	650 mm	8 5/8"	25 5/8"
<b>KIA Sephia, 4-dr Sedan, *98-01</b>	220 mm	650 mm	8 5/8"	25 5/8"
<b>KIA Shuma, 5-dr Hatchback, 98-04</b>	220 mm	650 mm	8 5/8"	25 5/8"
<b>KIA Shuma, 4-dr Sedan, 98-04</b>	220 mm	650 mm	8 5/8"	25 5/8"
<b>KIA Spectra, 4-dr Sedan, 01-04 / *00-04</b>	220 mm	650 mm	8 5/8"	25 5/8"

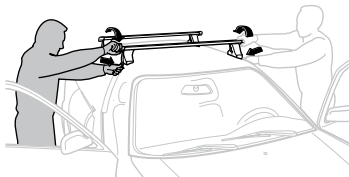
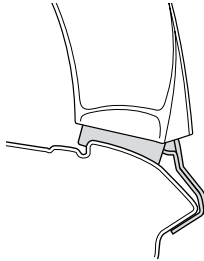
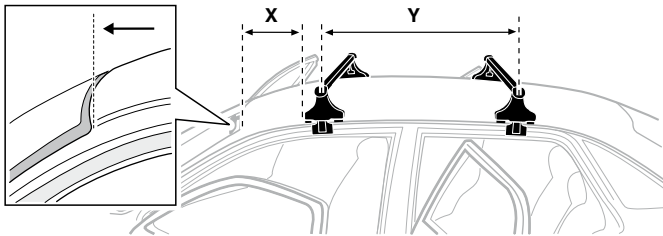

**GB/US** Tighten alternately

**D** Die Schrauben abwechselnd anziehen

**F** Serrer alternativement chaque côté

**NL** Afwisselend aan de linker- en de rechterkant aandraaien

**I** Alternare il serraggio delle viti

**E** Apertar alternativamente

**PT** Aperte alternadamente

**S** Dra åt växelvis

**FIN** Kierrä vuorotellen

**EST** Pinguldage vaheldumisi

**LAT** Pielieciet pamišus

**LIT** Užsukinėkite pakaitomis

**PL** Śruby dokręcaj naprzemiennie

**RU** Затягивайте попеременно

**CZ** Pokręťta bagažníka dokręcaj dokręcaj naprzemiennie.

**SK** Doťahujte striedavo

**SLO** Privijajte izmenično.

**HR** Naizmjenično zategnite

**HU** Egymástól függetlenül szorítandó

**GR** Σφιγγετε εναλλάξ

**TR** Dönüşümlü sıkın

**中文** 交替拧紧

**한국어** 번갈아 가며 조이십시오.

**日本語** 交互に締め付けてください。

**ไทย** ชั้นโนแบบสลับ

6



480R/754



480

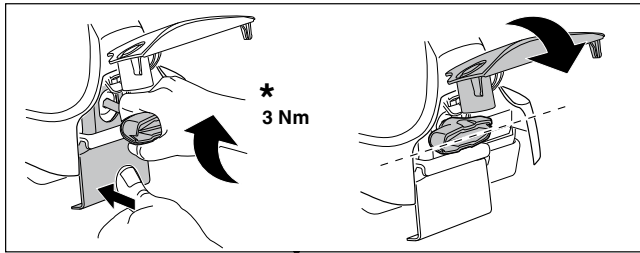

\*  
3 Nm



\*



\*  
≈ 3 Nm

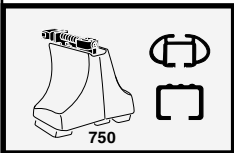
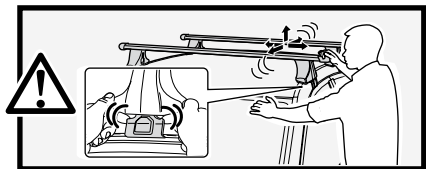

750

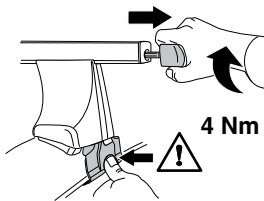

4 Nm

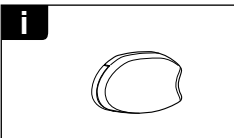
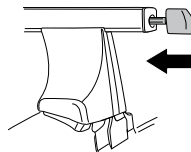

i

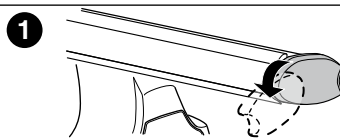

1

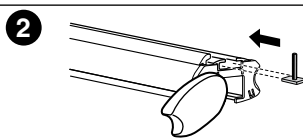

2

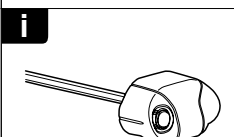

i

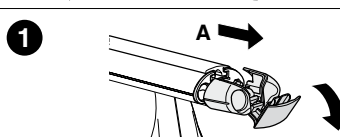

1

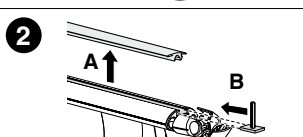

2

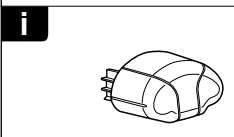

i

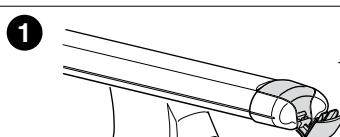

1

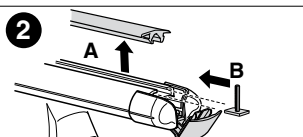

2

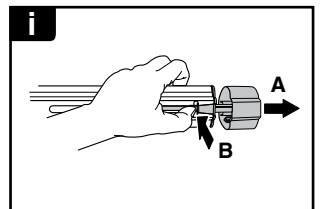
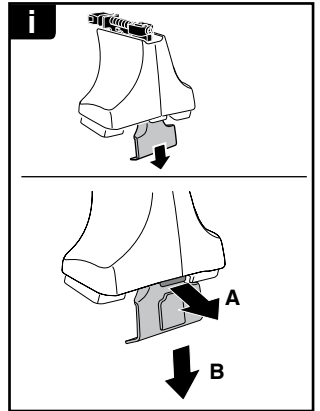

**THULE**  
SWEDEN  
**ONE  
KEY  
SYSTEM**

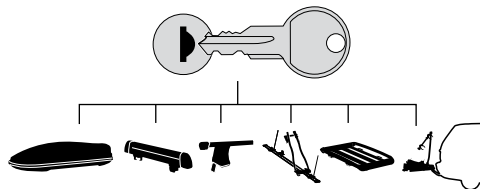

- 544 (x4)
- 596 (x6)
- 588 (x8)
- NA 510 (x10)
- EUR 452 (x12)
- ASIA

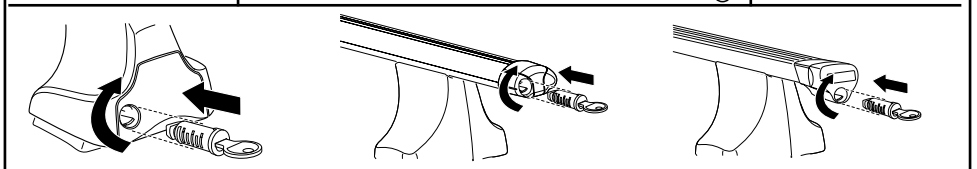

WW ▶ Thule Sweden AB, Box 69, 330 33 Hillerstorp, SWEDEN  
NA ▶ Thule Inc., 42 Silvermine Road, Seymour, Connecticut 06483, USA

info@thule.com  
customer.service@thule.com

www.thule.com