

Kit 1171

JAGUAR S-type, 4-dr Sedan, 99-03, 04-08 / *00-03, 04-08

***North America**

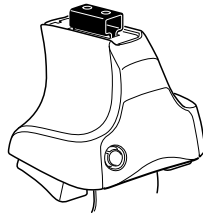

754 Rapid System
480R Rapid Traverse (North America)

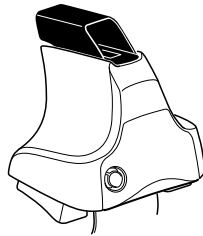

480 Traverse (North America)

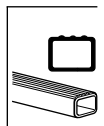

Max.
75 kg
Max.
165 lbs

x1

x4

754 Rapid System

x4

480R Rapid Traverse (North America)

x4

754 Rapid System
480R Rapid Traverse (North America)

x1

x4

x4

480 Traverse (North America)

x2

x2

23 mm

x1

17 mm

x2

23 mm

x2

x4

x4

x2

x2

x2

(North America)

331

x4

06

x2

18

x2

x4

x4

x1

1

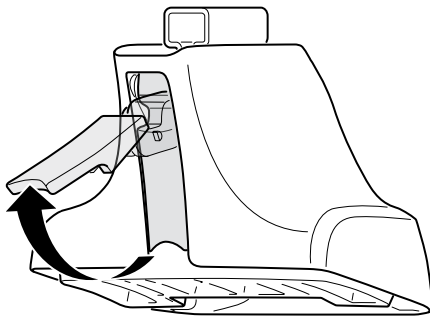

2



754 Rapid System
480R Rapid Traverse
(North America)

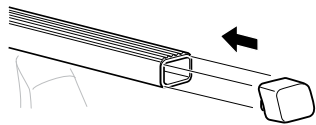
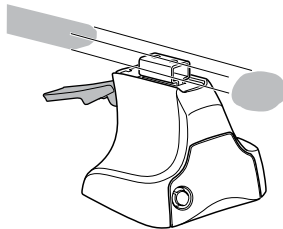

x4

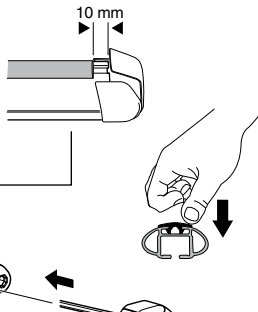

x4

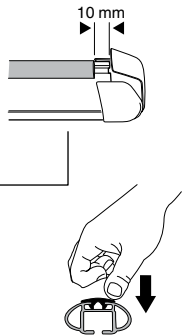
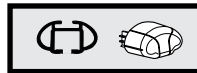

x4



480 Traverse
(North America)

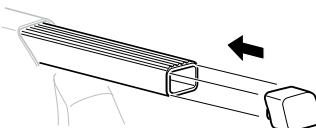
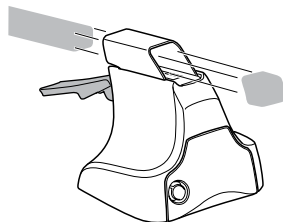

x4

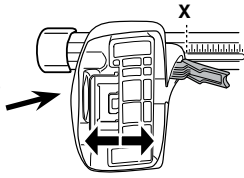
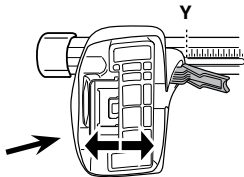
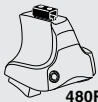
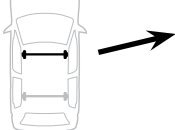
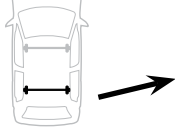
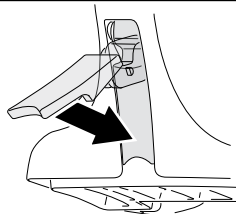
3**754** Rapid System**X****JAGUAR S-type, 4-dr Sedan, 99-03, 04-08 / *00-03, 04-08****31****Y****JAGUAR S-type, 4-dr Sedan, 99-03, 04-08 / *00-03, 04-08****34,5****3****480R** Rapid Traverse**480** Traverse**(North America)****X inch****X mm****JAGUAR S-type, 4-dr Sedan, 99-03, 04-08 / *00-03, 04-08****37 7/8"****961 mm****Y inch****Y mm****JAGUAR S-type, 4-dr Sedan, 99-03, 04-08 / *00-03, 04-08****39 1/4"****996 mm****4**

5

JAGUAR S-type, 4-dr Sedan, 99-03, 04-08 / *00-03, 04-08

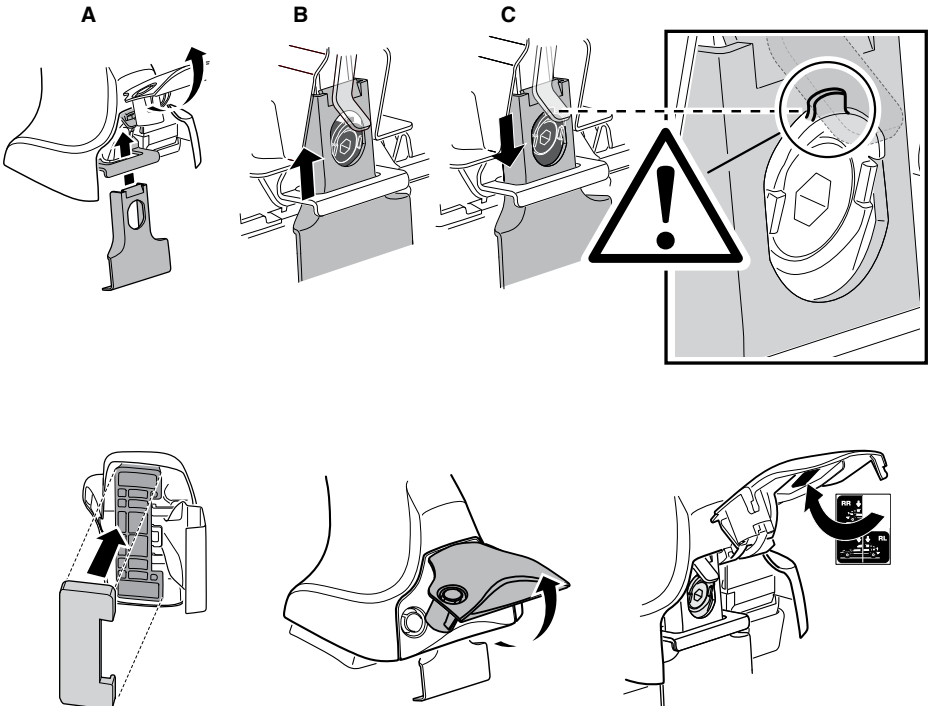
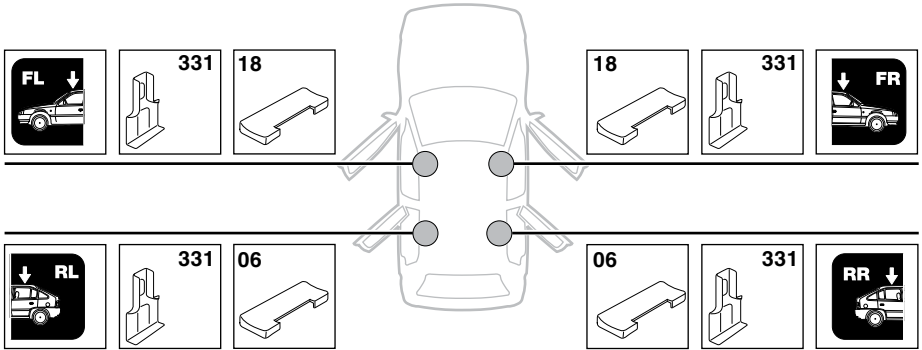

6

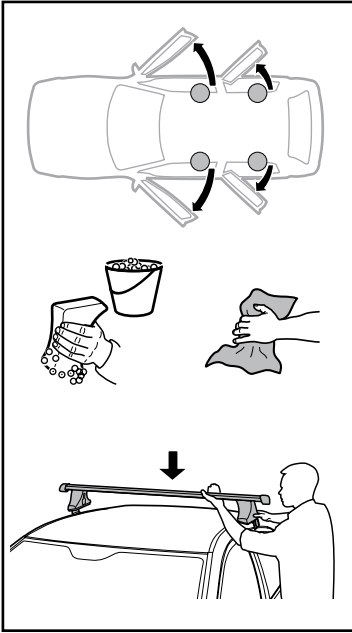

i

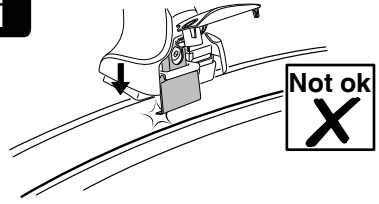

A

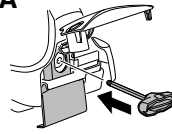

B

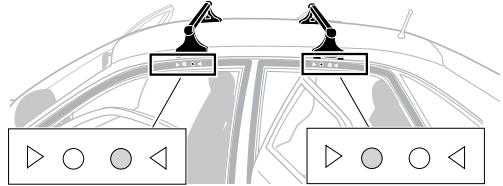
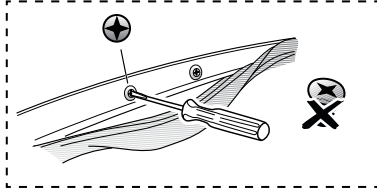
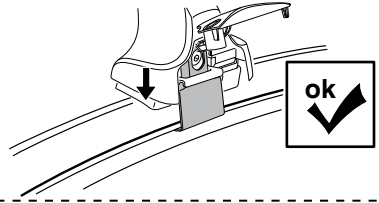
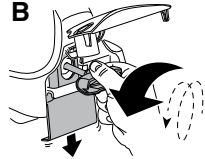

x4 x4

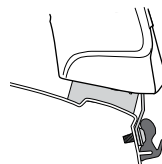
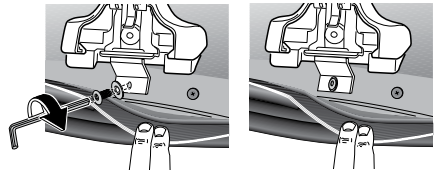
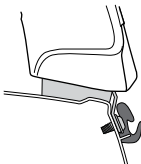
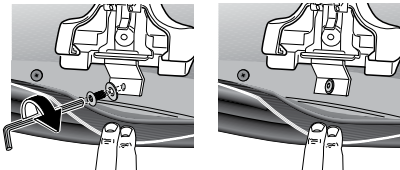
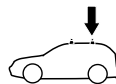
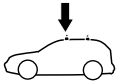

7



GB/US	Tighten alternately
D	Die Schrauben abwechselnd anziehen
F	Serrer alternativement chaque côté
NL	Afwisselend aan de linker- en de rechterkant aandraaien
I	Alternare il serraggio delle viti
E	Apertar alternativamente
PT	Aperte alternadamente
S	Dra åt växelvis
FIN	Kierrä vuorotellen
EST	Pinguldage vaheldumisi
LAT	Pielveiciet pamišus
LIT	Užsukinėkite pakaitomis
PL	Śruby dokręcaj naprzemiennie
RU	Загрягивайте попеременно

CZ	Pokręřta bagažníka dokręřcaj dokręřcaj naprzemiennie.
SK	Dofahajte striedavo
SLO	Privijajte izmenično.
HR	Naizmjenočno zategnite
HU	Egymástól függetlenül szorítandó
GR	Σφιγίγτες εναλλάξ
TR	Dönüşümlü sıkın

中文 交替拧紧

한국어 번갈아 가며 조이십시오.

日本語 交互に締め付けてください。

ไทย ชั้นในแบบสลับ

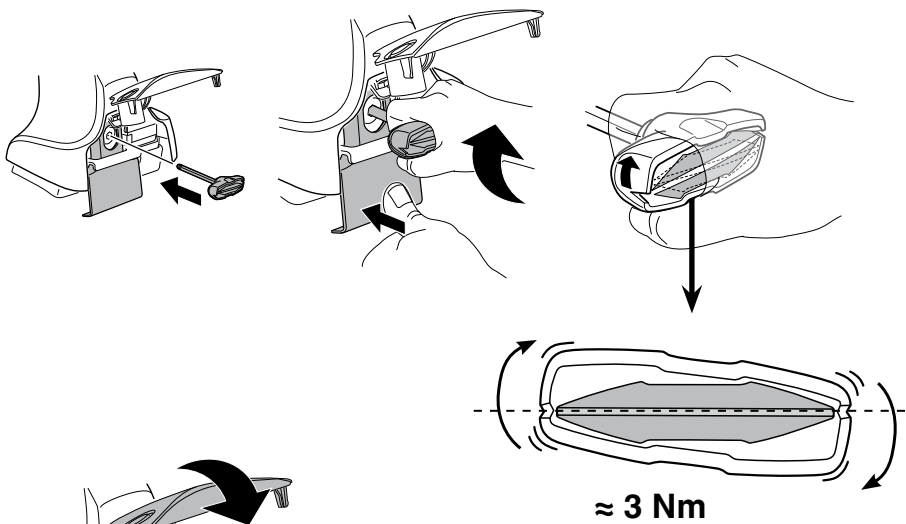

8



x1
17 mm

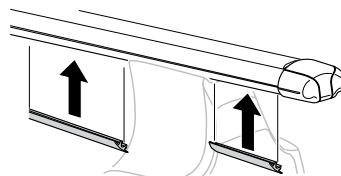
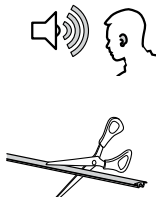



THULE
SWEDEN
**ONE
KEY
SYSTEM**



- 544 (x4)
 - 596 (x6)
 - 588 (x8)
 - 510 (x10)
 - 452 (x12)
- NA
EUR
ASIA

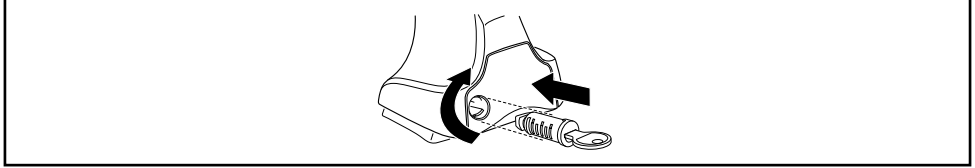

WW ▶ Thule Sweden AB, Box 69, 330 33 Hillerstorp, SWEDEN
NA ▶ Thule Inc., 42 Silvermine Road, Seymour, Connecticut 06483, USA

info@thule.com
customer.service@thule.com

www.thule.com