

# Kit 1095

BMW 3-series, 4-dr Sedan, 98-01, 02-04 / \*99-02, 03-05

\*North America

480R  
754

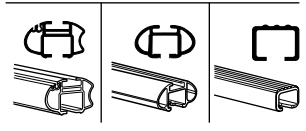
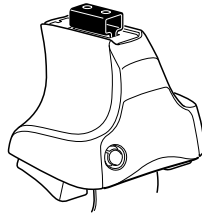

480

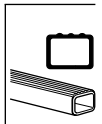
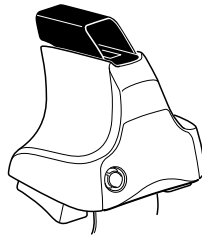

750

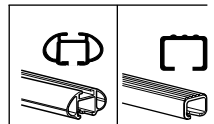
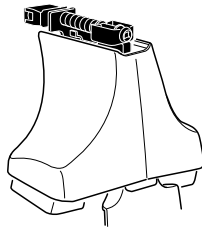

**Kit**

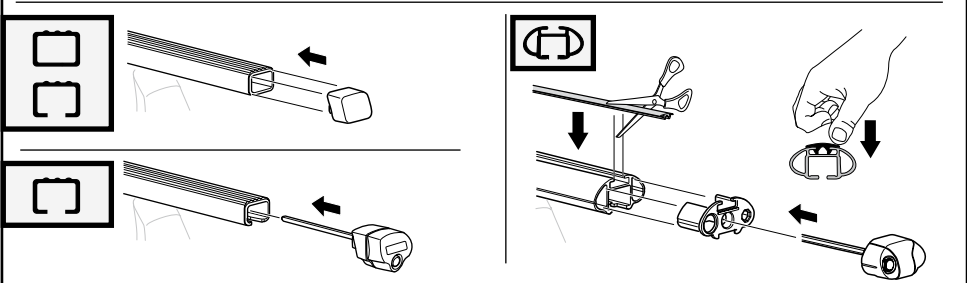
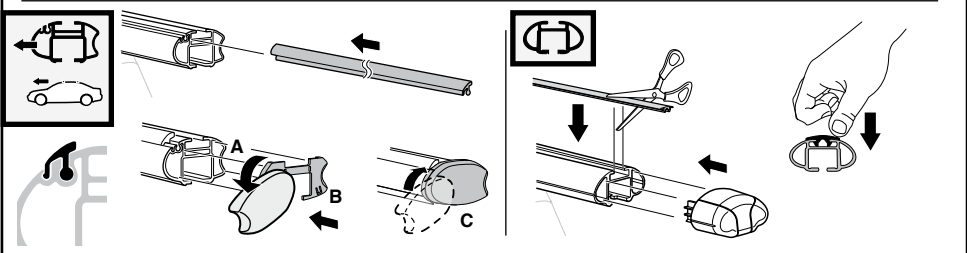
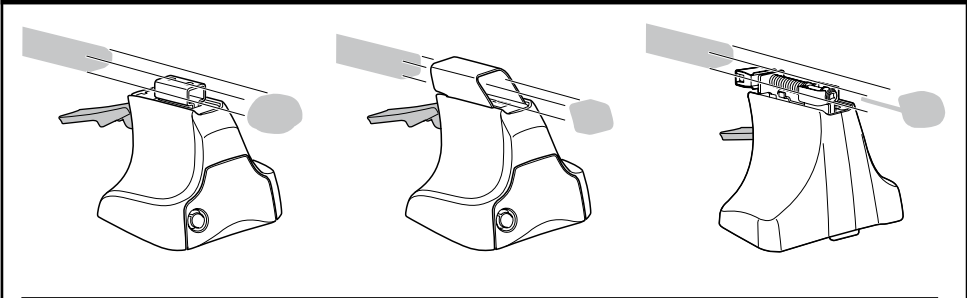
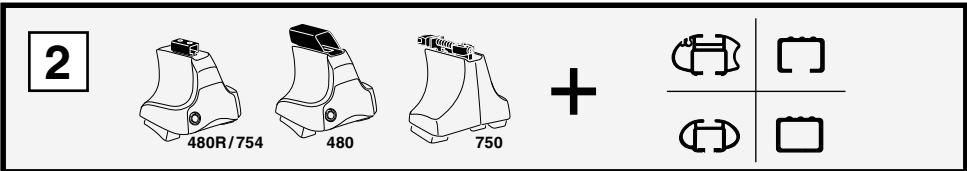
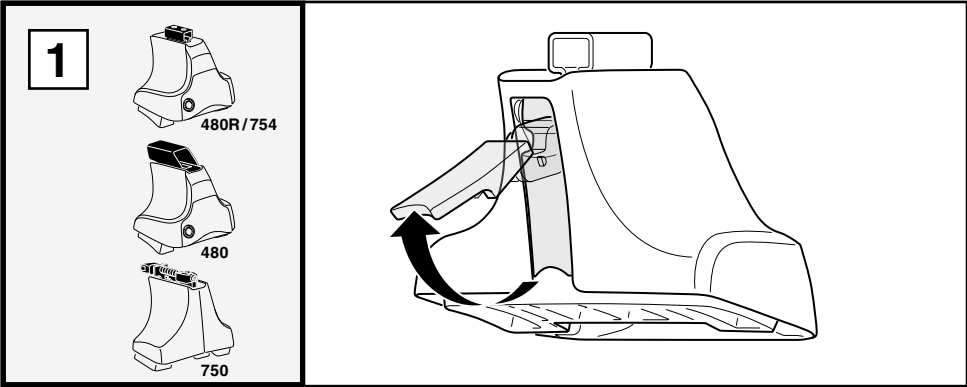

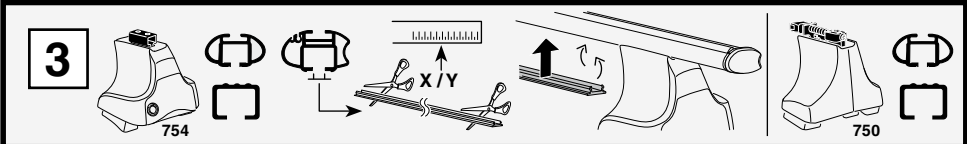

**1**

**2**

|  | X                  |
|--|--------------------|
| <p><b>1</b></p>  | <p><b>2</b></p>    |
| <p><b>BMW 3-series, 4-dr Sedan, 98-01, 02-04 / *99-02, 03-05</b></p> | <p><b>31,5</b></p> |

|  | Y                  |
|--|--------------------|
| <p><b>1</b></p>  | <p><b>2</b></p>    |
| <p><b>BMW 3-series, 4-dr Sedan, 98-01, 02-04 / *99-02, 03-05</b></p> | <p><b>29,5</b></p> |

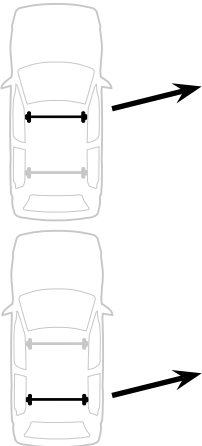
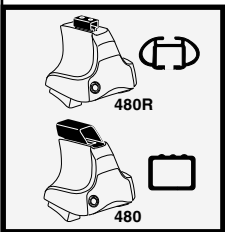

**1**

**2**

|  | X inch            | X mm                    |
|--|-------------------|-------------------------|
| <p><b>1</b></p>  | <p><b>2</b></p>   | <p><b>X inch/mm</b></p> |
| <p><b>BMW 3-series, 4-dr Sedan, 98-01, 02-04 / *99-02, 03-05</b></p> | <p><b>38"</b></p> | <p><b>966 mm</b></p>    |

|  | Y inch                | Y mm                    |
|--|-----------------------|-------------------------|
| <p><b>1</b></p>  | <p><b>2</b></p>       | <p><b>Y inch/mm</b></p> |
| <p><b>BMW 3-series, 4-dr Sedan, 98-01, 02-04 / *99-02, 03-05</b></p> | <p><b>37 1/4"</b></p> | <p><b>946 mm</b></p>    |

# 4

BMW 3-series, 4-dr Sedan, 98-01, 02-04 / \*99-02, 03-05

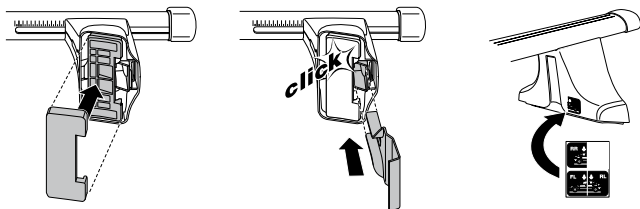
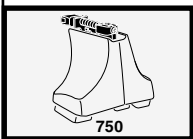
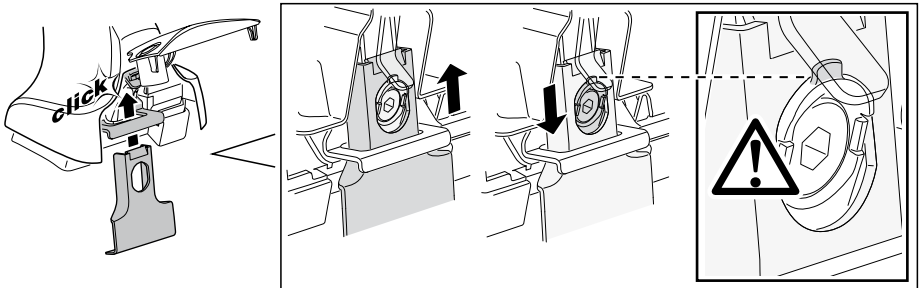
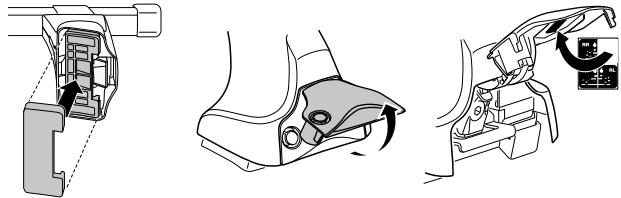
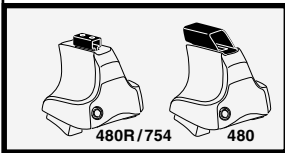
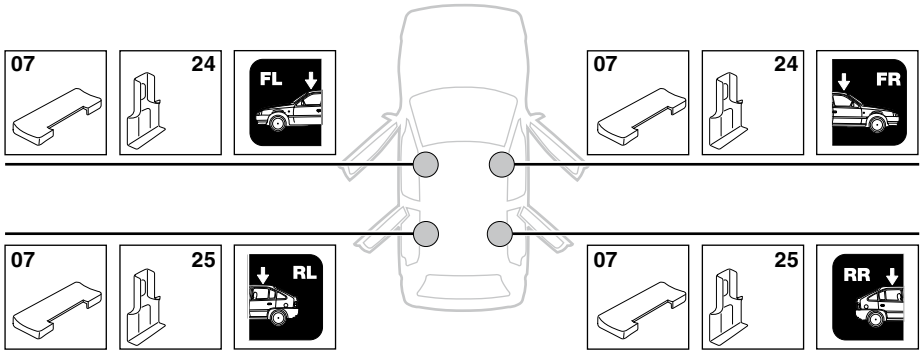

5

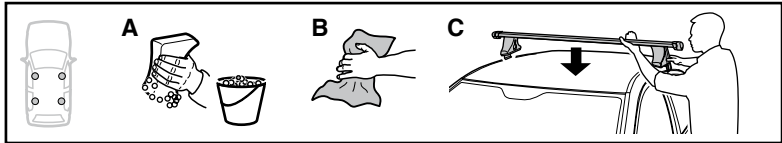

|  | X mm   | Y mm   | X inch | Y inch  |
|--|--------|--------|--------|---------|
| BMW 3-series, 4-dr Sedan, 98-01, 02-04 / *99-02, 03-05 | 180 mm | 700 mm | 7 1/8" | 27 1/2" |

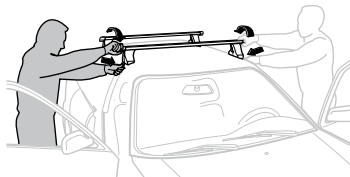
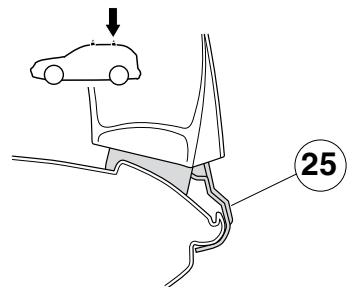
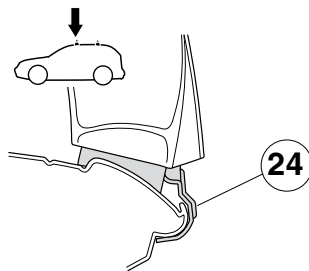
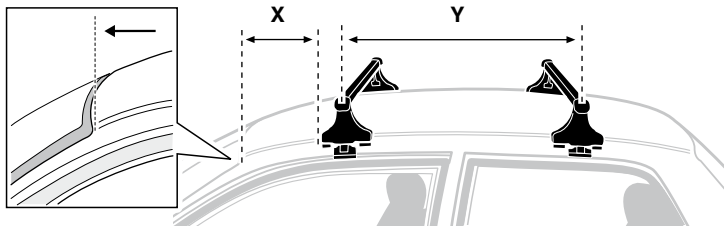

**GB/US** Tighten alternately

**D** Die Schrauben abwechselnd anziehen

**F** Serrer alternativement chaque côté

**NL** Afwisselend aan de linker- en de rechterkant aandraaien

**I** Alternare il serraggio delle viti

**E** Serrare alternativamente

**PT** Aperte alternadamente

**S** Dra åt växelvis

**FIN** Kierrä vuorotellen

**EST** Pinguldage vaheldumisi

**LAT** Pielieciet pamišus

**LIT** Užsukinėkite pakaitomis

**PL** Śruby dokręcaj naprzemiennie

**RU** Затягивайте попеременно

**CZ** Pokręťta bagażníka dokręcaj dokręcaj naprzemiennie.

**SK** Doťahujte striedavo

**SLO** Privijajte izmenično.

**HR** Naizmjenično zategnite

**HU** Egymástól függetlenül szorítandó

**GR** Σφιγγετε εναλλάξ

**TR** Dönüşümlü sıkın

**中文** 交替拧紧

**한국어** 번갈아 가며 조이십시오.

**日本語** 交互に締め付けてください。

**ไทย** ชันโนแบบสลับ

6



480R/754



480

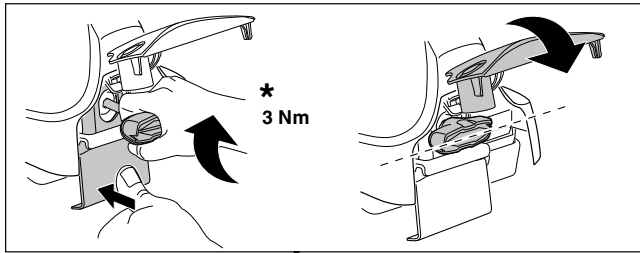
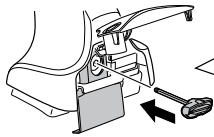

\*  
3 Nm

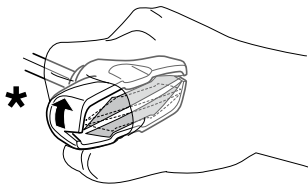

\*

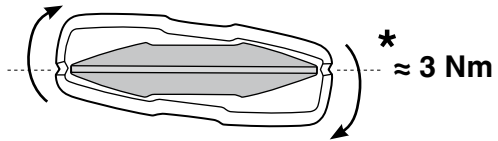

\*  
≈ 3 Nm

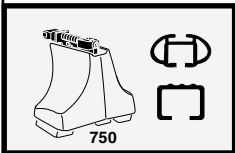
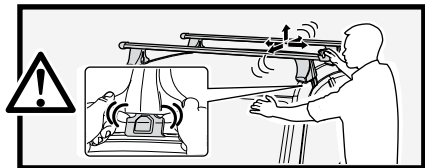

750

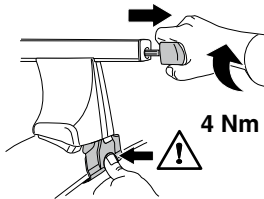

4 Nm

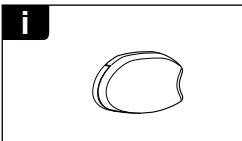
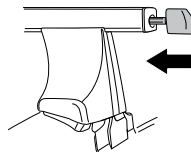

i

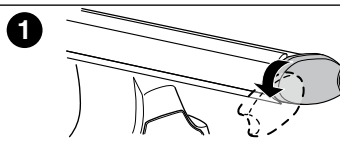

1

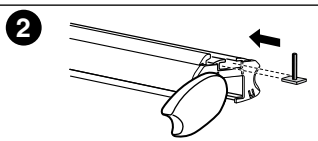

2

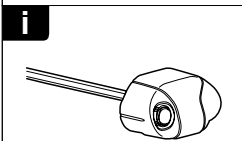

i

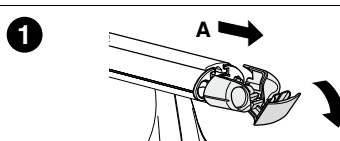

1

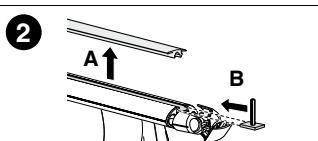

2

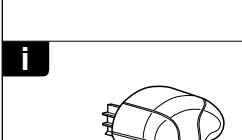

i

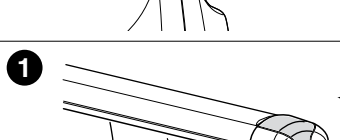

1

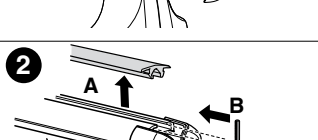

2

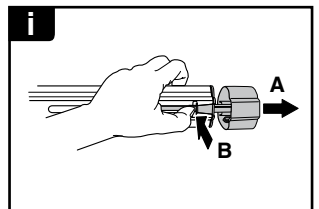
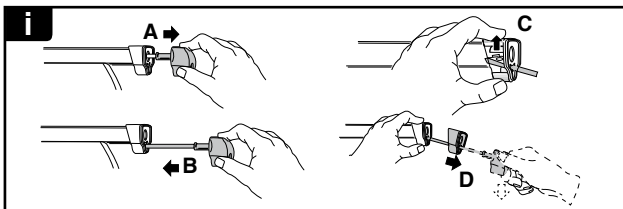
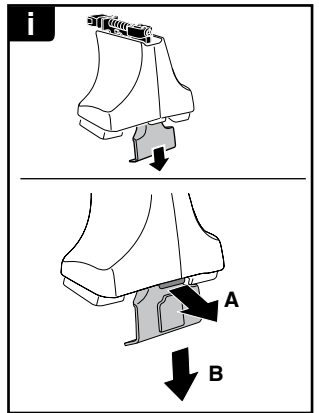
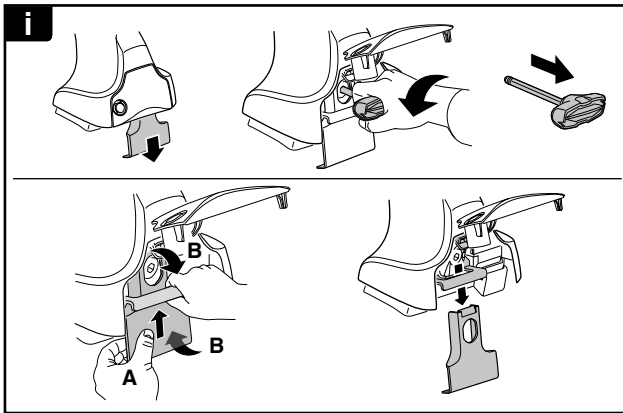
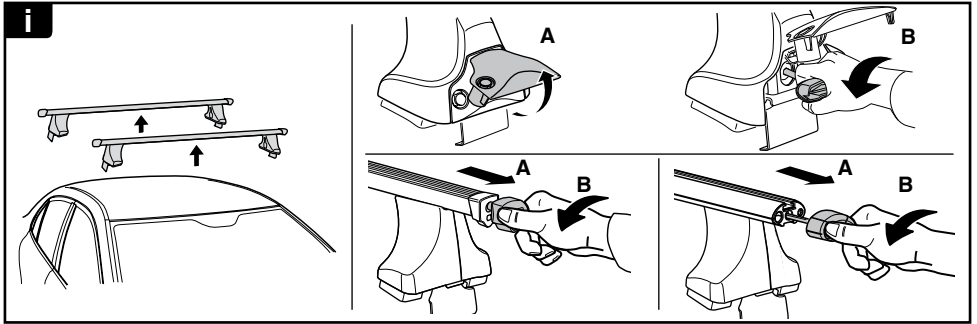

**THULE**  
SWEDEN  
**ONE  
KEY  
SYSTEM**

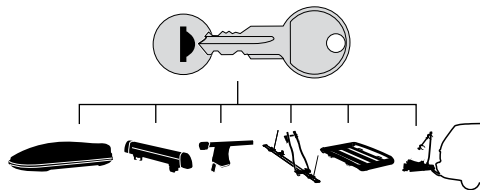

|      |  |       |
|------|--|-------|
|      |  | (x4)  |
|      |  | (x6)  |
|      |  | (x8)  |
| NA   |  | (x10) |
| EUR  |  | (x12) |
| ASIA |  | (x12) |

