

Kit 1039

AUDI A6, 4-dr Sedan, 97-00, 01-03 / *98-04

AUDI S6, 4-dr Sedan, 99-03 / *98-04

AUDI A6 Avant, 5-dr Estate, 98-04

AUDI A6, 5-dr Wagon, *99-05

*North America

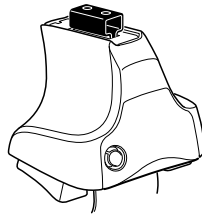

754 Rapid System
480R Rapid Traverse (North America)

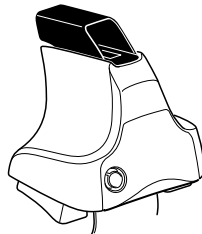
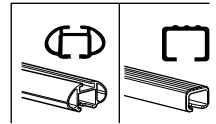

480 Traverse (North America)

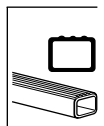

1

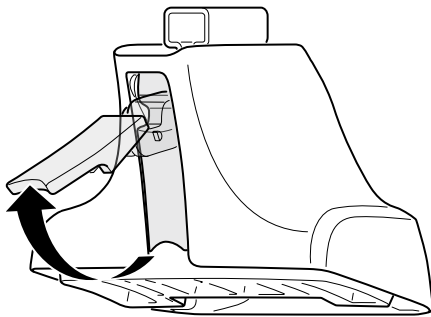

2



754 Rapid System
480R Rapid Traverse
(North America)

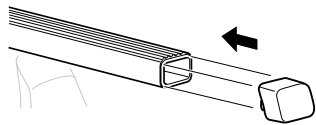
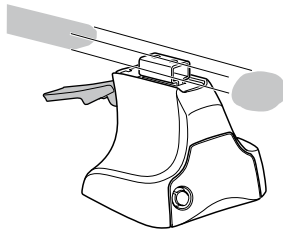

x4

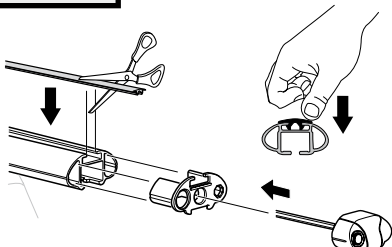

x4

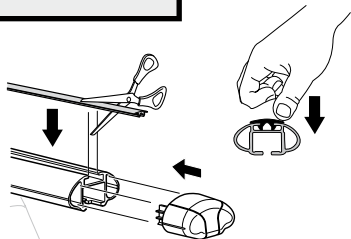
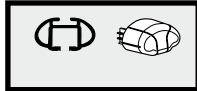

x4



480 Traverse
(North America)

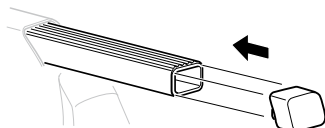
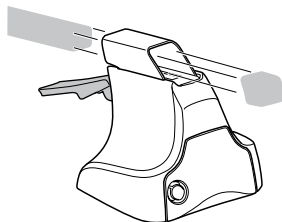

x4

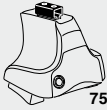
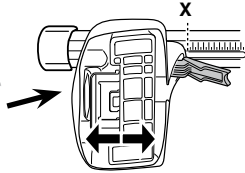
3**754** Rapid System

	X
AUDI A6 , 4-dr Sedan, 97-00, 01-03 / *98-04	34,5
AUDI S6 , 4-dr Sedan, 99-03 / *98-04	34,5
AUDI A6 Avant , 5-dr Estate, 98-04	34
AUDI A6 , 5-dr Wagon, *99-05	34

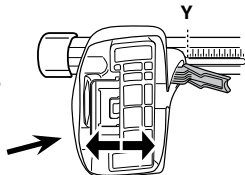

	Y
AUDI A6 , 4-dr Sedan, 97-00, 01-03 / *98-04	34,5
AUDI S6 , 4-dr Sedan, 99-03 / *98-04	34,5
AUDI A6 Avant , 5-dr Estate, 98-04	32
AUDI A6 , 5-dr Wagon, *99-05	32

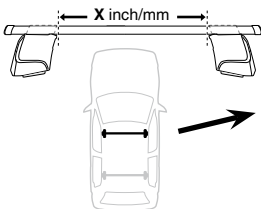
3**480R** Rapid Traverse**480** Traverse**(North America)**

	X inch	X mm
AUDI A6 , 4-dr Sedan, 97-00, 01-03 / *98-04	39 1/4"	996 mm
AUDI S6 , 4-dr Sedan, 99-03 / *98-04	39 1/4"	996 mm
AUDI A6 Avant , 5-dr Estate, 98-04	39"	991 mm
AUDI A6 , 5-dr Wagon, *99-05	39"	991 mm

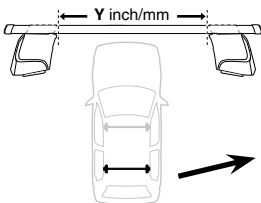

	Y inch	Y mm
AUDI A6 , 4-dr Sedan, 97-00, 01-03 / *98-04	39 1/4"	996 mm
AUDI S6 , 4-dr Sedan, 99-03 / *98-04	39 1/4"	996 mm
AUDI A6 Avant , 5-dr Estate, 98-04	38 1/4"	971 mm
AUDI A6 , 5-dr Wagon, *99-05	38 1/4"	971 mm

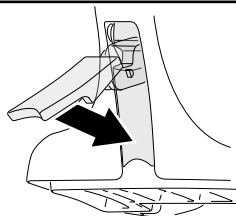
4

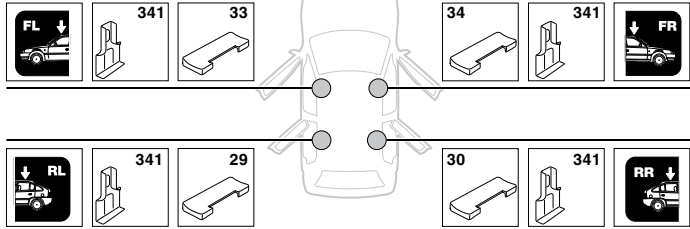
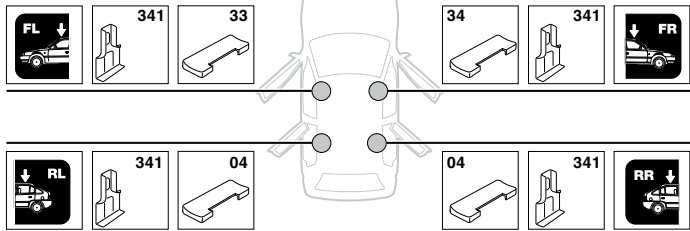
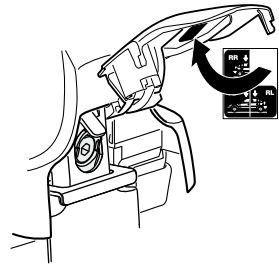
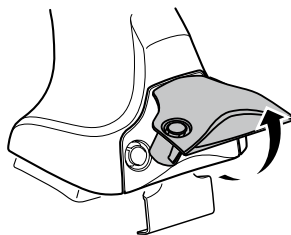
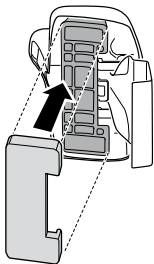
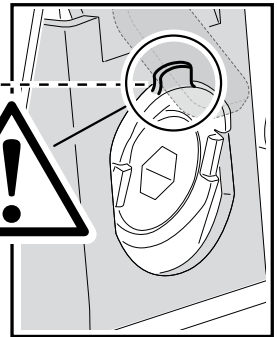
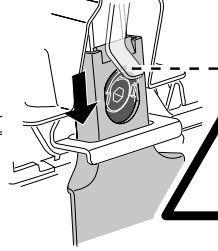
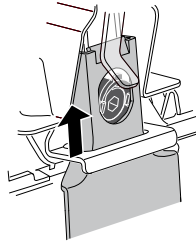
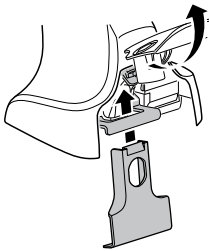
5**AUDI A6, 4-dr Sedan, 97-00, 01-03 / *98-04****AUDI S6, 4-dr Sedan, 99-03 / *98-04****AUDI A6 Avant, 5-dr Estate, 98-04****AUDI A6, 5-dr Wagon, *99-05****A****B****C**

6

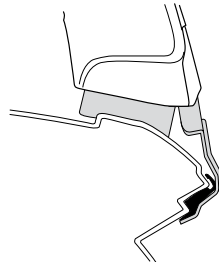
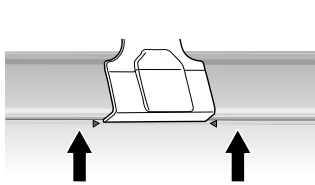
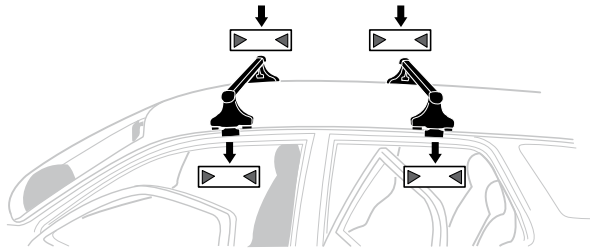
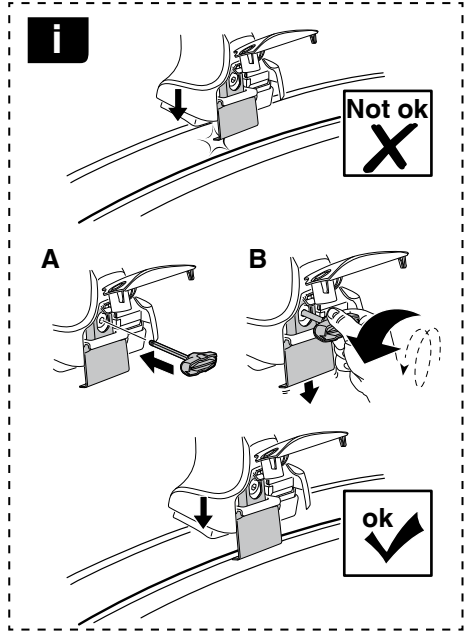
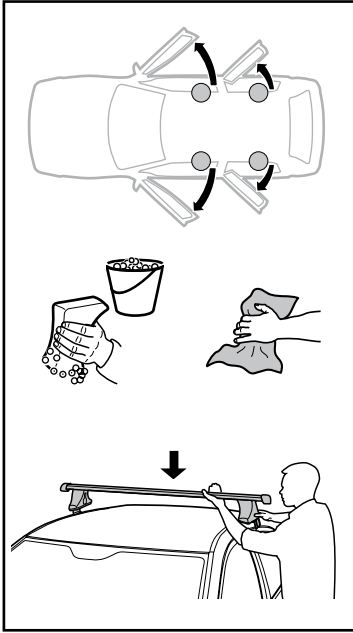

7

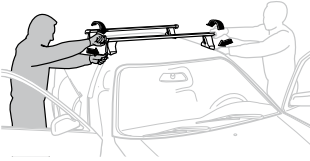

GB/US Tighten alternately
D Die Schrauben abwechselnd anziehen
F Serrer alternativement chaque côté
NL Afwisselend aan de linker- en de rechterkant aandraaien
I Alternare il serraggio delle viti
E Apertar alternativamente
PT Aperte alternadamente
S Dra åt växelvis
FIN Kierrä vuorotellen
EST Pinguldage vaheldumisi
LAT Pievelciēt pamišus
LIT Užsukinėkite pakaitomis
PL Śruby dokręcaj naprzemiennie
RU Затягивайте попеременно

CZ Pokrétla bagazníka dokręcaj dokręcaj naprzemiennie.
SK Doťahujte striedavo
SLO Privijajte izmenično.
HR Naizmjenično zategnite
HU Egymástól függetlenül szorítandó
GR Σφιγγεται εναλλάξ
TR Dönüşümlü sıkın

中文 交替拧紧

한국어 번갈아 가며 조이십시오.

日本語 交互に締め付けてください。

ไทย ชั้้นในแบบสลับ

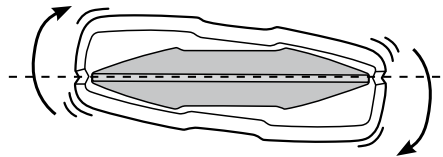
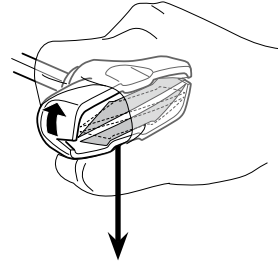
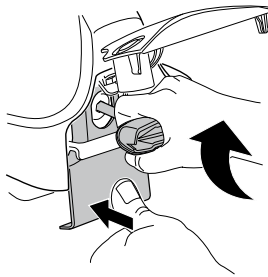
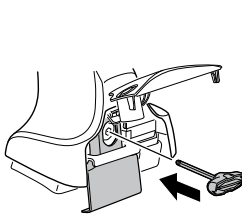

≈ 3 Nm

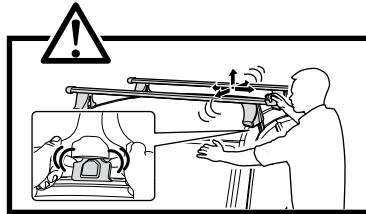
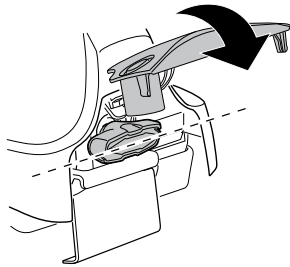

8



x1
17 mm

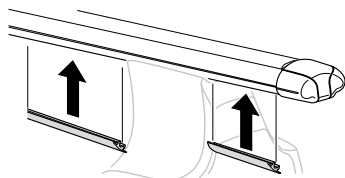

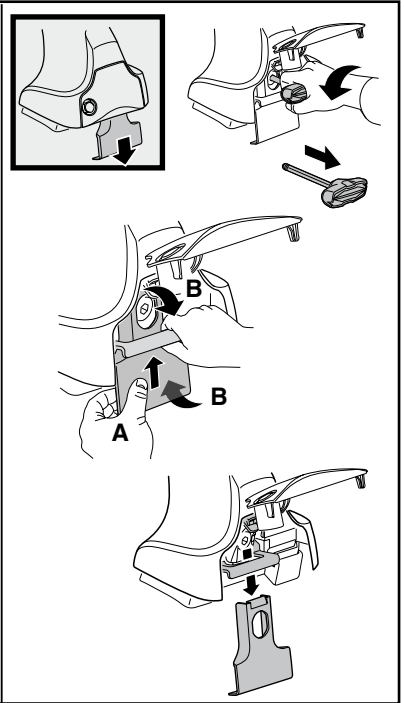
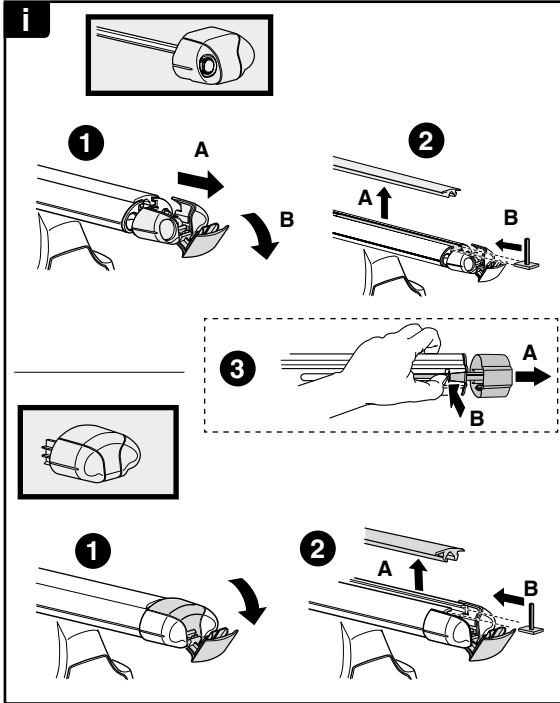

THULE
SWEDEN
**ONE
KEY
SYSTEM**

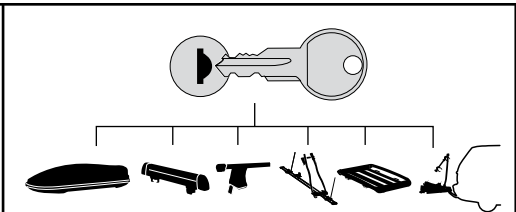

		(x4)
		(x6)
		(x8)
NA		(x10)
EUR		(x12)
ASIA		



WW ▶ Thule Sweden AB, Box 69, 330 33 Hillerstorp, SWEDEN
NA ▶ Thule Inc., 42 Silvermine Road, Seymour, Connecticut 06483, USA

info@thule.com
customer.service@thule.com

www.thule.com