

Kit 1011

VOLVO 850, 4-dr Sedan, 92-96 / *93-97

VOLVO 850, 5-dr Estate, 93-96

VOLVO 850, 5-dr Wagon, *94-97

VOLVO S70, 4-dr Sedan, 97-00 / *98-00

VOLVO V70, 5-dr Estate, 97-99

VOLVO V70, 5-dr Wagon, *98-00

*North America

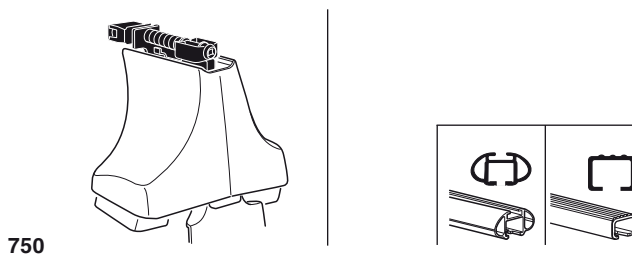
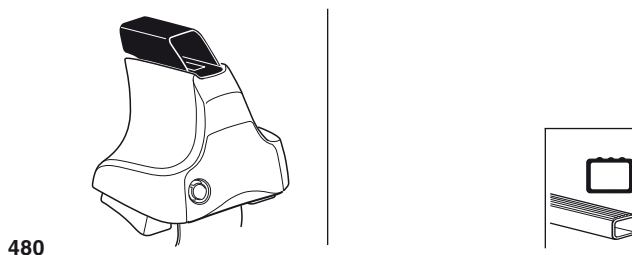
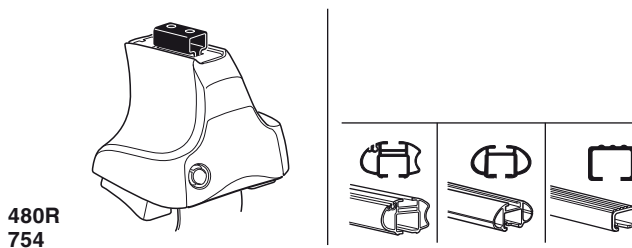

THULE[®]
SWEDEN



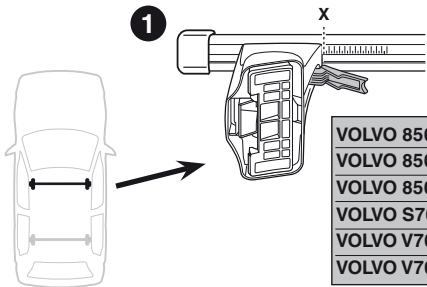
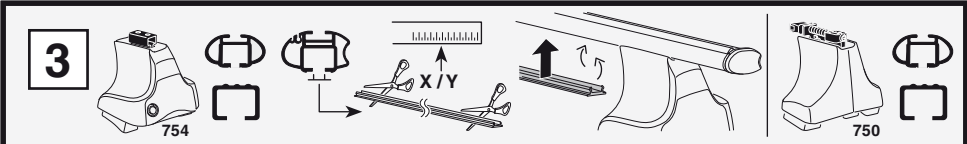

	X
VOLVO 850, 4-dr Sedan, 92-96 / *93-97	47,5
VOLVO 850, 5-dr Estate, 93-96	46,5
VOLVO 850, 5-dr Wagon, *94-97	46,5
VOLVO S70, 4-dr Sedan, 97-00 / *98-00	47,5
VOLVO V70, 5-dr Estate, 97-99	46,5
VOLVO V70, 5-dr Wagon, *98-00	46,5

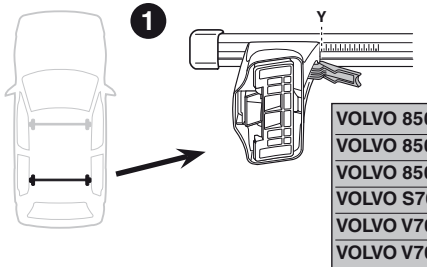
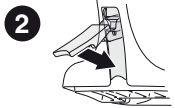

	Y
VOLVO 850, 4-dr Sedan, 92-96 / *93-97	41,5
VOLVO 850, 5-dr Estate, 93-96	42
VOLVO 850, 5-dr Wagon, *94-97	42
VOLVO S70, 4-dr Sedan, 97-00 / *98-00	41,5
VOLVO V70, 5-dr Estate, 97-99	42
VOLVO V70, 5-dr Wagon, *98-00	42

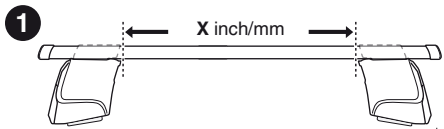
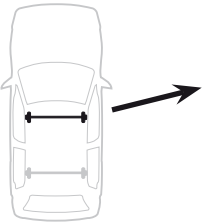
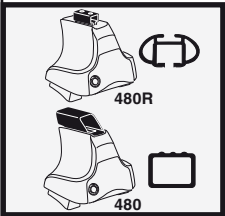

	X inch	X mm
VOLVO 850, 4-dr Sedan, 92-96 / *93-97	44 ³/₈ "	1126 mm
VOLVO 850, 5-dr Estate, 93-96	43 ⁷/₈ "	1116 mm
VOLVO 850, 5-dr Wagon, *94-97	43 ⁷/₈ "	1116 mm
VOLVO S70, 4-dr Sedan, 97-00 / *98-00	44 ³/₈ "	1126 mm
VOLVO V70, 5-dr Estate, 97-99	43 ⁷/₈ "	1116 mm
VOLVO V70, 5-dr Wagon, *98-00	43 ⁷/₈ "	1116 mm

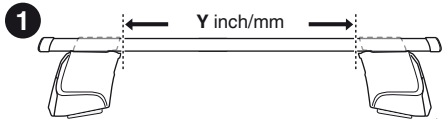
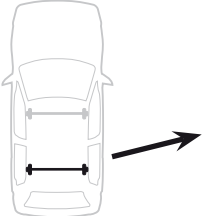
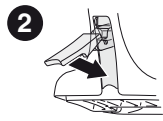

	Y inch	Y mm
VOLVO 850, 4-dr Sedan, 92-96 / *93-97	42 "	1066 mm
VOLVO 850, 5-dr Estate, 93-96	42 ¹/₈ "	1071 mm
VOLVO 850, 5-dr Wagon, *94-97	42 ¹/₈ "	1071 mm
VOLVO S70, 4-dr Sedan, 97-00 / *98-00	42 "	1066 mm
VOLVO V70, 5-dr Estate, 97-99	42 ¹/₈ "	1071 mm
VOLVO V70, 5-dr Wagon, *98-00	42 ¹/₈ "	1071 mm



4

VOLVO 850, 4-dr Sedan, 92-96 / *93-97
VOLVO 850, 5-dr Estate, 93-96
VOLVO 850, 5-dr Wagon, *94-97
VOLVO S70, 4-dr Sedan, 97-00 / *98-00
VOLVO V70, 5-dr Estate, 97-99
VOLVO V70, 5-dr Wagon, *98-00

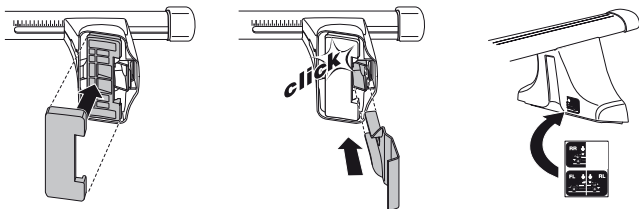
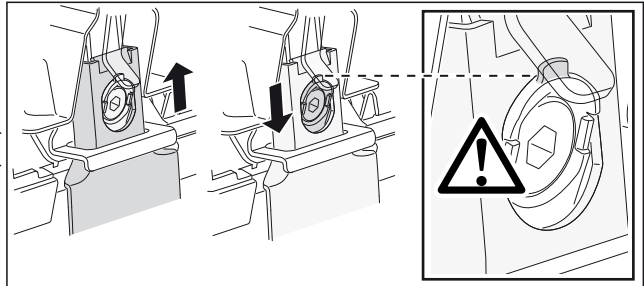
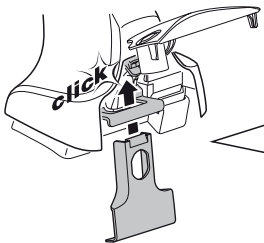
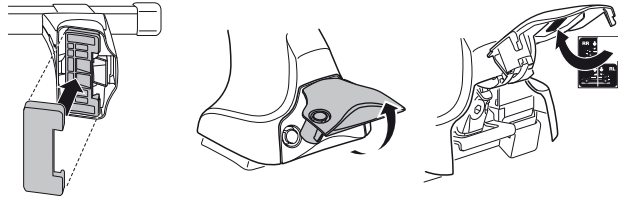
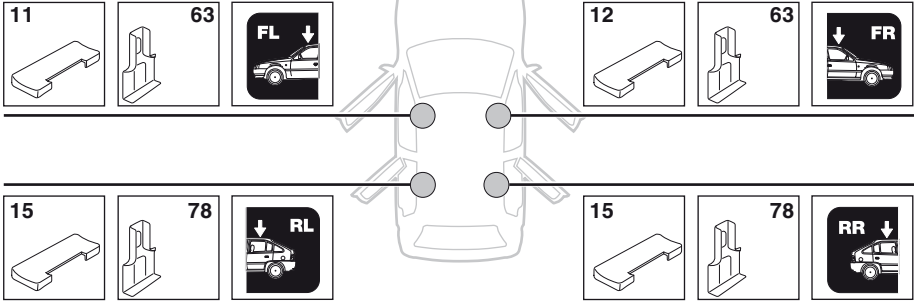

5

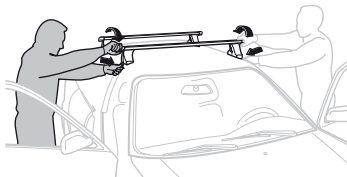
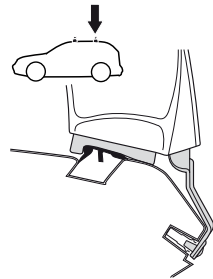
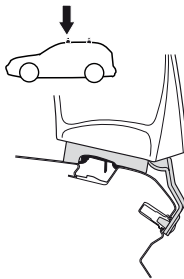
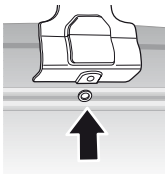
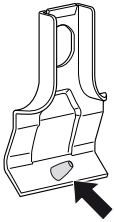

GB/US Tighten alternately

D Die Schrauben abwechselnd anziehen

F Serrer alternativement chaque côté

NL Afwisselend aan de linker- en de rechterkant aandraaien

I Alternare il serraggio delle viti

E Serrare alternativamente

PT Aperte alternadamente

S Dra åt växelvis

FIN Kierrä vuorotellen

EST Pinguldage vaheldumisi

LAT Pielieciet pamišus

LIT Užsukinėkite pakaitomis

PL Śruby dokręcaj naprzemiennie

RU Затягивайте попеременно

CZ Pokręťta bagažníka dokręcaj dokręcaj naprzemiennie.

SK Doťahujte striedavo

SLO Privijajte izmenično.

HR Naizmjenično zategnite

HU Egymástól függetlenül szorítandó

GR Σφιγγετε εναλλάξ

TR Dönüşümlü sıkın

中文 交替拧紧

한국어 번갈아 가며 조이십시오.

日本語 交互に締め付けてください。

ไทย ชันโนแบบสลับ

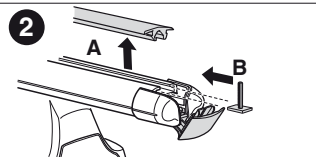
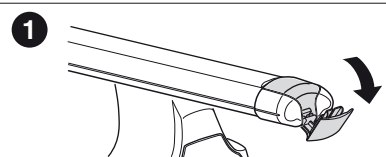
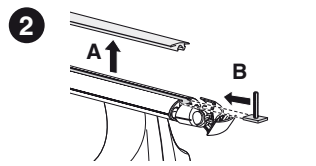
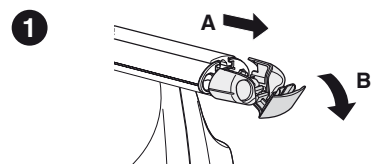
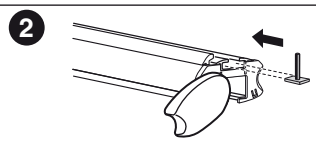
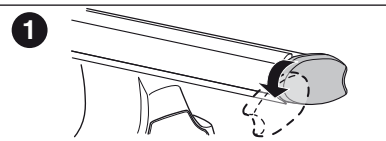
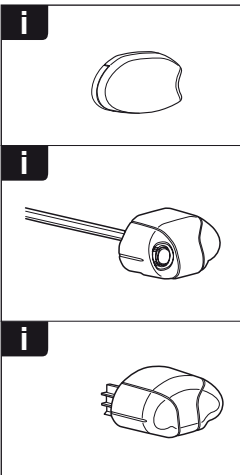
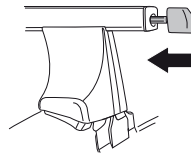
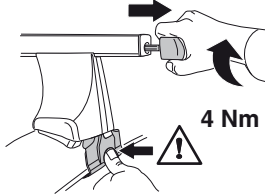
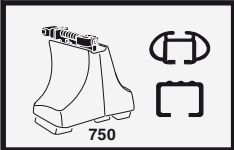
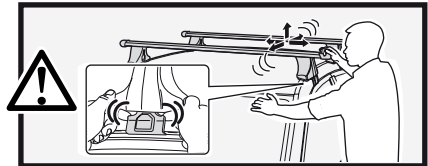
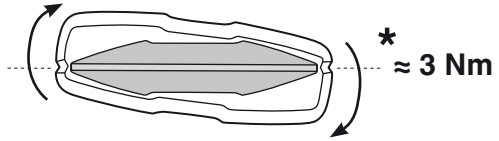
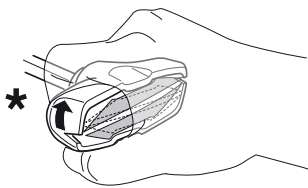
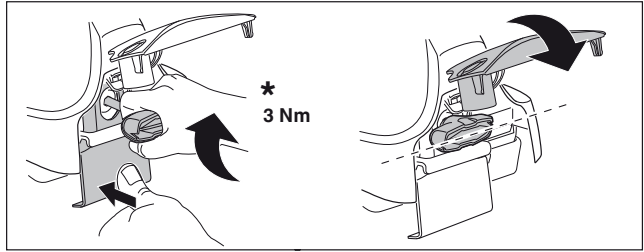
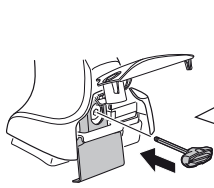
6



THULE
SWEDEN
**ONE
KEY
SYSTEM**

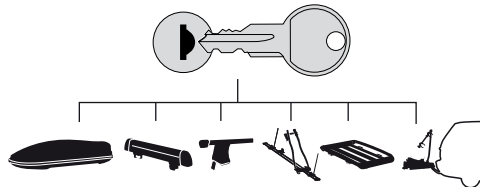

- 544 (x4)
- 596 (x6)
- 588 (x8)
- NA 510 (x10)
- EUR 452 (x12)
- ASIA



WW ▶ Thule Sweden AB, Box 69, 330 33 Hillerstorp, SWEDEN
NA ▶ Thule Inc., 42 Silvermine Road, Seymour, Connecticut 06483, USA

info@thule.com
customer.service@thule.com

www.thule.com