



RHINO-RACK

Aerodynamic & Heavy Duty Roof Rack Systems

RSS156 Hyundai i30 Rhino Sports - Two Bar System

Important: Please read these instructions carefully prior to installation. Please refer to your fitting instruction to ensure that the roof racks are installed in the correct locations. Check the contents of kit before commencing fitment and report any discrepancies. Place these instructions in the vehicle's glove box after installation is complete.

Layout

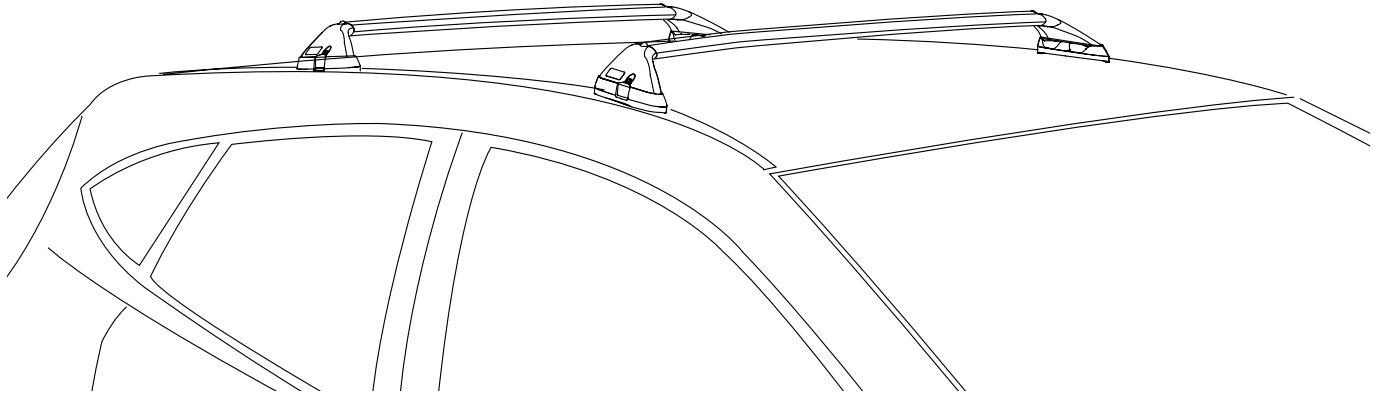

IMPORTANT Care Instruction: Clean roof mounting area prior to fitting the sports roof racks. **PLEASE READ THROUGH INSTRUCTIONS BEFORE FITTING.**

Important Information

Maximum carrying capacity: 50kg

Recommendations:

It is essential that all bolt connections be checked after driving a short distance when you first install your cross bars. Bolt connections should be checked again at regular intervals (probably once a week is enough, depending on road conditions, usage, loads and distances travelled). You should also check the cross bars each time they are refitted.

Make sure to fasten your load securely. Please ensure that all loads are evenly distributed and that the centre of gravity is kept as low as possible.

Use only non-stretch fastening ropes or straps.

Sensitivity to cross winds, behaviour in curves and braking.

The handling characteristics of the vehicle, changes when you transport a load on the roof. For safety reasons, we recommend you exercise extreme care when transporting wind-resisting loads; special consideration must be taken into account when braking.

Please remove cross bars when putting vehicle through an automatic car wash.

Load ratings:

Maximum permissible load is 50kg per pair of cross bars (include the weight of the cross bars, 5kg). When roof racks are to be used in off-road conditions, please build a safety factor of 1.5 into this load limit. Although the roof racks are tested and approved to AS1235-2000, Australian road conditions can be much more rigorous. However, increasing the number of cross bars does not increase the vehicles maximum permissible roof loading.

Note for Dealers and Fitters.

It is your responsibility to ensure instructions are given to the end user or client

Rhino-Rack

3 Pike Street, Rydalmere,

NSW 2116, Australia.

(Ph) (02) 9638 4744

(Fax) (02) 9638 4822

Document No: RS-326

Prepared By: Craig Jones

Authorised By: Gary England

Issue No: 01

Issue Date: 19/10/2007

These instructions remain the property of Rhino-Rack Australia Pty. Ltd. and may not be used or changed for any other purpose than intended.



Hyundai i30 Rhino Sports - Two Bar System

Parts List

Maximum carrying capacity: 50kg

Item	Component Name	Qty	Part No.
1	Buffer Strip (Fr 885mm Rr 853mm)	2	R011
2	Sportz Cross Bar (Fr 885mm Rr 853mm)	2	A155
3	Roof Pad LEFT	2	M049
4	Roof Pad RIGHT	2	M050
5	RSS Sportz Leg RIGHT	2	M014
6	RSS Sportz Leg LEFT	2	M013
7	M6 x 55mm Security Screw	4	B138
8	M6 x 12.5mm Flat Washer	4	W003
9	Roof Pad Cover Plate	4	C411
10	10G x 1/2" Phillips Screw	4	B045
11	5mm Security Allen Key	1	SECKEY-S
12	Fitting Instruction	1	RS-326

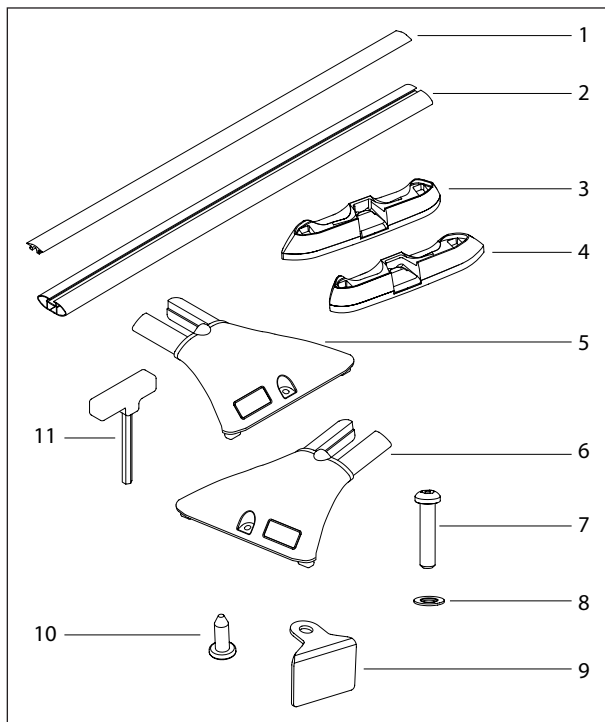

Tools Required:

5mm Security Allen key, included in kit.

Phillips Head Screwdriver.

Rubber Mallet.

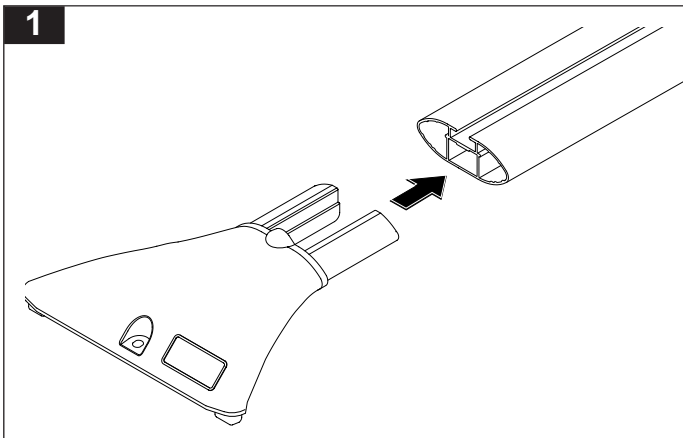

Insert the sports leg fully into the cross bars, a rubber mallet may be required to knock the leg in place.

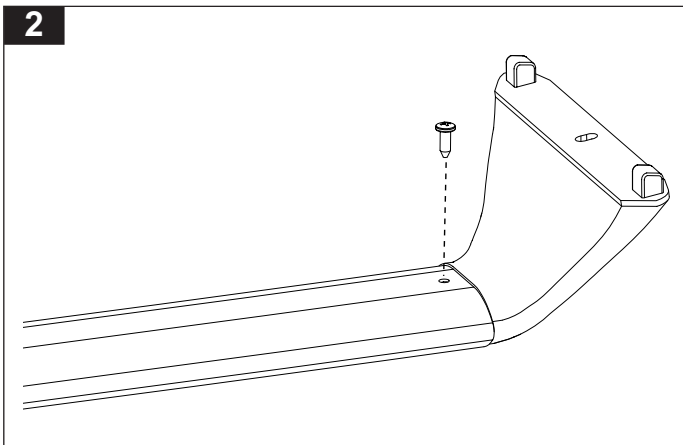

From the underside of the cross bar insert the phillips head screw.



Hyundai i30 Rhino Sports - Two Bar System

3

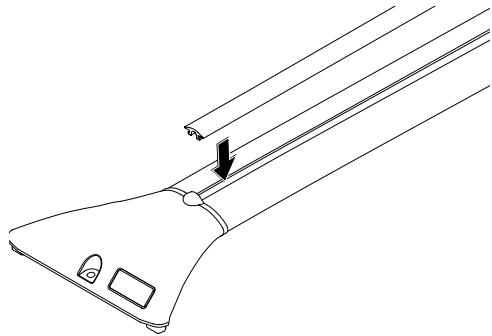

Insert the correct rubber buffer strip into the top of the cross bar.

FRONT cross bar & buffer strip = 885mm.

REAR cross bar & buffer strip = 853mm.

4

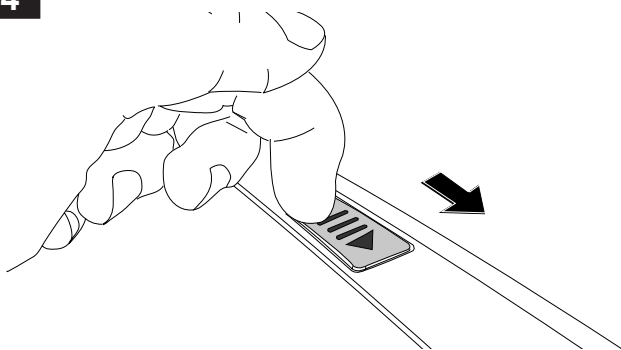

Locate the cover plates on the roof channel trim. Slide the cover plates in the direction of the arrow to remove. This exposes the M6 threaded boss.

5

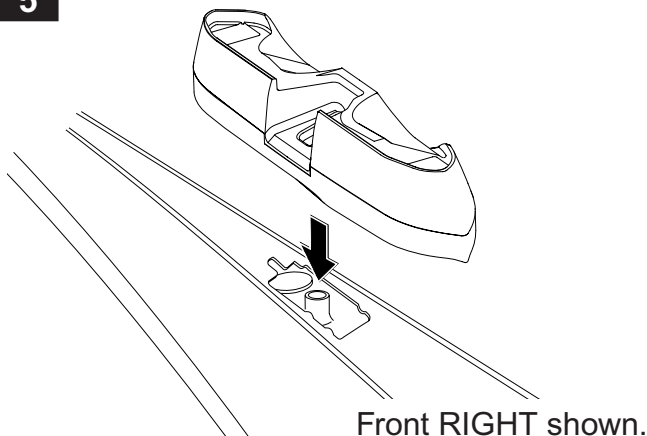

Place the correct roof pad over the M6 threaded boss in the roof channel. **The pads are marked on the underside with part numbers to denote their position on the roof.** There is also an arrow on each pad which must point forward once installed.

RIGHT pad - M050.

LEFT pad - M049.

6

Place two cross bars on the pads. Place the roof pad cover plate on. Put the M6 screw assembly through and fasten to the threaded boss. **TIGHTEN TO 3-4N/m. DO NOT OVER TIGHTEN.**

Front cross bar = 885mm
Rear cross bar = 853mm

