



RHINO-RACK

Aerodynamic & Heavy Duty Roof Rack Systems

Honda MDX Sportz Two Crossbar System

Place these instructions in the vehicle's glove box after installation is complete.

Important: Please read these instructions carefully prior to installation. Please refer to your fitting instruction to ensure that the roof racks are installed in the correct locations. Check the contents of kit before commencing fitment and report any discrepancies

Parts List

Maximum carrying capacity: 75kg

Item	Component Name	Qty	Part No.
1	Sportz Rubber Buffer FRONT 970mm	1	R011
2	Sportz Rubber Buffer REAR 953mm	1	R011
3	Sportz Crossbar FRONT 970mm	1	A155
4	Sportz Crossbar REAR 953mm	1	A155
5	M6 Hex Tube Nut	8	N038
6	MDX Roof Pad	4	M251
7	M6 x 25mm Security Screw	4	B137
8	M6 Spring Washer	4	W004
9	M6 x 12.5mm Flat Washer	4	W003
10	RSP Leg	4	M094
11	Mounting Pad Cover Plate	4	M126
12	10G x 1/2" Pan Head Phillips Screw	4	B045
13	5mm Security Allen Key	1	Seckey-S
14	Fitting Instruction	1	RS-89

Care Instruction:

Thoroughly clean vehicle roof including roof channel prior to fitting the Rhino Sportz roof racks.

Tools Required

Allen key, provided in kit
 Flat Head screwdriver
 Philips Head drill bit or screwdriver
 Measuring Tape
 Marking Pen
 Hacksaw
 Rubber Mallet

Layout

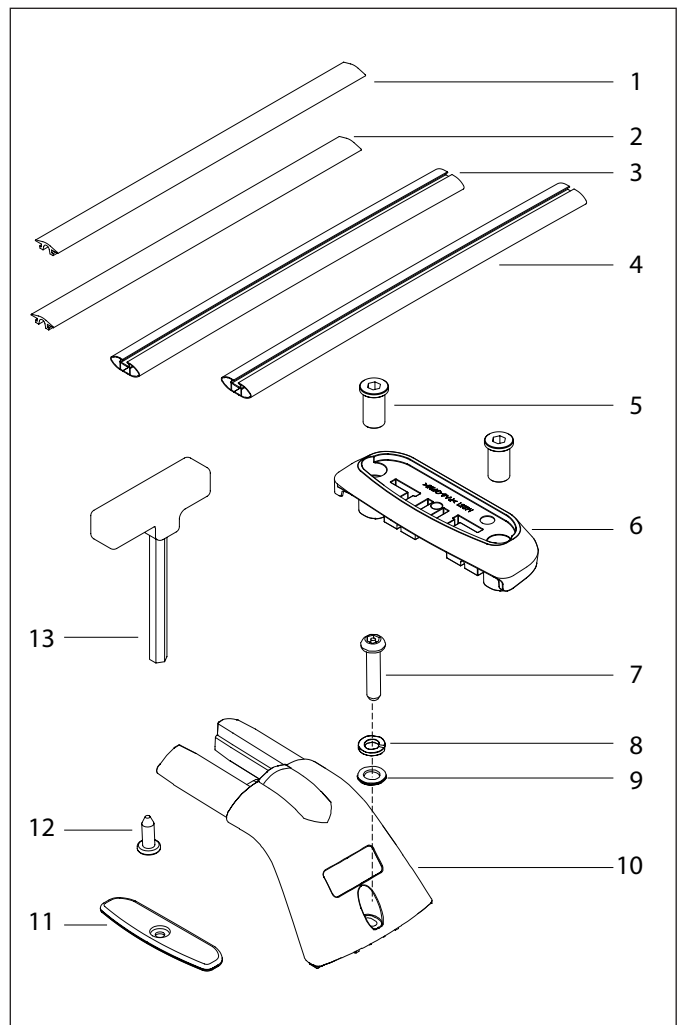
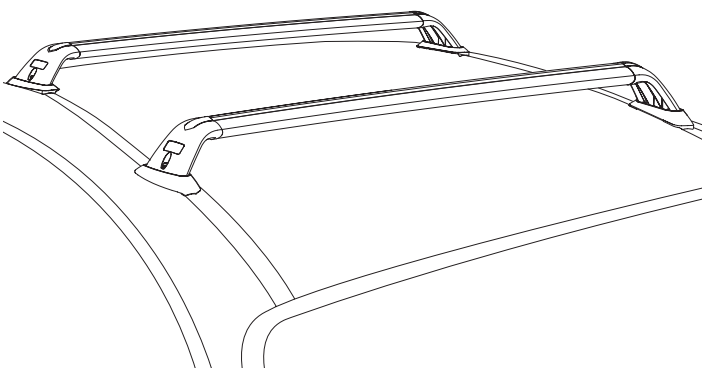
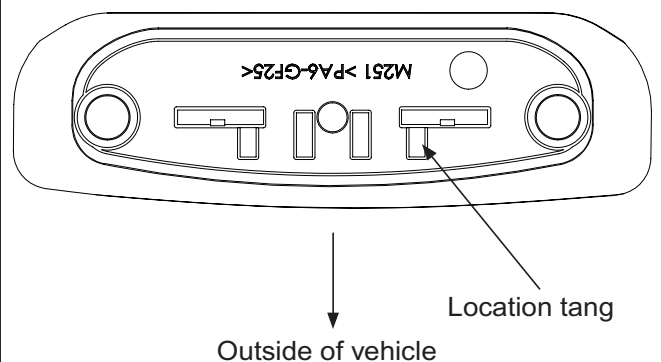
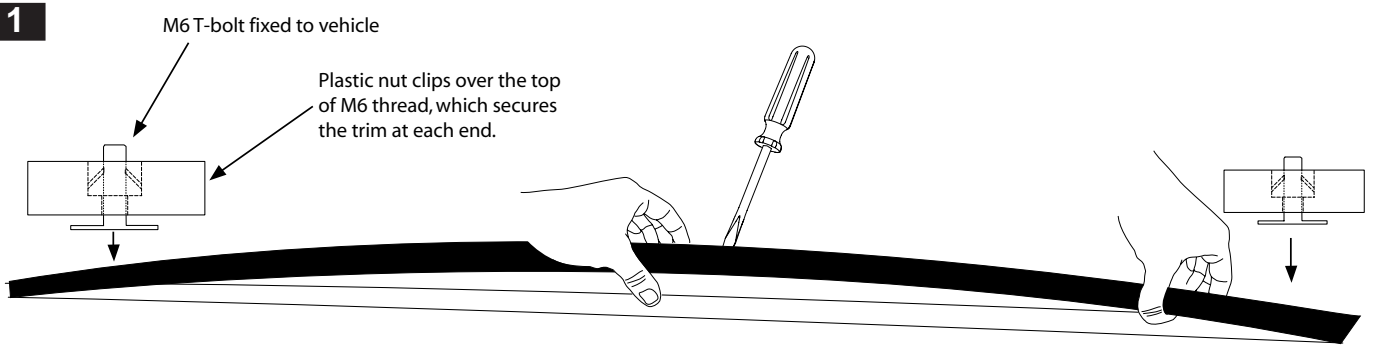

Figure 1. Top view of roof pad, location tangs face towards outside of vehicle.



Remove Roof Trim. Wrap tape around a flathead screwdriver and carefully lever the roof trim from the middle then lift slowly with fingers. On the underside there is one plastic clip at each end of the trim (85mm from the Rear and 60mm from the Front). Slide your fingers towards each end and gently lift trim until it is unclipped.



The roof trim has to be cut to the sizes shown so that it will sit neatly under and be held in by the edge of the MDX roof pads when they are screwed into position. A hacksaw is recommended to cut the trim. 120mm of trim in two spots has to be removed from each side. While the trim is out wipe out any dirt to give the pads a clean surface to sit on.

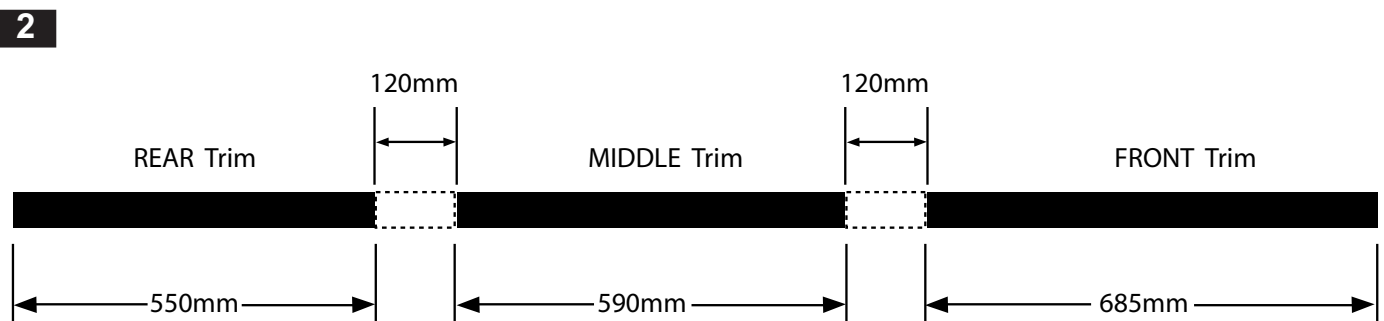

Clip the front and rear roof trim in place and sit the centre piece evenly between the two sets of M6 threads sticking up. Place the M6 tube nuts into the MDX roof pads first then place onto the threads and fasten using the allen key supplied. Tighten to 3-4N/m.

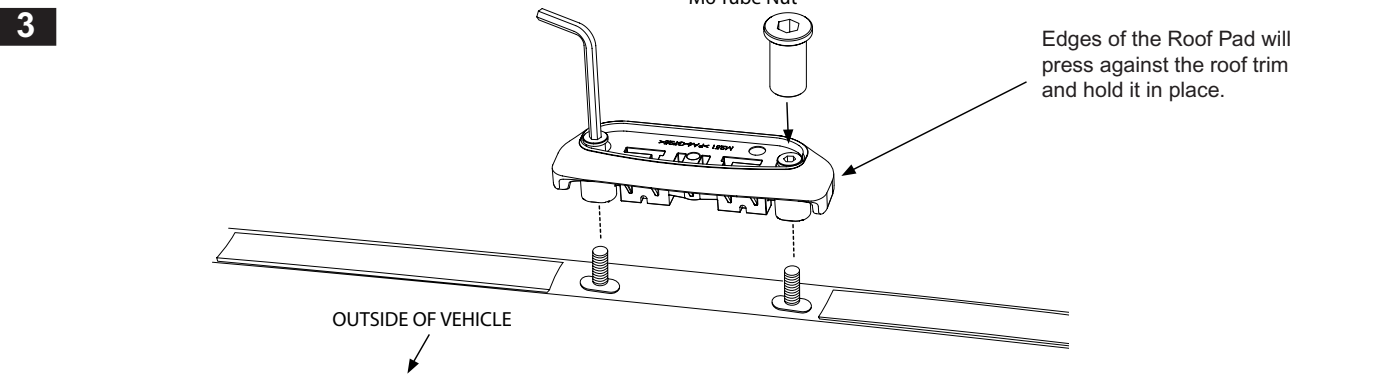

Insert the Sportz leg fully into the crossbars, a rubber mallet may be required to knock the leg in place.

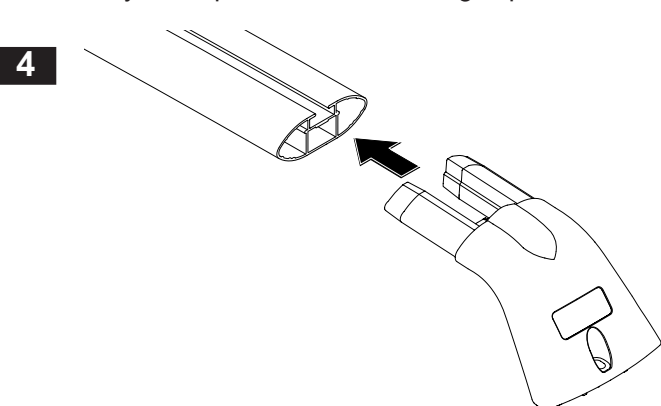

From the underside of the crossbar insert the phillips head screw.

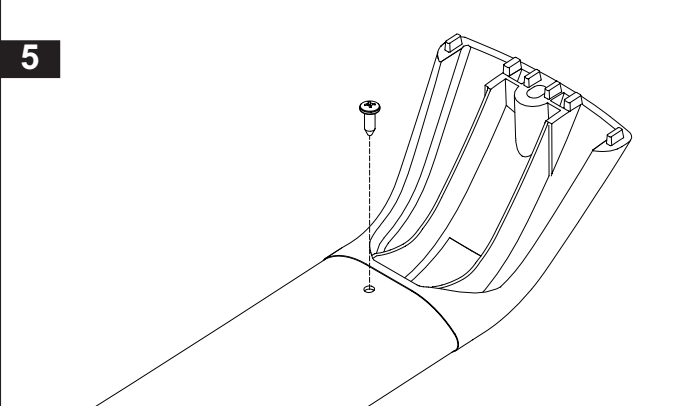

Insert the correct length rubber buffer strip into the top of the crossbar. FRONT Crossbar and Rubber is 970mm. REAR Crossbar and Rubber is 953mm.

6

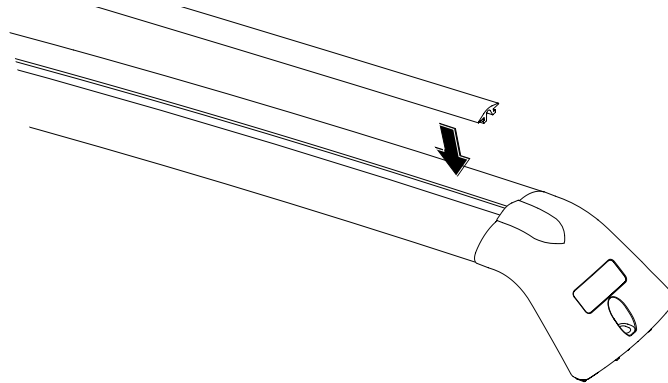

Place the crossbars onto the pads bars identified as front and rear. Assemble the washers onto the security screws. Insert the screw assembly through the Sportz leg mounting hole. Using the allen key provided tighten the support leg screws to secure the crossbars. Recommended tightening torque 3-4N/m. **DO NOT OVER TIGHTEN.**

7

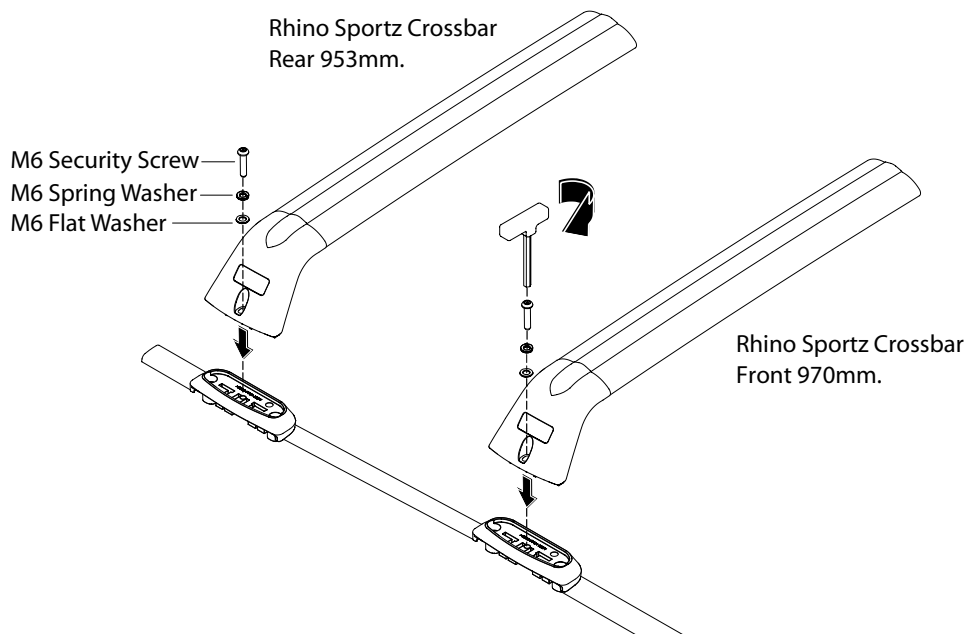

When the roof crossbars and legs are removed the roof pads can be covered for protection with the Mounting Pad Cover Plates.

8

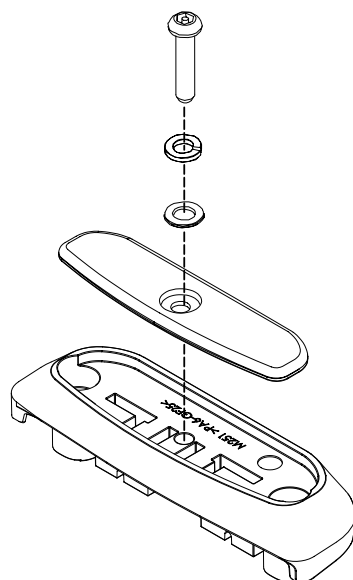

Important Information

Maximum carrying capacity: 75kg

Recommendations

It is essential that all bolt connections be checked after driving a short distance when you first install your crossbars. Bolt connections should be checked again at regular intervals (probably once a week is enough, depending on road conditions, usage, loads and distances travelled). You should also check the roof bars each time they are refitted.

Make sure to fasten your load securely. Please ensure that all loads are evenly distributed and that the centre of gravity is kept as low as possible.

Use only non-stretch fastening ropes or straps.

Sensitivity to Crosswinds, Behaviour in Curves and Braking

The handling characteristics of the vehicle, changes when you transport a load on the roof. For safety reasons, we recommend you exercise extreme care when transporting wind-resisting loads; special consideration must be taken into account when braking.

Please remove crossbars when putting vehicle through an automatic car wash.

Load Ratings

Maximum permissible load is 75kg per pair of roof racks (include the weight of the roof bars, 5kg). When roof racks are to be used in off-road conditions, please build a safety factor of 1.5 into this load limit. Although the roof racks are tested and approved to AS1235-2000, Australian road conditions can be much more rigorous. However, increasing the number of crossbars does not increase the vehicles maximum permissible roof loading.

Note for Dealers and Fitters

It is your responsibility to ensure instructions are given to the end user or client

Rhino-Rack
3 Pike Street, Rydalmere,
NSW 2116, Australia.
(Ph) (02) 9638 4744
(Fax) (02) 9638 4822

Document No: RS-89
Prepared By: Craig Jones
Authorised By: Gary England

Issue No: 01
Issue Date: 18/10/2005

These instructions remain the property of Fetovu Pty Ltd T/as Rhino-Rack and may not be used or changed for any other purpose than intended.