



RHINO-RACK

Aerodynamic & Heavy Duty Roof Rack Systems

RSP06 Rhino Sportz - Subaru Liberty Wagon

Place these instructions in the vehicle's glove box after installation is complete.

Important: Please read these instructions carefully prior to installation. Please refer to your fitting instruction to ensure that the roof racks are installed in the correct locations. Check the contents of kit before commencing fitment and report any discrepancies.

Parts List

Item	Component Name	Qty.	Part No.
1	Rhino Sportz Rubber Buffer Strip	2	R011
2	Rhino Sportz Crossbar	2	A155
3	M6 x 25mm Button Head Security Screw	4	B137
4	M6 Spring Washer	12	W004
5	M6 x 12.5mm Flat Washer	12	W003
6	Rhino Sportz Short Leg	4	M094
7	10G x 1/2" Pan Head Phillips Screw	4	B045
8	M6 x 16mm Button Head Security Screw	8	B061
9A	Subaru Liberty Left Mounting Pad	2	M164
9B	Subaru Liberty Right Mounting Pad	2	M165
10	5mm Security Allen Key	1	H011 & H013
11	Fitting instruction	1	RS68

Layout

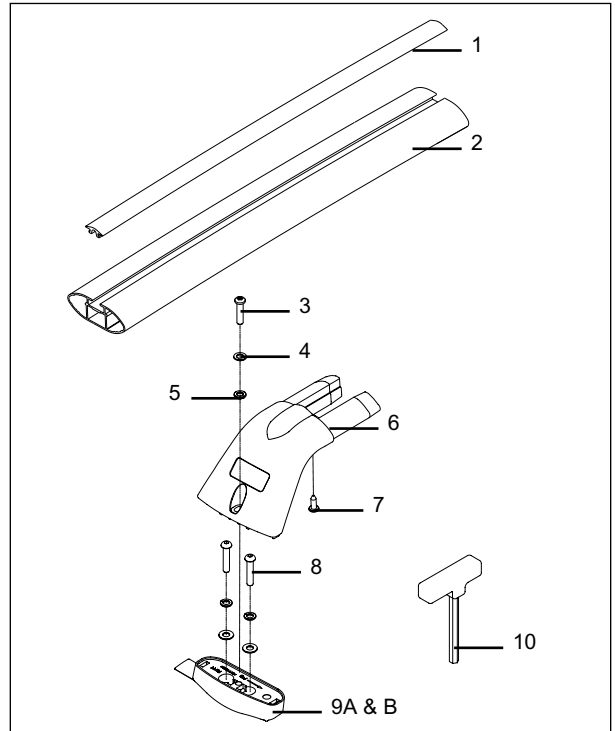
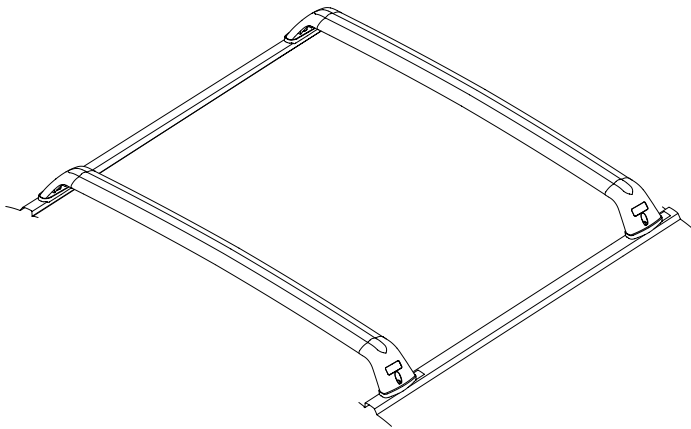

Tools Required

Security type allen key, provided in kit
Phillips head screw driver
Small Flat Blade Screwdriver

Care Instruction

Clean vehicle roof prior to fitting the Rhino-Rack roof racks.

Remove the four covers from the roof rack mounting locations by carefully inserting a small bladed screwdriver into the cut outs in the rear of the cover and lever upwards carefully.

1

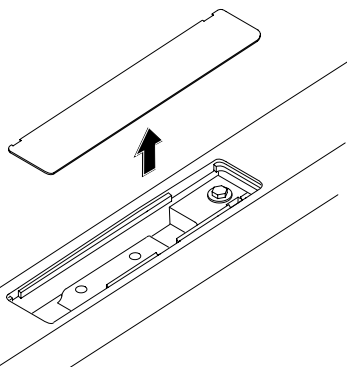

Insert the support leg fully into the crossbars, a rubber mallet may be required to knock the leg in place.

2

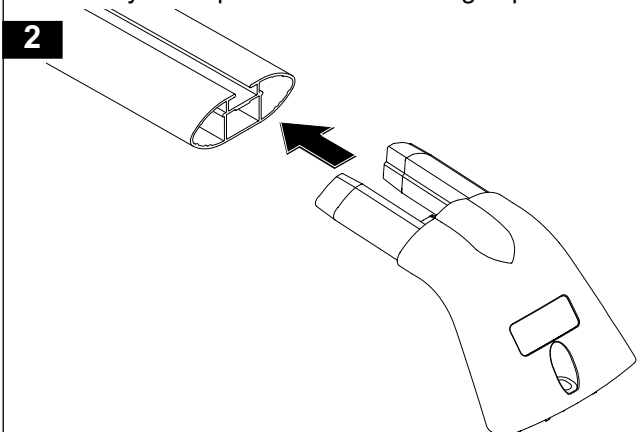

From the underside of the crossbar insert the phillips head screw.

3

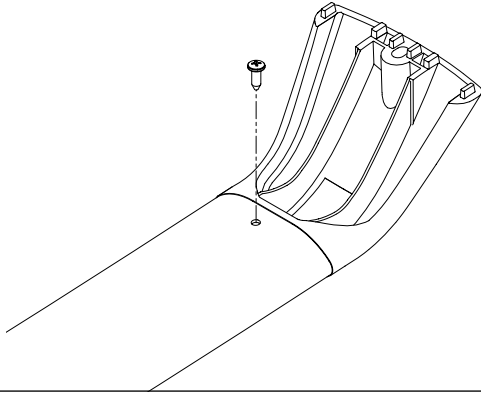

Insert the rubber buffer strip into the top of the crossbar.

4

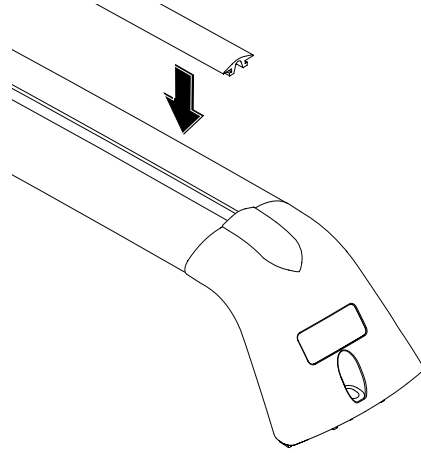

Each mounting pad is identified left or right. Note: The right hand side of the vehicle is the driver's side.

5

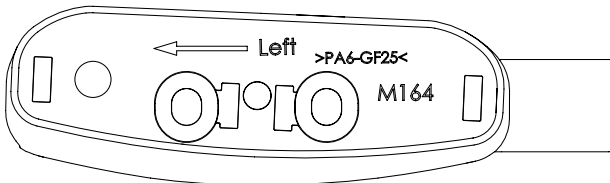

Assemble the spring and flat washers onto the security screws. Insert the screws into the pad mounting holes and place pads into the roof rack attachment recesses. Using the allen key carefully tighten. Recommended tightening torque 3-4N/m. **DO NOT OVERTIGHTEN.** Repeat this process for each pad.

6

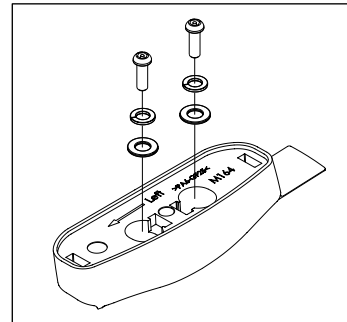

Place the crossbars onto the pads bars identified as front and rear.

7

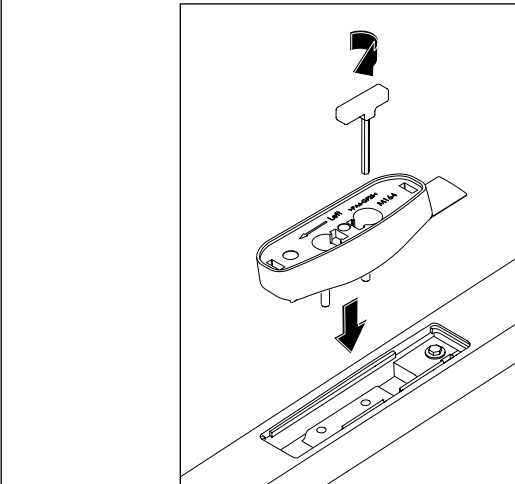
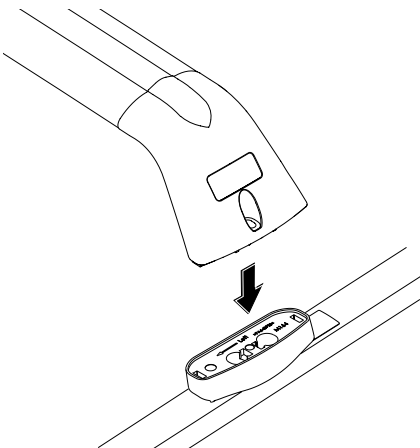

Assemble the spring and flat washers onto the security screws. Insert the screw assembly into the support leg mounting holes. Using the allen key provided tighten the support leg screws to secure the crossbars. Recommended tightening torque 3-4N/m. **DO NOT OVERTIGHTEN.**

8

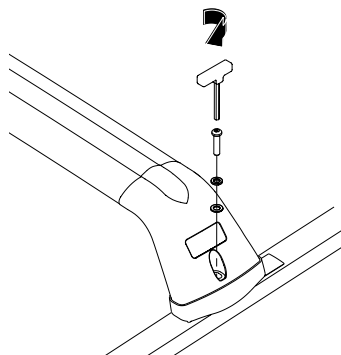

Removing the Crossbar Assembly

When removing the Rhino Sportz rack, unscrew the attachment screws and remove the crossbars. The mounting pads can remain attached to the roof if desired. Store the Rhino Sportz rack in a safe place. To mount M123 cover plates (please refer to separate instruction sheet).

Refitting the Crossbar Assembly

To refit the crossbar assemblies, place the crossbars onto the mounting pads in their preset positions. Insert the M6 screw assembly as per instruction 8 and tighten the bolt as recommended.

Important Information

RECOMMENDATIONS

Please refer to your fitting instruction to ensure that the Rhino Sportz roof racks are installed in the correct locations.

The vehicles roof load rating may be less than the Rhino roof rack load rating.

It is essential that all screw/bolt connections are checked after driving a short distance when you first install your Rhino-Rack. Screw/bolt connections should be checked again at regular intervals (probably once a week is enough, depending on road conditions, usage, loads and distances travelled). You should also check the Roof Racks each time they are refitted.

Roof Racks and accessories should be cleaned and all screw threads should be lubricated at regular intervals. This will help avoid damage to your vehicles paint surface. Always clean the vehicle roof and the mounting brackets before fitting the roof bars.

Rhino-Rack offers a 3 year warranty to the original purchaser of Rhino-Rack Systems and Accessories. Rhino-Rack cannot be held responsible for incorrect mounting of the racks or for usage that exceeds production tolerances.

Make sure to fasten the load securely. Please ensure that all loads are evenly distributed and that the centre of gravity is kept as low as possible.

USE ONLY NON-STRETCH FASTENING ROPES AND STRAPS

SENSITIVITY TO CROSSWINDS, BEHAVIOUR IN CURVES AND BRAKING

The handling of the car changes when you transport a load on the roof.

For safety reasons, we recommend you exercise extreme care when transporting wind resistant loads. Special consideration must be taken into account when braking.

PLEASE REMOVE ROOF RACKS WHEN PUTTING VEHICLE THROUGH AUTOMATIC CAR WASH

LOAD RATINGS

Maximum permissible load is 60kg per set of two bar roof racks (include the weight of the roof bars, 5kg).

When Roof Racks are to be used in off-road conditions, please build a safety factor of 1.5 into this load limit (50kg per set). Although the Roof Racks are tested and approved to AS1235-2000, Australian road conditions can be much more rigorous. Increasing the number of crossbars does not increase the vehicles maximum permissible roof loading.

NOTE FOR DEALERS AND FITTERS

It is your responsibility to ensure instructions are given to the end user or supplier.

Rhino-Rack

3 Pike Street, Rydalmere,

NSW 2116, Australia.

(Ph) (02) 9638 4744 (Fax) (02) 9638 4822

Document No: RS-68

Prepared By: Sheila Oliveira

Authorised By: Gary England

Issue No: 01

Issue Date: 11/06/2004

These instructions remain the property of Fetovu Pty Ltd T/as Rhino-Rack and may not be used or changed for any other purpose than intended.