



**Toyota Landcruiser 100 Series Sportz Roof Rack  
Three crossbars.**

**Part No: RSP02**

**Installation Time: Approx. 20mins**

Place these instructions in vehicle's glovebox after installation is complete.

**Important: Please read these instructions carefully prior to installation.**

**Parts List**

**Important: Check contents of kit before commencing fitment and report any discrepancies.**

Item.	Component Name.	Qty.	Service Part No.
1	Sports pad leg.	6	M094
2	Front left mounting pad with gasket.	1	M095
3	Front right mounting pad with gasket.	1	M096
4	Middle left mounting pad with gasket.	1	M097
5	Middle Right mounting pad with gasket.	1	M098
6	Rear left mounting pad with gasket.	1	M099
7	Rear Right mounting pad with gasket.	1	M100
8	Washer gasket.	12	C372
9	Front crossbar with buffer strip (1070mm).	1	A155/R011
10	Middle crossbar with buffer strip (1042mm).	1	A155/R011
11	Rear crossbar with buffer strip (1010mm).	1	A155/R011
12	10G x ½ Pan Phillips self tapping screw.	6	B045
13	M8 x 50 socket button head screws.	8	B126
14	M8 x 40 socket button head screws.	4	B127
15	M8 Spring washers.	12	W030
16	M8 Flat washer.	12	W019
17	7mm mounting pad O rings	12	C299
18	M6 x 32 Security bolts.	6	B064
19	M6 Flat washers.	6	W003
20	M6 Spring washers.	6	W002
21	Security Allen key.	1	H011/H013
22	Cover Plate	6	M126
23	Fitting Instructions.		

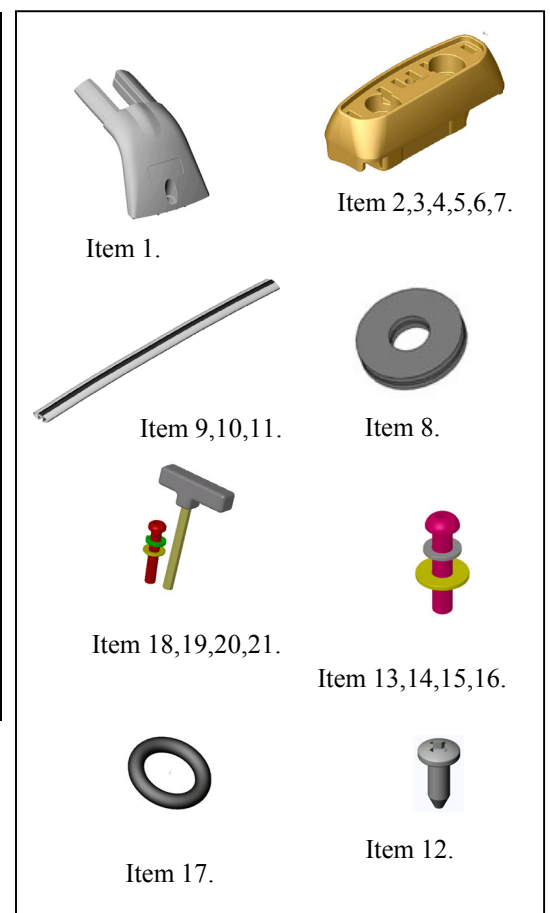

**Layout.**

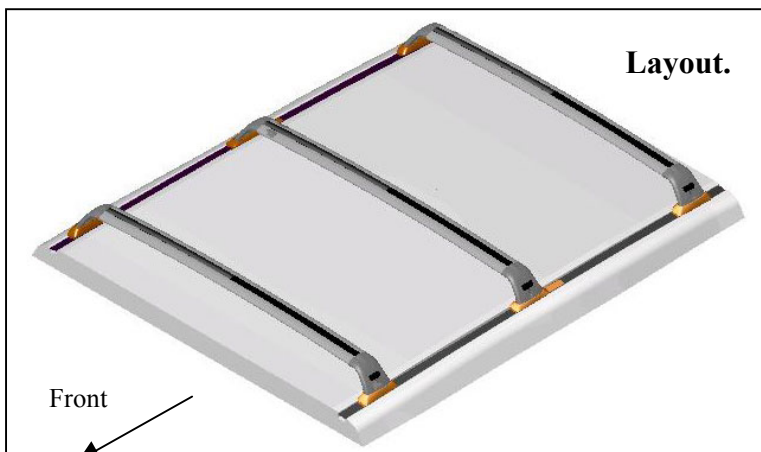

**Care Instructions:**

Clean vehicle roof prior to fitting the roof racks.

**Tools Required:**

Phillips Head Screw Driver.  
Security Type Allen Key (provided in kit).

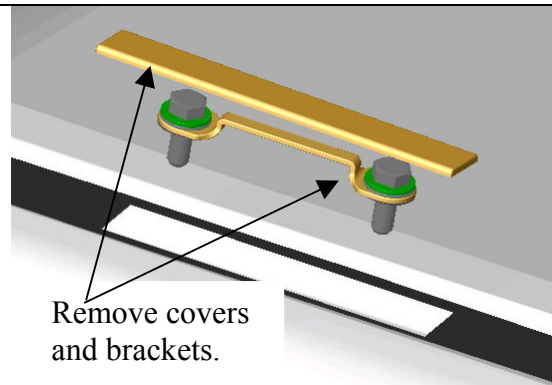

- 1: Remove the front and middle pair of roof rack attachment point covers.
- 2: Remove exposed bolts and brackets.
- 3: Store covers, bolts and brackets in a safe place.

**Note: The existing bolts and washers are not used to fit the mounting pads.**

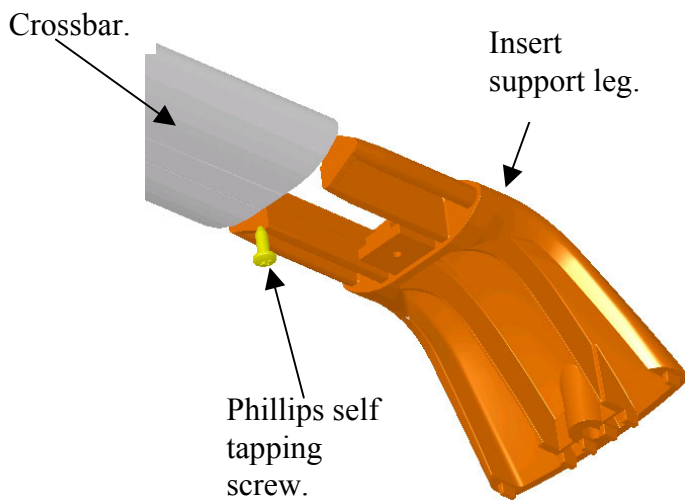

- 5: Insert the support leg (item 1) fully into the crossbars (item 9,10,11).
- 6: From the underside of the crossbar insert the Phillips screw (item 12) into the hole provided and screw into the support leg to secure the leg to the crossbar.

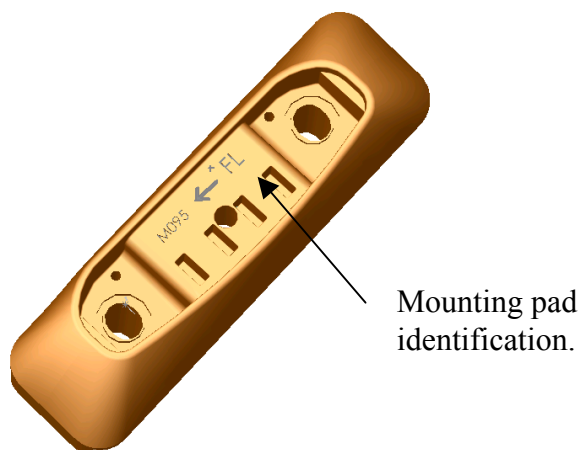

- 7: Each mounting pad is identified with a part number, position code and direction arrow. **The arrow must point to the front of the vehicle.**

The mounting pad position code is as followed: -

- Front left side pad – FL (item 2).
- Front right side pad – FR (item 3).
- Middle left side pad – ML (item 4).
- Middle right side pad – MR (item 5).
- Rear left side pad – RL (item 6).
- Rear right side pad – RR (item 7).

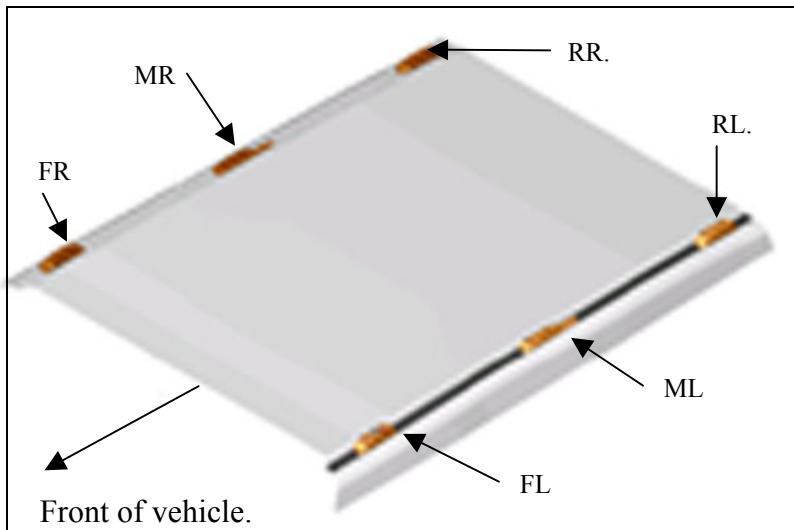

**9:** Using the mounting pad layout as a guide, place the pads onto their respective positions.

**Note:**

**Ensure that the arrows on the pads are facing forward.**

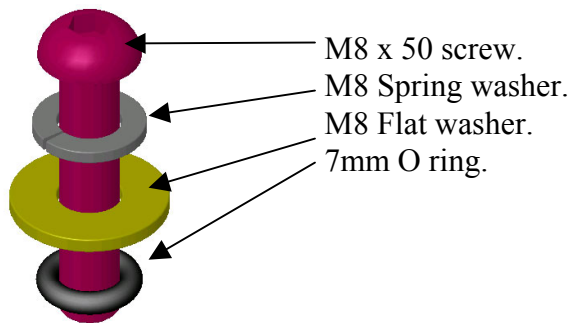

M8 x 50 screw.  
M8 Spring washer.  
M8 Flat washer.  
7mm O ring.

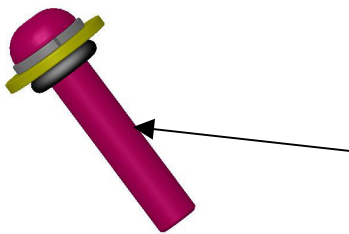

**The O ring must be in this position prior to inserting the screw assembly into the mounting pad.**

**9:**

Place the M8 spring washer, M8 flat washer and 7mm O ring (item 15,16,17.) onto M8 screws.

Ensure that the O ring is pushed up under the flat washer.

- For front and rear mounting pads use an M8 x 50 screws (item 13).
- For middle mounting pads use an M8 x 40 screw (item 14).

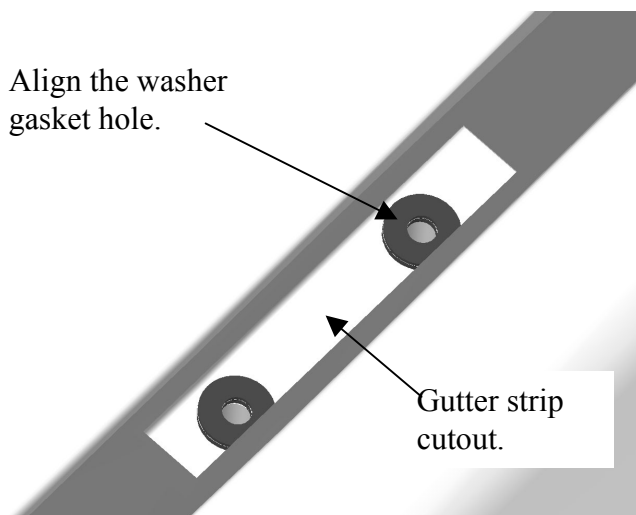

**10:** Place the mounting pad washer gaskets (item 8) in the gutter recess and align the hole in the washer gasket with the mounting pad nutsert.

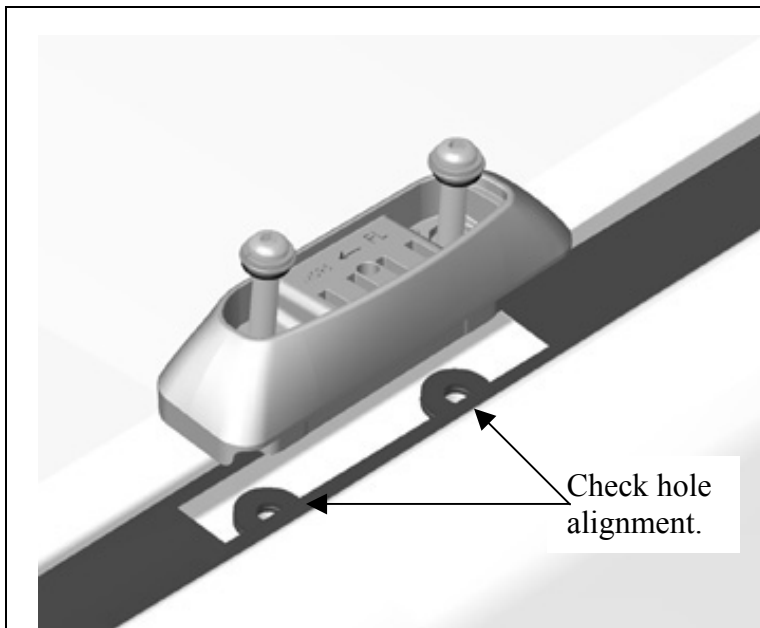

**11:** Insert the screws through the mounting pads and screw into the nutserts in the vehicles roof.

Note: Before inserting the screws check that the washer gasket has not moved and the nutsert is fully visible through the mounting pad hole.

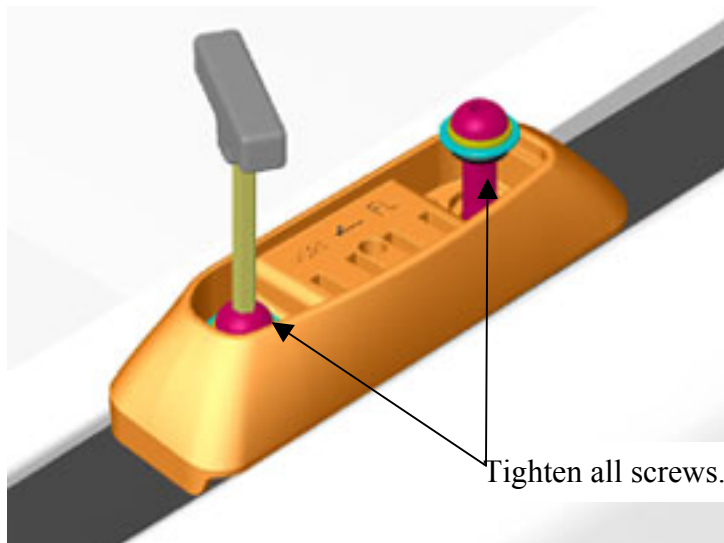

**12:** Tighten all screws using the Allen key provided (item 21).

Recommended tightening torque 4N/m

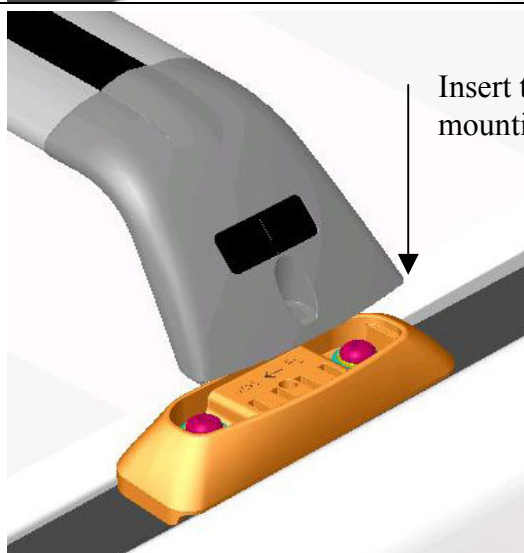

**13:** Insert the support legs into the mounting pads. The crossbar is identified as **Front and middle**, refer the crossbar layout.

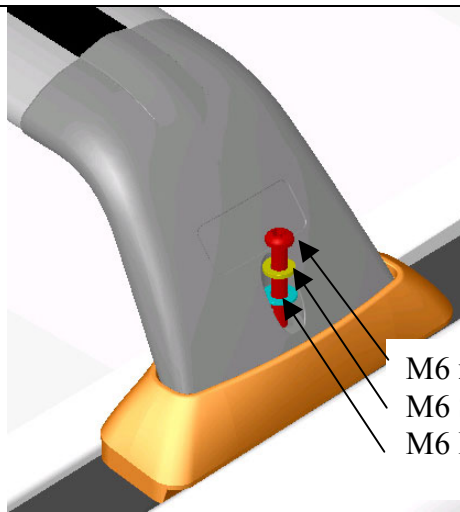
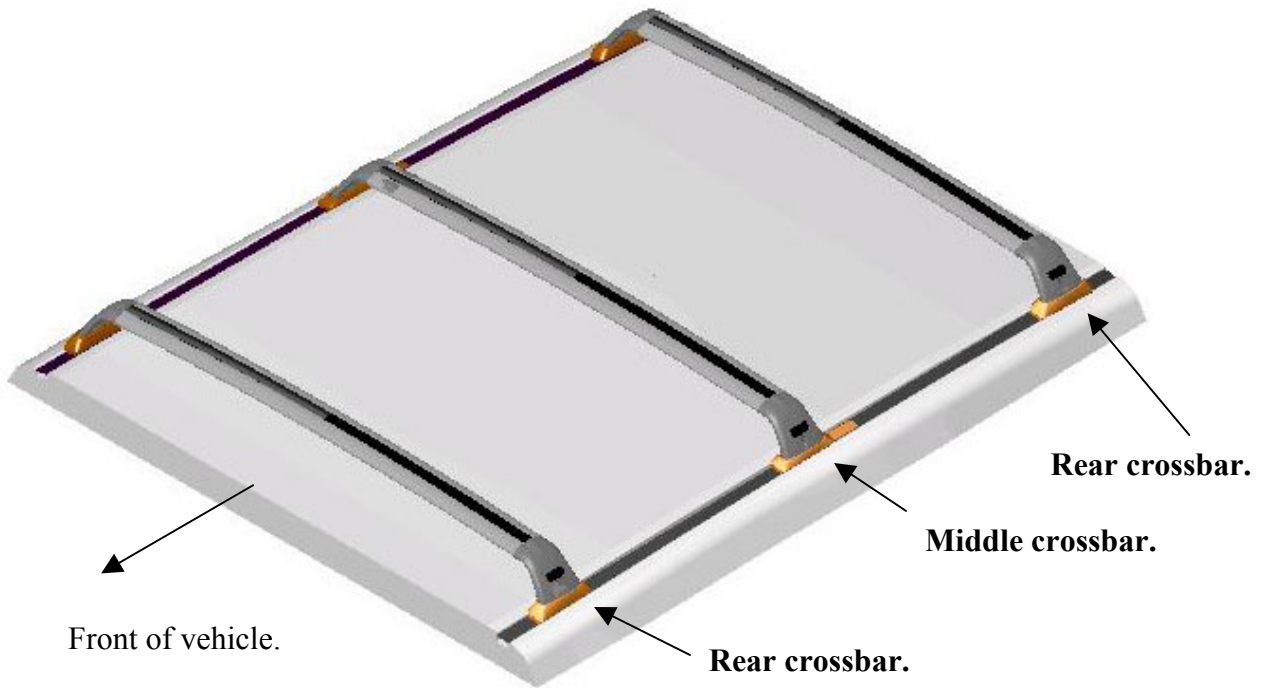

M6 x 32 security screw.  
M6 Spring washer.  
M6 Flat washer.

**14:** Place the M6 spring washer and M6 flat washer onto the M6 x 32mm security screw (item 18,19,20). Insert the M6 screw assemble through the support leg and screw into the mounting pad.

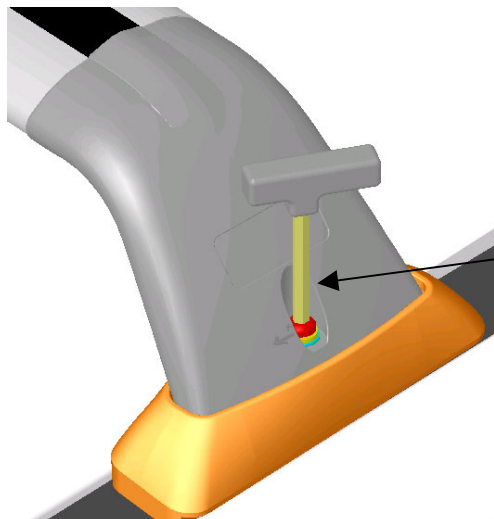

Tighten the M6 security screws.

**15:** Using the security Allen key (item 21) provided tighten support leg attachment screws to secure the crossbars.

When removing the crossbars, unscrew the attachment screws and remove the crossbars.

The mounting pads can remain attached to the roof if desired.

Recommended tightening torque 4N/m



**Maximum carrying capacity – 3 crossbars 120Kgs.**

- The maximum carrying capacity specified in the fitting instructions and on the crossbars should not be exceeded. The capacity noted in the vehicles owners’ handbook should be observed. Where the load capacity differs, the lower of the nominated load capacities applies.
- Ensure that all loads are evenly distributed across the crossbars and then center of gravity kept as low as possible.
- Heavy and narrow loads should be carried near the roof rack support legs (Item 1). Check the security of the load and tension of the roof rack security screws before departing and regular intervals during the journey.
- Surfboards or similar item must not be carried side by side but stacked on top of each other and secured front and rear of the vehicle.
- It is recommended that where specialized accessories are available for carrying ie cycles or canoes, these should be used.
- Loads projecting beyond the vehicle length must be secured front and back.
- Be aware of the statutory requirements regarding maximum permissible projections from the vehicle.
- **Remember that the Roof Racks increase the overall height of the vehicle.**
- Use only **NON-STRETCH TIE DOWN straps to secure the load.**
- Any load carried on the vehicles roof will adversely affect its handling and braking , particularly in cornering or in cross wind, the vehicle should therefore be driven with increased caution.
- Roof racks should be removed prior to using a car wash.
- The roof racks should be removed regularly to clean adjoining vehicle surfaces and attaching locations. Bolts and cage nuts should be lubricated at regular intervals and checked for tension.
- Roof racks should not remain on the vehicle for extended periods when not required.
- To reduce fuel consumption, remove Roof rack when not in use.

Manufactured by Rhino-Rack  
3 Pike Street, Rydalmere,  
NSW 2116, Australia  
(Ph) 02 9638 4744 (Fax) 02 9638 4822

<b>RHINO - RACK</b>	No: 03
Prepared By: Alan Marshall	Issue No RSP02
Authorised By: Gary England	Issue Date: 15/08/05