

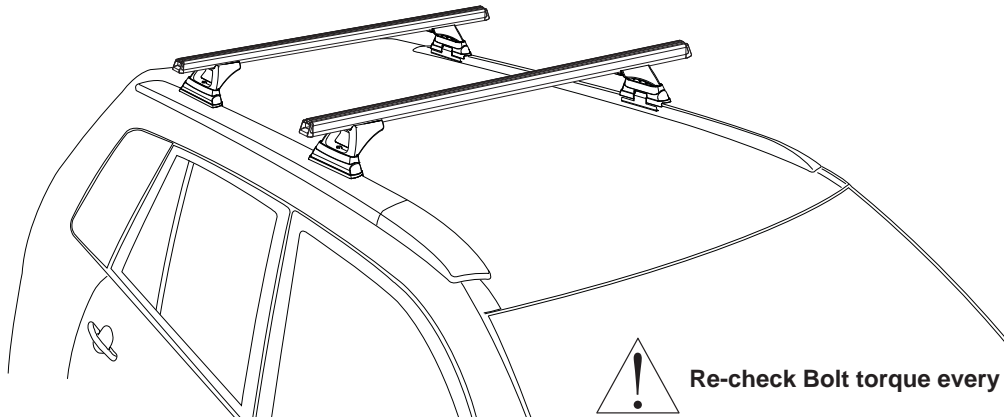

CONTROLLED

RHINO-RACK

RLCP29 ISUZU MU-X (2-Bar)



Please read these instructions carefully prior to installation.
Check the contents of kit before commencing fitment and report any discrepancies.
Please refer to your fitting instruction to ensure that the roof racks are installed in the correct locations.

Important Information

Max: 60kg/132lbs. Please refer to your vehicle owners manual for maximum roof loading.
Always use lower of the two figures.

Recommendations:

It is essential that all bolt connections be checked after driving a short distance when you first install your crossbars. Bolt connections should be checked again at regular intervals (probably once a week is enough, depending on road conditions, usage, loads and distances travelled). You should also check the crossbars each time they are refitted. Make sure to fasten your load securely with tie down straps or non stretch ropes. Please ensure that all loads are evenly distributed and that the centre of gravity is kept as low as possible.

Please remove crossbars when putting vehicle through an automatic car wash.

Load Ratings:

Maximum permissible load is **60kg/132lbs** for Two or Three crossbars including the weight of the crossbars, Two crossbars = 5kg/11lbs or three crossbars = 7.5kg/16.5lbs. When crossbars are to be used in off-road conditions, please build a safety factor of 1.5 into this load limit for off-road use. **40kg/88lbs** for off-road use. Although the crossbars are tested and approved to AS1235-2000, off-road conditions can be much more rigorous. However, increasing the number of crossbars does not increase the vehicles maximum permissible roof loading.

Note for Dealers and Fitters:

It is your responsibility to ensure instructions are given to the end user or client.

Rhino-Rack
3 Pike Street, Rydalmere,
NSW 2116, Australia.
(Ph) (02) 9638 4744
(Fax) (02) 9638 4822

Document No: R399
Prepared By: Kayle Everett
Authorised By: Chris Murty

Fit Time: 30min
Issue No: 07
Issue Date: 01/04/2016

These instructions remain the property of Rhino-Rack Australia Pty. Ltd. and may not be used or changed for any other purpose than intended.



RLCP29 ISUZU MU-X (2 - Bar)

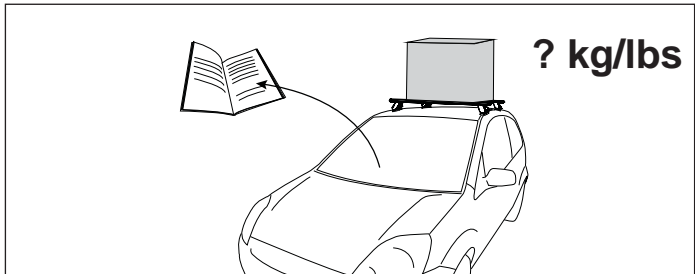
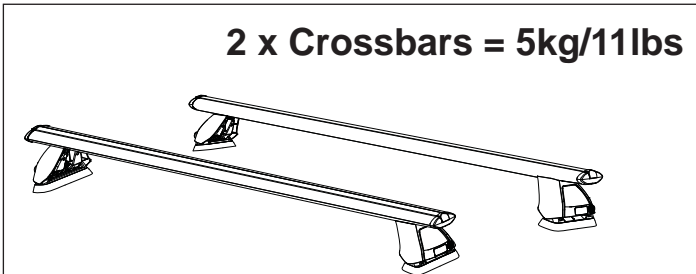
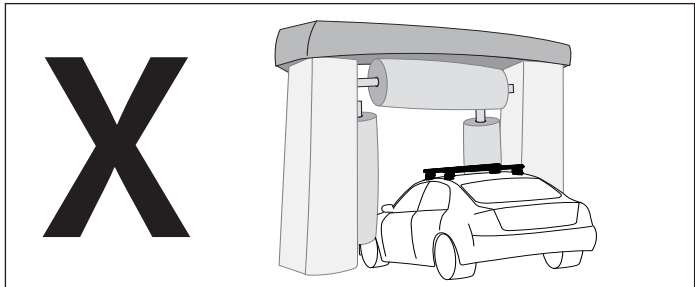
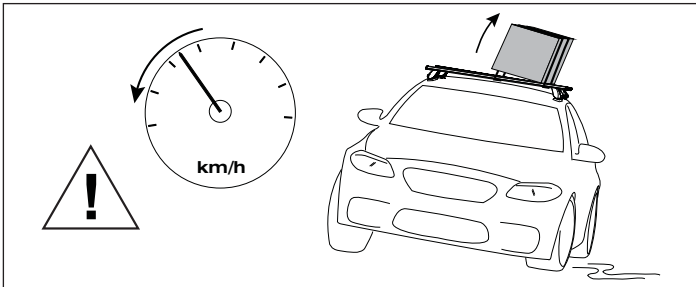
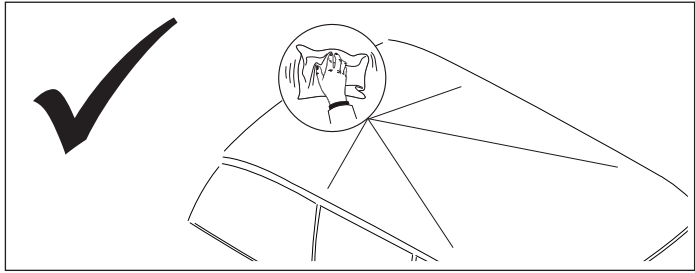
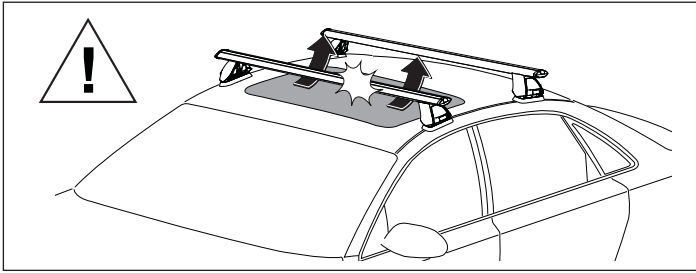
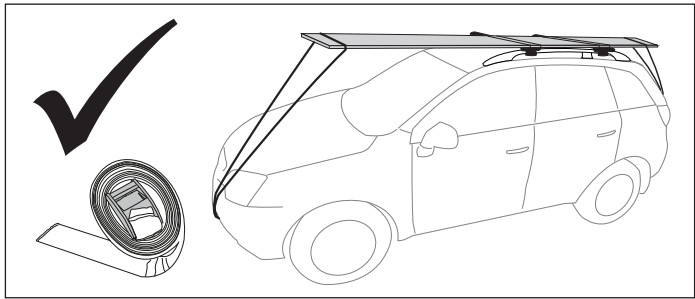
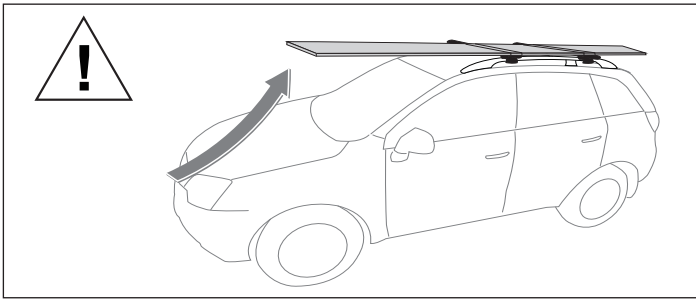

When these roof racks are to be used on a vehicle that is driven off sealed roads, the manufacturer maximum roof load rating (found in the vehicles User Manual) should be divided by 1.5. Subtract 5kg/11lbs from your maximum carrying capacity to account for the weight of the roof racks.

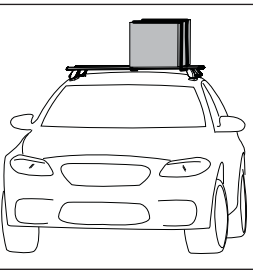

Max: 60kg/132lbs
(Urban road) = **Max: 40kg/88lbs**
(Off road)

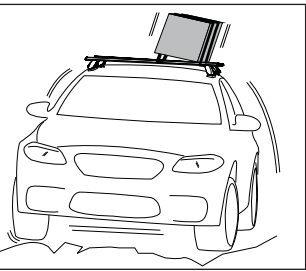

WARNING! Important Load Carrying Instructions
With utility vehicles, the cabin and the canopy move independently. Roof racks and vehicle can be damaged if the item transported is rigidly fixed at points on both the cabin and canopy. Instead, rigidly fix to either the cabin roof racks or the canopy roof racks.

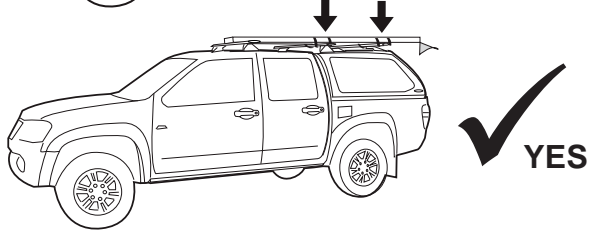
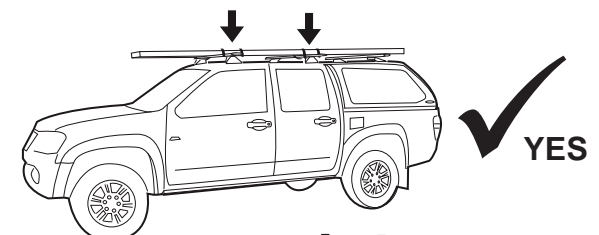
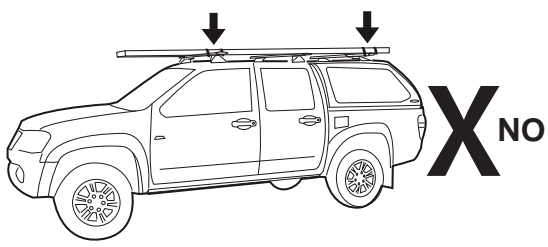



RLCP29 ISUZU MU-X (2 - Bar)

Parts List

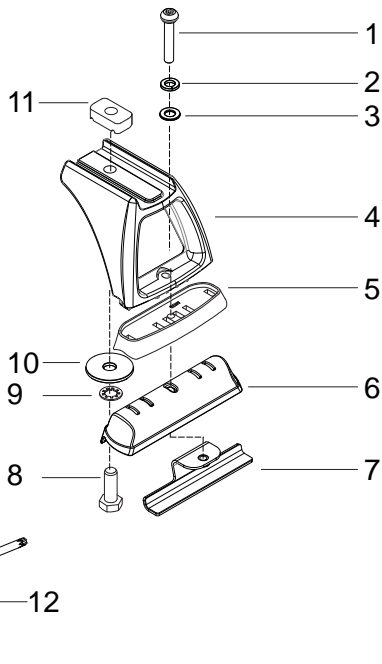

*Note: RLCP29F for use as the front crossbar in 3 bar system only. Sold separately.

Item	FRONT: RLCP29F	Qty	Part No.
1	M6 x 40mm Security Torx Screw	2	B248
2	M6 Spring Washer	2	W004
3	M6 x 12.5mm Flat Washer	2	W003
4	RLCP Leg	2	M559
5	Top Pad	2	M173
6	Base Pad	2	M258
7	Bracket	2	CA1272
8	M10 x 25mm Hex Bolt	2	B071
9	M10 Internal Shakeproof Washer	2	W021
10	M10 x 38mm Flat Washer	2	W022
11	M10 Channel Nut	2	N024
12	T27 Torxkey	1	H054
13	Fitting Instruction	1	R399

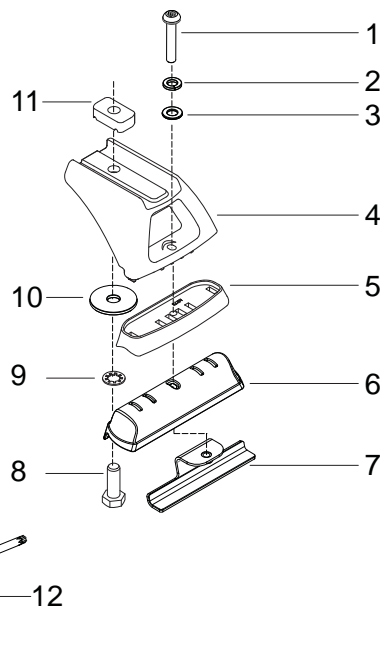

Note: RLCP29 contains two sets of low legs.

Note: RLCP29H for use as the middle and rear crossbar.

Item	MID - REAR: RLCP29H	Qty	Part No.
1	M6 x 40mm Security Torx Screw	2	B248
2	M6 Spring Washer	2	W004
3	M6 x 12.5mm Flat Washer	2	W003
4	RLCP Leg	2	M123
5	Top Pad	2	M173
6	Base Pad	2	M258
7	Bracket	2	CA1272
8	M10 x 25mm Hex Bolt	2	B071
9	M10 Internal Shakeproof Washer	2	W021
10	M10 x 38mm Flat Washer	2	W022
11	M10 Channel Nut	2	N024
12	T27 Torxkey	1	H054
13	Fitting Instruction	1	R399

Crossbars sold individually	Part No.
1250mm Heavy Duty Crossbar SILVER	RB1250S
1250mm Heavy Duty Crossbar BLACK	RB1250B
1260mm Vortex Crossbar SILVER	VA126S
1260mm Vortex Crossbar BLACK	VA126B

Crossbar adaptors sold separately	Part No.	Qty
When fitting Two or Three VORTEX Crossbars	VA-FK2	2-3
When fitting Two Heavy Duty Crossbars	-	-



Tools Required:

1- Torx Security Key (supplied in kit). 4- Utility Knife.
 2- 5/8 or 16mm Spanner (Heavy Duty crossbars) 5- Tape Measure.
 3- 10mm Spanner (Vortex crossbars) 6- Torque Wrench.



RLCP29 ISUZU MU-X (2 - Bar)

1

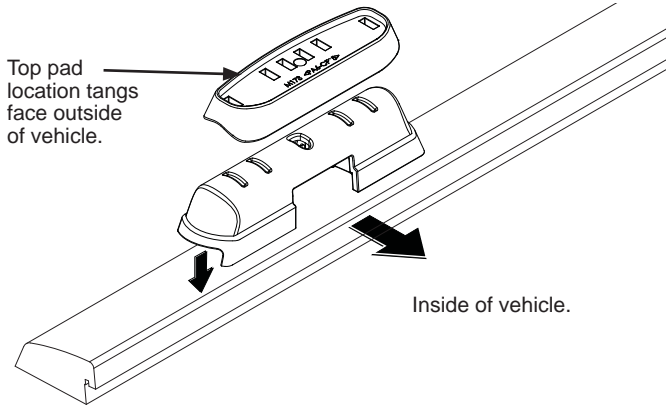

The four top and bottom pads are identical. Diagram at left shows correct orientation of top and bottom pad. The large cut out and lip of the bottom pad sits over the inside edge of the roof rail.

2

Use measurements below as a guide for positioning roof racks.

Joint of roof rail

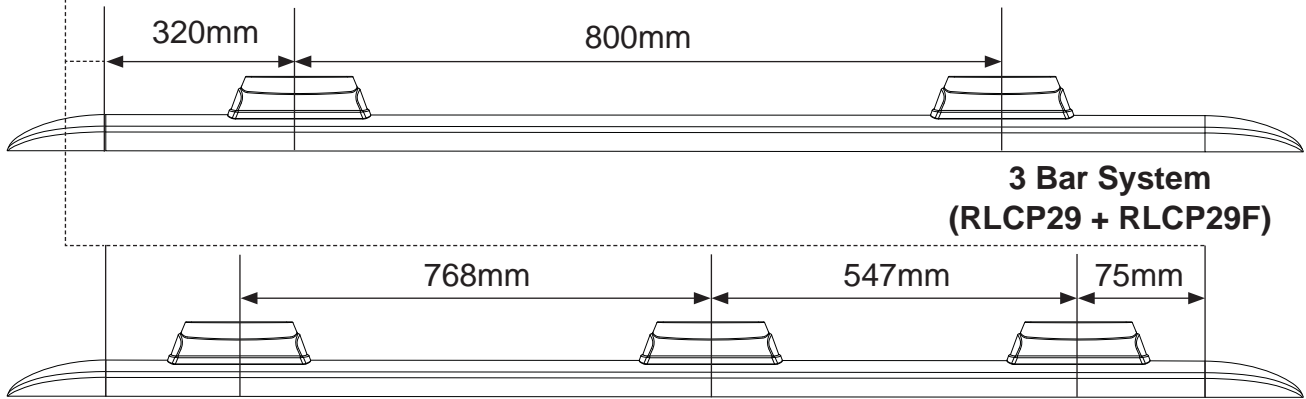

2 Bar System (RLCP29)

3 Bar System (RLCP29 + RLCP29F)

Front

Rear

3

This step combines with following Step 4. Place each leg onto a pad.

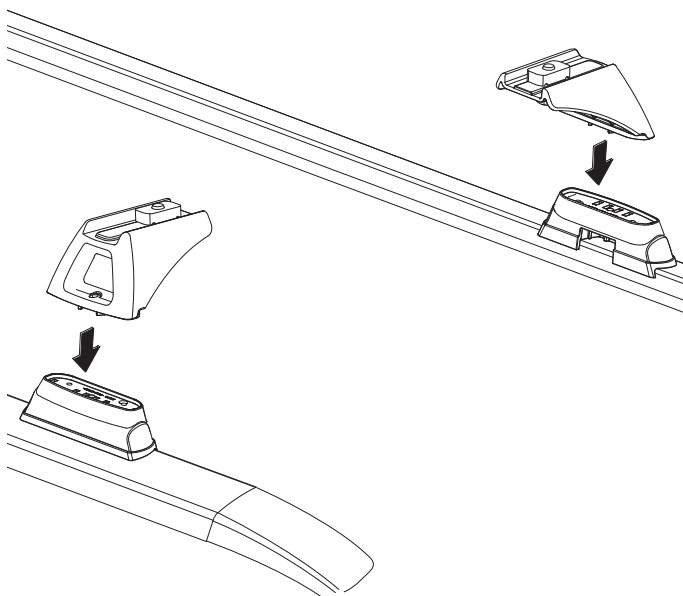

Assemble M6 screw and washers in preparation for next step.

M6 x 40mm Security Torx Screw

Spring washer

Flat washer





RLCP29 ISUZU MU-X (2 - Bar)

4

Place a bracket into the inside of the cut out in the base pad. While holding the leg and pads insert the screw and washer assembly through the leg and into the bracket thread. Make sure the bracket is properly located under the inside lip of the roof rail. **Do not fully tighten at this stage.**

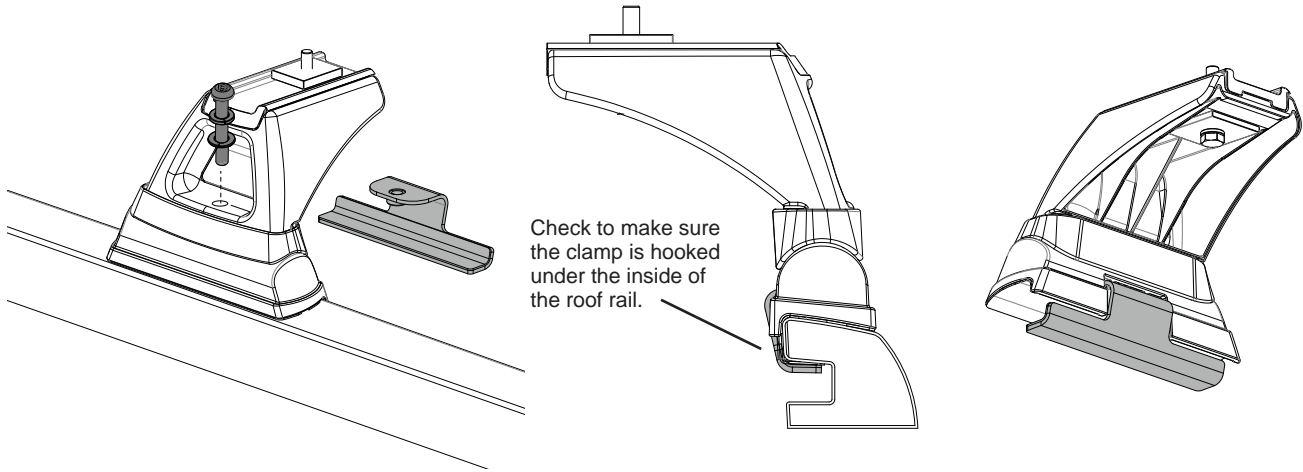

5

Insert crossbar rubber buffer strip into the top of the cross bar. Heavy Duty crossbar shown.

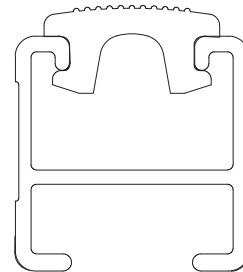
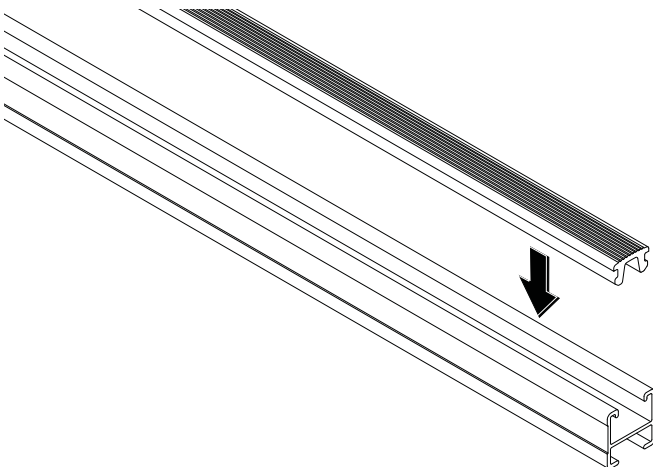

6

Place each crossbar onto the legs. Make sure the channel nut sits across the bar as shown below.

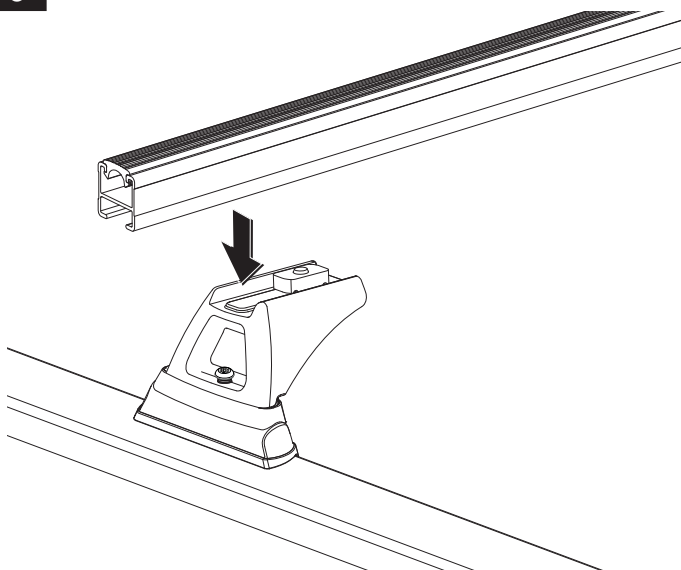

Channel nut must sit across the crossbar when tight.

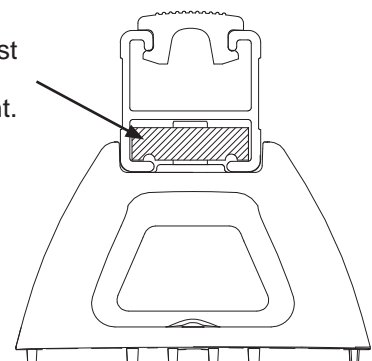



RLCP29 ISUZU MU-X (2 - Bar)

7

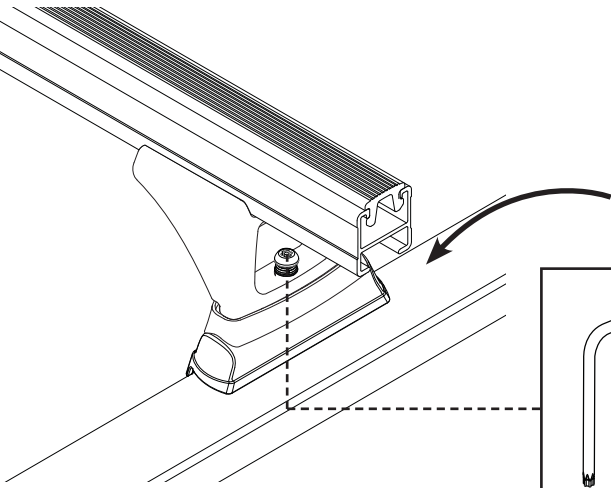

Push the bracket back against the roof rail to make sure it is sitting correctly before tightening the screws. Tighten the four M6 x 40mm Torx Screw screws to **5-6 Nm**.

Check to make sure the clamp is correctly located.

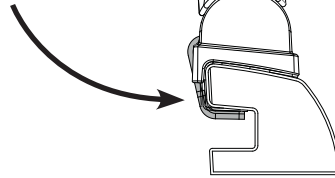
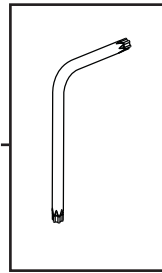

8

Adjust the crossbar by sliding side to side then measure for equal crossbar overhang. Tighten the M10 x 25mm crossbar bolts to **11-12 Nm (8-9 lb/ft)**.

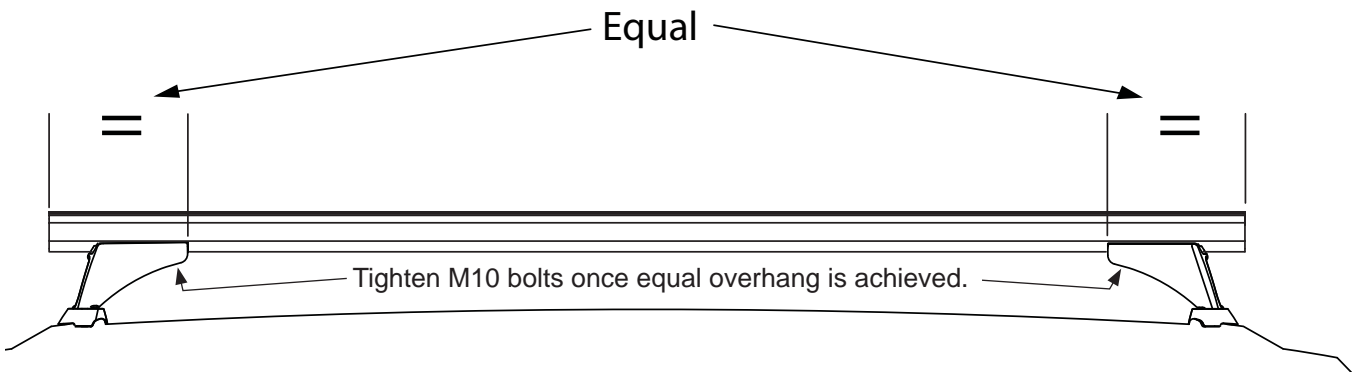

9

Push the end caps into the crossbars.

